

Township N. 1 North, Range N. 12 East of Mer. (Mich. Ter.)

1979

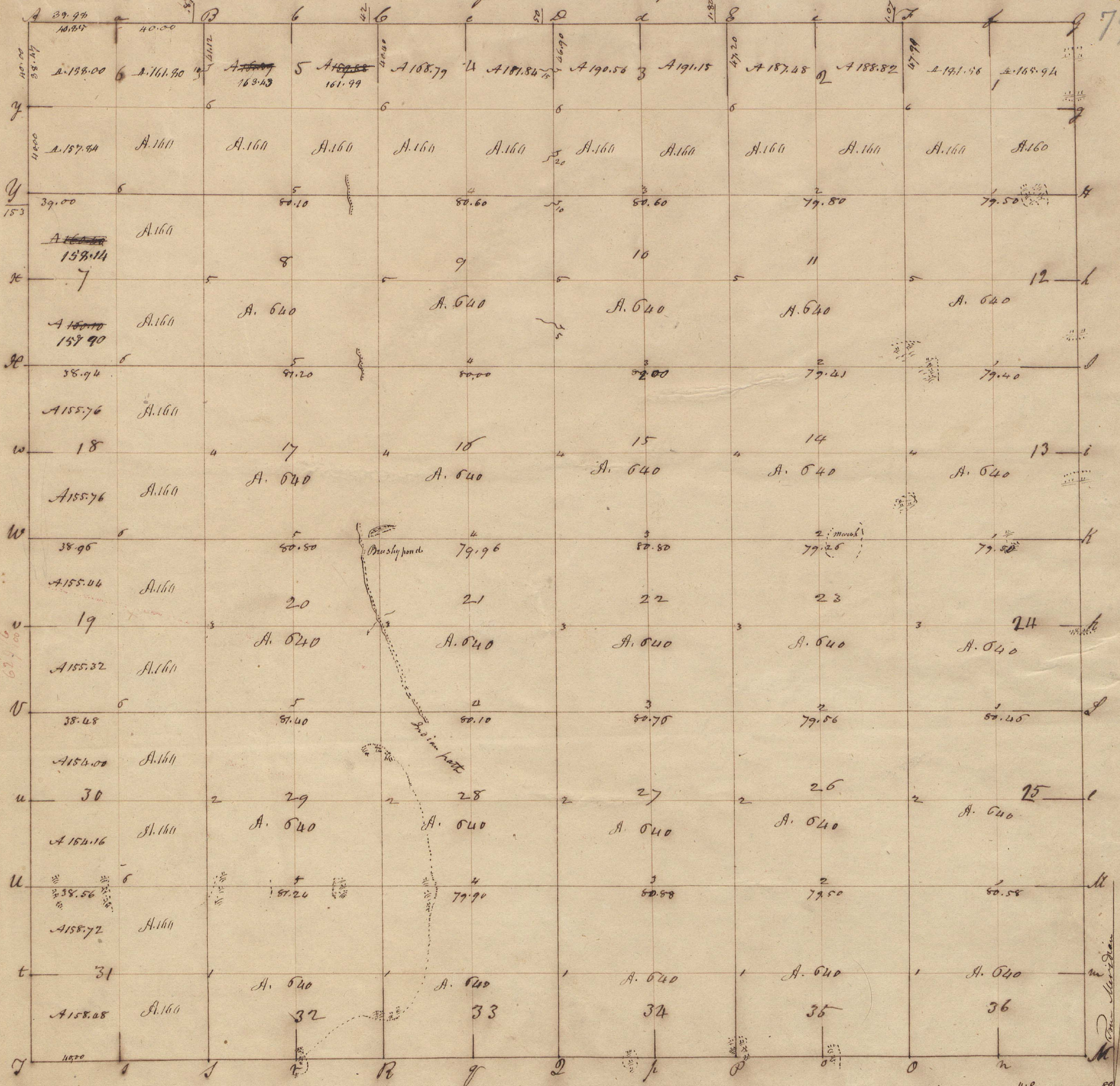

X. S. 19. 60. 100

Variation 2. 40' E

Surveyed by Jas. Wampler - 1877

Surveyor General's Office
 Feb. 20th 1919
 Accs. Decd
 Total quantity 23,182.88

A true copy from the Original on file in this Office

Edw. and Wm. H. H. H.
 Surveyor General

POOR COPY



Township N^o I North, Range N^o XII East of the Mer. (Mich. Ter.) Surveyed by Jos. Wampler 1817

Description of the Soil on the interior Sectional lines.

| Between Sections | Quality &c. | Between Sections | Quality &c. | Between Sections | Quality &c. |
|------------------|--|------------------|--|------------------|--|
| 35 & 36 | Level wet lands rich Soil, Ash, Elm, beech, Spruce & Ang. the same | 33 & 34 | Level wet lands, Ash, beech, Oak, Spruce, Ang. the same | 41 & 42 | Land a little rolling, Oak, beech, Ash, Elm, Spruce, Ang. the same |
| 25 & 26 | Same | 27 & 28 | Level rich lands, Oak, Ash, beech, Spruce, Elm, Ang. the same | 31 & 32 | Bushy prairie lands |
| 25 & 26 | Level wet lands rich Soil, beech, Ash, Elm, Spruce, Cottonwood Ang. the same | 29 & 30 | Good level wet lands | 29 & 30 | Same |
| 24 & 25 | Same | 21 & 22 | Good level wet rich land | 30 & 31 | Same |
| 23 & 24 | Rich Soil, Spruce, Ash, Elm, Beech &c. | 15 & 22 | Good level lands - Oak, Ash, beech, Elm, Spruce, Ang. the same | 29 & 30 | Wet bushy lands - part prairie |
| 13 & 24 | East & Swamp, rest fine level beech lands | 15 & 16 | Good level land - Oak, Ash, beech, Ang. the same | 20 & 29 | Wet poor bushy land |
| 13 & 14 | South half level wet bushy lands - rest prairie | 10 & 15 | Fine lands - Oak, Ash, Elm, Spruce, beech, Ang. the same | 19 & 30 | Bushy Oak land |
| 12 & 13 | East & good lands - Beech, Ash, Elm, Spruce, Oak, bushy | 9 & 10 | Good level land - Oak, Ash, beech, Ang. the same | 19 & 20 | Bushy prairie |
| 11 & 12 | Good lands - Beech, Ash, Elm, Oak, Spruce &c. | 3 & 10 | Fine level land - Oak, Ash, beech, Spruce, Elm, Ang. the same | 17 & 20 | Same |
| 1 & 3 | Good level land - Oak, Ash, Beech &c. - Ang. the same | 3 & 4 | Level bushy lands - Oak, beech, Elm, Ang. the same | 18 & 19 | Prairie |
| 34 & 35 | South & bushy marsh, N. & good lands, Oak, Ash, Elm, Spruce &c. | 32 & 33 | Bushy prairie very wet | 17 & 18 | Good land - scrubby timber - very bushy |
| 26 & 35 | Good rolling lands - Oak, Ash, Beech, Spruce, Ang. the same | 28 & 33 | East half good rich land - rest prairie | 8 & 17 | Scarcely any timber - very bushy |
| 26 & 27 | South half rich level lands - North & bushy & swampy | 28 & 29 | Bushy prairie | 7 & 18 | Rich lands very bushy & thickly |
| 23 & 26 | Rich level wet lands - Oak, Ash, Elm, beech, Spruce, Ang. the same | 21 & 25 | Good lands - Ash, Elm, Spruce, Cottonwood, Ang. the same | 7 & 8 | Rich lands - Oak, Ash, Elm, beech, Spruce, Ang. the same |
| 22 & 23 | Rolling, Beech land | 20 & 21 | Rolling, W. Oak lands - good quality, very bushy | 5 & 8 | Good lands - very bushy & thickly |
| 11 & 23 | Rolling lands - Oak, Beech, Ash, Elm, Spruce, Ang. the same | 16 & 21 | Middle land - Oak, Ash, Elm, beech, Spruce, Ang. the same | 6 & 7 | Good thin lands - very bushy & thickly |
| 14 & 15 | Level rich lands - Oak, Ash, Elm, Ang. the same | 16 & 17 | Rolling, beech land - Oak, Elm, beech, Ang. the same | 5 & 6 | Rich lands - Oak, Ash, Elm, Ang. the same |
| 11 & 14 | Fine rich lands - Oak, Ash, Elm, beech, Ang. the same | 9 & 16 | East half good lands - Oak, Elm, Spruce, Ang. the same | | |
| | Rolling good lands - Oak, Beech, Ash, Elm &c. | 8 & 9 | Good bushy Oak land - Ang. the same | | |

Township 1 North, Range 12 East of Mer. Mich. Ter. Interior Section Corners Described Interior Quarter Section Corners (Continued)

| Posts Bearing trees | Inches diam. | Courses they bear | Links dist. | Quality of the Soil | Interior Section Corners | | | Interior Quarter Section Corners (Continued) | | | | | | | |
|---------------------|--------------|-------------------|-------------|---------------------|--------------------------|---------------|---------------|--|-------------------|-------------|---------------|-----------------------------|-------------------|-------------|-----------|
| | | | | | From & to | Bearing trees | Inches diam. | Courses they bear | Links dist. | From & to | Bearing trees | Inches diam. | Courses they bear | Links dist. | |
| A Ash | 5 | S 74 N 17 | | | 25, 26, 35, 36 | From & to | Bearing trees | Inches diam. | Courses they bear | Links dist. | I to X at 1 | Ash | 7 | N 20 E 8 | |
| B Beech | 16 | S 19 E 20 | | | 23, 24, 25, 26 | | | | | | 2 | Beech | 10 | N 75 N 16 | |
| B do | 6 | N 2 N 23 | | | 13, 14, 23, 24 | | | | | | 3 | Ash | 15 | N 6 N 9 | |
| b do | 18 | N 55 E 15 | | | | | | | | | 4 | do | 22 | S 35 E 18 | |
| C Beech | 16 | S 46 E 10 | | | 11, 12, 13, 14 | | | | | | 5 | do | 22 | S 78 E 18 | |
| c do | 14 | S 63 N 41 | | | 1, 2, 11, 12 | | | | | | 5 | do | 30 | S 39 E 130 | |
| D Beech | 6 | S 57 1/2 N 28 | | | 26, 27, 28, 29 | | | | | | 6 | no other bearing trees near | 38 | N 2 E 30 | |
| d do | 6 | N 24 E 20 | | | 22, 23, 26, 27 | | | | | | H to Y | 1 | B. Oak | 8 | S 38 E 18 |
| E Maple | 10 | S 87 N 29 | | | 14, 15, 22, 23 | | | | | | 2 | N. Oak | 6 | N 75 N 10 | |
| e do | 30 | S 33 E 24 | | | 10, 11, 14, 15 | | | | | | 2 | do | 6 | S 53 E 19 | |
| F Ash | 22 | S 73 E 6 | | | 2, 3, 10, 11 | | | | | | 3 | A. Oak | 8 | N 32 N 18 | |
| f B. Oak | 11 | S 34 N 19 | | | 27, 28, 33, 34 | | | | | | 4 | Beech | 7 | N 47 E 4 | |
| G Spruce | 12 | S 11 N 19 | | | 21, 22, 27, 28 | | | | | | 5 | do | 8 | S 47 N 30 | |
| g W. Oak | 36 | N 31 N 41 | | | | | | | | | 5 | do | 10 | S 25 N 21 | |
| h Beech | 7 | S 80 N 33 | | | | | | | | | 6 | no other tree near | 12 | S 67 E 6 | |
| h B. Oak | 4 | N 72 E 8 | | | 15, 16, 21, 22 | | | | | | 6 | do | 12 | N 54 N 12 | |
| I Elm | 24 | S 38 N 11 | | | 10, 15, 16 | | | | | | 7 | Ash | 12 | S 19 N 6 | |
| i B. Oak | 8 | N 50 E 7 | | | 2, 4, 9, 10 | | | | | | 7 | do | 7 | N 14 N 14 | |
| i Elm | 18 | North 5 | | | 28, 29, 32, 33 | | | | | | 8 | Ash | 17 | S 17 E 23 | |
| K Jamaciae | 5 | S 42 N 25 | | | 20, 21, 28, 29 | | | | | | 3 | Ash | 17 | S 84 E 15 | |
| K W. Oak | 12 | N 50 N 11 | | | 16, 17, 20, 21 | | | | | | 4 | B. Oak | 11 | S 83 N 3 | |
| L Beech | 18 | S 83 N 26 | | | 8, 9, 16, 17 | | | | | | 5 | Bushes | 5 | N 55 N 50 | |
| L Maple | 14 | N 15 N 33 | | | 4, 5, 8, 9 | | | | | | 5 | Ash | 36 | N 58 N 11 | |
| L Beech | 14 | N 84 E 17 | | | 29, 30, 31, 32 | | | | | | 6 | Nickory | 20 | N 73 E 9 | |
| M Ash | 10 | S 97 E 10 | | | 16, 17, 20, 21 | | | | | | 1 | Ash | 21 | N 55 N 29 | |
| m Spruce | 10 | N 55 N 20 | | | 8, 9, 16, 17 | | | | | | 2 | W. Oak | 36 | N 78 N 17 | |
| n Spruce | 13 | South | | | 4, 5, 8, 9 | | | | | | 2 | do | 22 | N 79 E 25 | |
| N Spruce | 12 | N 19 N 8 | | | 29, 30, 31, 32 | | | | | | 3 | Sugar | 18 | N 34 E 17 | |
| n W. Oak | 10 | N 50 E 21 | | | 19, 20, 29, 30 | | | | | | 4 | W. Oak | 26 | N 71 E 13 | |
| o Spruce | 30 | corner tree | | | 17, 18, 19, 20 | | | | | | 4 | do | 8 | N 59 N 13 | |
| O B. Oak | 6 | N 41 N 32 | | | 7, 8, 17, 18 | | | | | | 5 | do | 16 | S 59 E 23 | |
| O Elm | 30 | N 54 E 24 | | | 5, 6, 7, 8 | | | | | | 5 | do | 16 | S 55 N 19 | |
| O Poplar | 10 | N 66 N 57 | | | | | | | | | 6 | do | 22 | N 32 E 6 | |
| P Maple | 9 | S 15 E 50 | | | | | | | | | 6 | do | 15 | N 40 E 13 | |
| P Maple | 42 | N 77 W 35 | | | | | | | | | 6 | do | 16 | N 39 E 11 | |
| P W. Oak | 20 | N 46 E 29 | | | | | | | | | 7 | do | 27 | N 38 E 21 | |
| P Elm | 10 | N 22 E 50 | | | | | | | | | 7 | do | 32 | S 66 N 14 | |
| Q Beech | 6 | S 54 E 24 | | | | | | | | | 8 | do | 8 | N 84 N 6 | |
| Q Maple | 12 | N 68 N 17 | | | | | | | | | 8 | Swampy Oak | 12 | N 84 N 6 | |
| q Sugar | 6 | N 45 N 34 | | | | | | | | | 3 | Beech | 25 | S 77 E 23 | |
| R Beech | 10 | N 29 E 36 | | | | | | | | | 4 | Ash | 24 | N 77 N 15 | |
| R Maple | 12 | N 66 N 15 | | | | | | | | | 4 | do | 11 | S 67 N 17 | |
| r Beech | 10 | N 82 E 23 | | | | | | | | | 5 | do | 11 | S 34 E 20 | |
| r Cypress | 9 | S 50 N 83 | | | | | | | | | 5 | Beech | 16 | S 32 N 8 | |
| s Cypress | 9 | S 4 E 75 | | | | | | | | | 6 | do | 24 | S 68 N 10 | |
| S Cypress | 9 | S 19 E 30 | | | | | | | | | 6 | do | 12 | S 68 E 17 | |
| S Beech | 10 | N 32 E 59 | | | | | | | | | 6 | do | 6 | S 56 N 20 | |
| s Beech | 9 | S 89 N 52 | | | | | | | | | 7 | do | 7 | N 70 E 17 | |
| T Poplar | 7 | N 43 E 84 | | | | | | | | | 7 | do | 13 | N 24 N 18 | |
| T Cypress | 10 | N 44 N 57 | | | | | | | | | 8 | do | 5 | N 88 N 16 | |
| U Spruce | 12 | N 38 N 57 | | | | | | | | | 8 | Ash | 10 | N 77 N 4 | |
| U B. Oak | 8 | S 6 E 7 | | | | | | | | | 4 | W. Oak | 5 | S 78 E 4 | |
| v Maple | 15 | N 6 N 6 | | | | | | | | | 4 | W. Oak | 24 | N 68 E 9 | |
| V Maple | 17 | S 81 E 17 | | | | | | | | | 5 | do | 25 | N 82 N 30 | |
| v W. Oak | 12 | N 37 E 10 | | | | | | | | | 5 | Ash | 8 | N 70 E 7 | |
| W B. Oak | 38 | N 47 1/2 N 53 1/2 | | | | | | | | | 6 | do | 6 | S 45 N 10 | |
| w W. Oak | 24 | N 76 E 22 | | | | | | | | | 6 | do | 5 | S 26 N 14 | |
| X B. Oak | 8 | S 87 N 14 | | | | | | | | | 6 | do | 5 | S 74 N 14 | |
| X do | 8 | N 87 N 37 | | | | | | | | | 6 | do | 4 | N 71 E 11 | |
| X do | 4 | S 26 N 17 | | | | | | | | | 6 | do | 12 | S 7 E 14 | |
| Y Ash | 6 | N 36 N 13 | | | | | | | | | | | | | |
| Y do | 6 | S 34 E 5 | | | | | | | | | | | | | |

| Interior Quarter Section Corners described | | | |
|--|---------------|--------------------|-------------------|
| From & to | Bearing trees | Inches diam. | Courses they bear |
| M to U at 1 | Beech | 13 | S 63 N 10 |
| 2 | do | 20 | N 56 E 32 |
| 3 | do | 23 | N 55 N 25 |
| 4 | do | 10 | S 55 E 17 |
| 5 | do | 12 | S 13 E 10 |
| 6 | do | 10 | N 14 N 20 |
| 7 | do | 12 | S 45 N 26 |
| 8 | do | 25 | N 8 N 9 |
| 9 | do | 10 | N 27 E 44 |
| 10 | do | 5 | N 13 N 36 |
| 11 | do | 12 | N 31 E 6 |
| 12 | do | 7 | S 14 E 5 |
| 13 | do | 8 | N 23 N 9 |
| 14 | do | 4 | S 23 E 2 |
| 15 | do | 6 | N 13 N 13 |
| 16 | do | 8 | S 82 E 33 |
| 17 | do | 6 | S 42 N 7 |
| 18 | do | 7 | N 5 N 8 |
| 19 | do | 7 | N 10 N 31 |
| 20 | do | 9 | S 28 E 22 |
| 21 | do | 4 | S 11 E 16 |
| 22 | do | 7 | N 33 N 6 |
| 23 | do | 11 | S 85 E 29 |
| 24 | do | 7 | S 62 E 11 |
| 25 | do | 8 | N 56 N 22 |
| 26 | do | 12 | S 24 N 5 |
| 27 | do | 11 | N 26 E 12 |
| 28 | do | 20 | S 55 N 5 |
| 29 | do | 7 | N 40 E 5 |
| 30 | do | 17 | S 21 N 20 |
| 31 | do | 4 | N 21 E 12 |
| 32 | do | 6 | N 43 N 8 |
| 33 | do | 4 | S 18 N 104 |
| 34 | do | 3 | S 11 E 140 |
| 35 | do | no other tree near | |