

Township N. 5 North, Range N. 12 East of the Mer. (Mich. Ter.)

Acres. Dec'd
Total quantity 23,346.99

A true Copy from the Original on file in this Office
Surveyor General's Office
Feb 20th 1919

Edward Tiffin
Surveyor General

POOR COPY

3

From Section
Mar. 4 1896

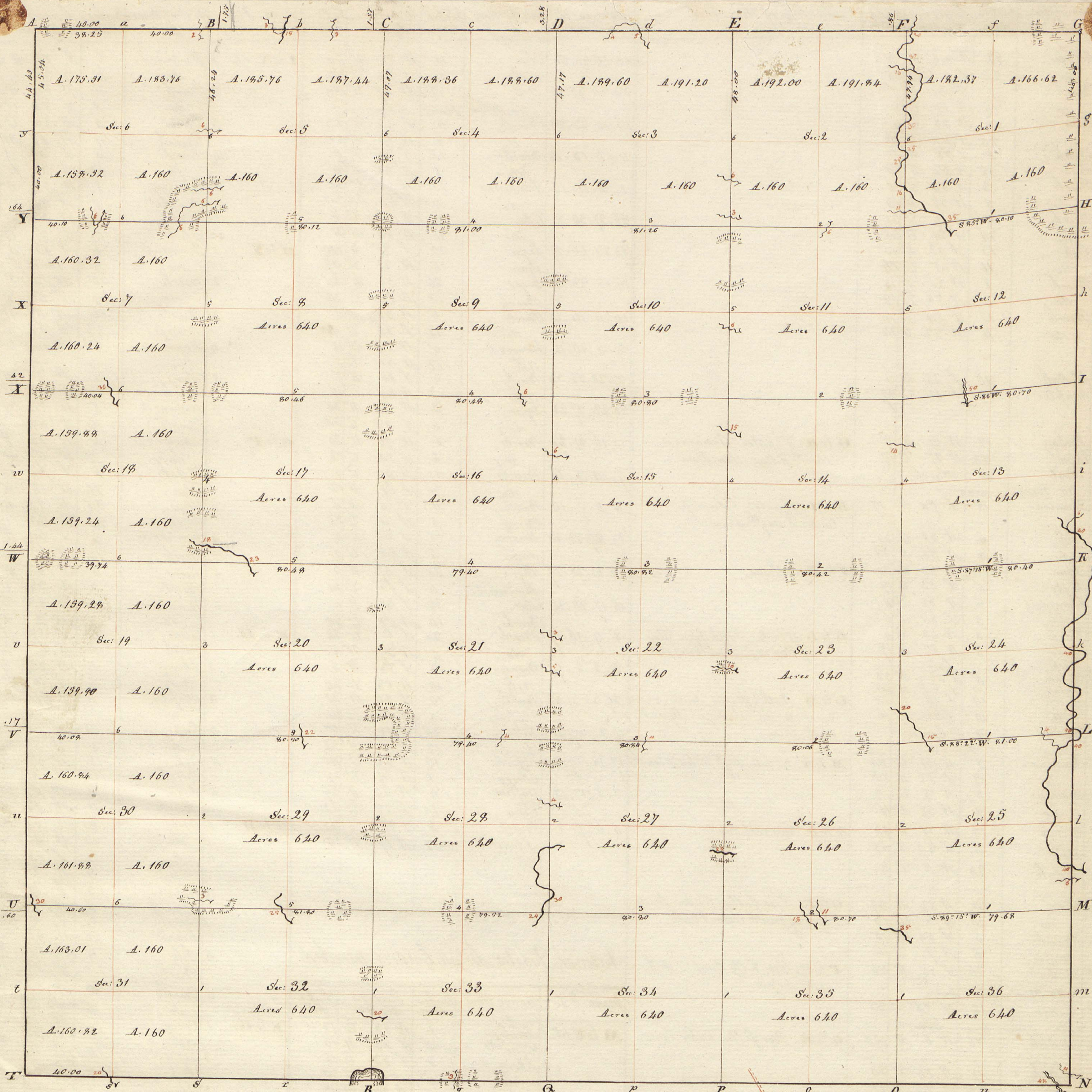

Township N^o V North, Range N^o XII East of the Meridian. (Mich: Ter.) Surveyed by Jos: Wampler 1818

Description of the Soil on the interior Sectional lines.

Between Sections	Quality &c.	Between Sections	Quality &c.	Between Sections	Quality &c.
35.36	Fine rich level land - Oak, Ash, Beech, Lym. Elm, - Maple, & Ash	2.3	Level fallow & burnt timber land	4.9	Poor hilly thickly Oak land very bushy
25.36	Same	33.34	Poor hilly Oak land	4.5	Tolerable W. Oak land
25.26	Rich level land - timber fallow - very bushy	27.34	Same	29.32	Poor hilly Oak land
24.25	Same	27.28	Same	30.31	Same
23.24	Same	22.27	Same	29.30	Same
12.24	Same	21.22	Same with burnt timber	20.29	Same
12.14	Same	15.22	Same	19.20	Same (stony & burnt timber)
12.13	Same (wet & swampy)	15.16	Same	17.20	Same
11.12	Same	10.15	Same	18.19	Same
1.12	Level swampy bushy land	9.10	Same	17.18	Same
1.2	Very swampy & thickly	3.10	Same	16.17	Same
34.35	Good land - Oak, Ash &c.	3.4	Same	5.8	Same
26.35	Partly a very bad swamp - rest good bottom Sugar, beech, Lym. Elm -	32.33	Same	6.7	Poor hilly & stony Oak & Pine land
26.27	Middling - Oak & Ash	28.33	Same	5.6	Hilly Oak land
23.26	Very bushy timber scarce	28.29	Same		
22.23	Poor burnt timber land	21.28	Same		
14.23	Level burnt timber land	20.21	Same		
14.15	Same	16.21	Same		
11.14	Low wet & swampy land - much fallen timber & very bushy	16.17	Same		
10.11	Same	9.16	Same		
9.11	Same	8.9	Very hilly poor bushy & swampy burnt timber land		

POOR COPY

124

True Meridian Variation 4° 38' E.

89

Township 5 North, Range N^o. 13 East of Mer. (Micro. Ter.) Interior Section Corners described Interior Quarter Section Corners continued

Posts	Bearing trees	Inches diam.	Courses they bear	Links dist.	Quality of the Soil	Corners of Sections	Bearing trees	Inches diam.	Courses they bear	Links dist.	From I to	Bearing trees	Inches diam.	Courses they bear	Links dist.	
A	Maple	18	N 56 W	41	C to H. 2 nd rate lands - Janarac, Ung ^l & Alder, Willow	25, 26, 35, 36	Beech	8	N 59 W	30	I to X at 1	Sycow	11	S 43 W	13	
a	Beech	6	S 59 E	80		23, 24, 25, 26	do	6	S 48 E	10	2	Elm	6	S 69 E	23	
B	Sycow	6	S 20 E	6	H to I. Same	13, 14, 23, 24	Aspin	12	N 17 E	3	O to F	3	Sycow	14	N 68 W	8
b	Beech	8	S 34 W	62		11, 12, 13, 14	do	2	S 25 W	32		4	do	16	N 21 E	36
C	Ash	9	S 74 W	32	I to K. 2 nd rate lands - Timber fallen - Ung ^l & Ash & Spruce	1, 2, 11, 12	do	7	N 20 E	18	P to E	4	Aspin	10	N 41 E	35
c	do	10	S 36 E	27		26, 27, 34, 35	do	6	S 7 E	28		5	Sassafras	2 1/2	N 37 W	22
D	Elm	8	N 54 E	27	L to M. Very good 2 nd rate. Beech, Sycow, Ash, Sugar & Large timber fallen	22, 23, 26, 27	Ironwood	4	N 61 W	11	R to D	6	W. Oak	8	N 27 W	168
d	do	12	S 67 E	51		14, 15, 22, 23	do	5	S 59 E	13		12	do	18	N 24 E	216
E	W. Oak	36	S 55 W	50	M to N. Land 2 nd rate & very good - Good & Key - timber W. Oak, Beech, Sugar, Sycow	10, 11, 14, 15	W. Oak	12	N 37 W	6	S to B	1	do	12	N 40 E	79
e	no other trees near					2, 3, 10, 11	Water Beech	6	corner			3	do	5	S 61 W	40
F	Alder	4	S 40 E	7	N to O. Low wet land - Timber (Ash, Maple, Beech)	27, 28, 33, 34	do	8	N 35 W	7	T to V	3	Elm	4	N 79 W	19
f	Elm	12	N 7 W	9		21, 22, 27, 28	do	22	N 30 W	12		4	Cherry	4	S 48 E	13
G	B. ash	10	N 17 E	83	O to R. Poor lands, badly timbered	15, 16, 21, 22	W. Oak	14	S 28 E	36	U to W	4	W. Oak	11	S 45 W	18
g	Ash	6	S 50 W	65		9, 10, 15, 16	do	8	S 30 W	27		5	do	30	in pond	
H	Janarac	6	S 81 W	50	P to Q. Poor hills but at timber land Oak, Aspin & hazel bushes	3, 4, 9, 10	W. Oak	28	S 65 E	47	V to X	6	Aspin	4	S 59 E	8
h	do	6	N 61 W	50		28, 29, 32, 33	do	17	S 11 E	19		1	Beech	8	N 42 W	16
I	Elm	8	S 36 E	108	Q to R. Poor lands - Oak, Cedar & Spruce	20, 21, 28, 29	W. Oak	14	N 42 E	22	X to Y	2	W. Oak	18	S 14 E	8
i	do	8	N 36 E	108		16, 17, 20, 21	do	3	N 36 W	5		3	B. Oak	7	S 20 E	4
J	B. ash	4	corner		R to S. Poor sandy Oak land	4, 5, 8, 9	W. Oak	17	S 27 W	41	Y to Z	4	Aspin	5	N 59 E	17
j	Beech	13	S 20 E	43		29, 30, 31, 32	corner	18	S 2 1/2 W	46		4	W. Oak	10	N 3 E	76
K	Ironwood	5	S 81 E	29	S to T. Poor lands, badly timbered	19, 20, 29, 30	W. Oak	11	N 52 W	60	Z to A	5	do	7	S 45 E	11
k	do	4	corner			17, 18, 19, 20	do	18	S 74 E	23		6	B. Oak	3	N 30 E	19
L	Butternut	5	N 6 W	50	T to U. Poor hills but at timber land Oak, Aspin & hazel bushes	7, 8, 17, 18	W. Oak	24	N 14 1/2 E	213	A to B	7	Maple	7	S 20 W	11
l	Shan	4	S 74 W	72		5, 6, 7, 8	do	24	N 12 W	3.04		1	do	10	N 19 W	27
M	Sugar	12	S 26 W	13	U to V. Poor lands, badly timbered	8, 9, 16, 17	W. Oak	8	S 8 E	46	B to C	2	do	8	S 46 E	15
m	Beech	12	S 20 W	23		8, 9, 16, 17	do	11	N 18 W	11		3	Ash	5	N 20 W	39
N	W. Oak	5	S 59 W	16	V to W. Poor lands, badly timbered	1, 2, 11, 12	W. Oak	8	S 15 W	25	C to D	3	Janarac	12	N 55 E	7
n	do	5	S 59 W	16		1, 2, 11, 12	do	11	S 15 W	25		4	W. Oak	8	N 43 W	6
O	Beech	18	S 4 E	54	W to X. Poor hills but at timber land Oak, Aspin & hazel bushes	1, 2, 11, 12	W. Oak	10	S 15 W	25	D to E	4	W. Oak	10	N 3 E	76
o	do	18	S 4 E	54		1, 2, 11, 12	do	10	S 15 W	25		5	do	7	S 45 E	11
P	W. Oak	18	N 73 W	102	X to Y. Poor lands, badly timbered	1, 2, 11, 12	W. Oak	10	S 15 W	25	E to F	5	do	7	S 45 E	11
p	do	8	S 13 W	126		1, 2, 11, 12	do	10	S 15 W	25		6	do	4	S 71 E	1
Q	W. Oak	18	N 34 E	91	Y to Z. Poor lands, badly timbered	1, 2, 11, 12	W. Oak	10	S 15 W	25	F to G	6	Birch	4	S 71 E	1
q	do	18	N 34 E	91		1, 2, 11, 12	do	10	S 15 W	25		7	Maple	7	S 20 W	11
R	W. Oak	12	N 7 W	60	Z to A. Poor hills but at timber land Oak, Aspin & hazel bushes	1, 2, 11, 12	W. Oak	10	S 15 W	25	G to H	1	do	10	N 19 W	27
r	do	12	N 7 W	60		1, 2, 11, 12	do	10	S 15 W	25		2	do	8	S 46 E	15
S	Pine	36	S 28 E	98	A to B. Poor lands, badly timbered	1, 2, 11, 12	W. Oak	10	S 15 W	25	H to I	3	Ash	5	N 20 W	39
s	W. Oak	12	S 33 W	97		1, 2, 11, 12	do	10	S 15 W	25		4	Janarac	12	N 55 E	7
T	W. Oak	12	S 70 E	23	B to C. Poor lands, badly timbered	1, 2, 11, 12	W. Oak	10	S 15 W	25	I to J	3	do	18	N 43 W	6
t	do	12	S 70 E	23		1, 2, 11, 12	do	10	S 15 W	25		4	W. Oak	8	N 59 E	17
U	Aspin	4	S 29 E	14	C to D. Poor lands, badly timbered	1, 2, 11, 12	W. Oak	10	S 15 W	25	J to K	4	W. Oak	10	N 3 E	76
u	do	4	S 30 E	14		1, 2, 11, 12	do	10	S 15 W	25		5	do	16	N 58 E	6
V	W. Oak	16	S 1 1/2 E	282	D to E. Poor lands, badly timbered	1, 2, 11, 12	W. Oak	10	S 15 W	25	K to L	5	Janarac	16	N 58 E	6
v	do	16	S 66 1/2 E			1, 2, 11, 12	do	10	S 15 W	25		6	do	14	S 60 W	14
W	W. Oak	8	N 66 E	11	E to F. Poor lands, badly timbered	1, 2, 11, 12	W. Oak	10	S 15 W	25	L to M	6	W. Oak	37	N 62 W	37
w	do	8	N 59 W	10		1, 2, 11, 12	do	10	S 15 W	25		7	do	28	S 50 E	23
X	Elm	8	S 51 1/2 E	33	F to G. Poor lands, badly timbered	1, 2, 11, 12	W. Oak	10	S 15 W	25	M to N	1	do	20	S 77 E	27
x	W. Oak	14	N 7 1/2 E	122		1, 2, 11, 12	do	10	S 15 W	25		2	W. Oak	10	S 85 W	63
Y	W. Oak	18	N 7 E	48	G to H. Poor lands, badly timbered	1, 2, 11, 12	W. Oak	10	S 15 W	25	N to O	2	do	28	S 89 1/2 W	88
y	Pine	40	S 15 E	27		1, 2, 11, 12	do	10	S 15 W	25		3	do	20	N 47 E	78
Z	W. Oak	18	N 7 E	48	H to I. Poor lands, badly timbered	1, 2, 11, 12	W. Oak	10	S 15 W	25	O to P	3	W. Oak	8	N 40 E	7
z	do	18	N 7 E	48		1, 2, 11, 12	do	10	S 15 W	25		4	do	12	N 26 E	75
A	W. Oak	18	N 7 E	48	I to J. Poor lands, badly timbered	1, 2, 11, 12	W. Oak	10	S 15 W	25	P to Q	4	do	8	N 79 E	10
a	do	18	N 7 E	48		1, 2, 11, 12	do	10	S 15 W	25		5	do	14	N 16 W	10
B	W. Oak	18	N 7 E	48	J to K. Poor lands, badly timbered	1, 2, 11, 12	W. Oak	10	S 15 W	25	Q to R	5	do	8	N 66 W	5
b	do	18	N 7 E	48		1, 2, 11, 12	do	10	S 15 W	25		6	do	12	S 56 E	42
C	W. Oak	18	N 7 E	48	K to L. Poor lands, badly timbered	1, 2, 11, 12	W. Oak	10	S 15 W	25	R to S	6	Maple	14	S 54 E	23
c	do	18	N 7 E	48		1, 2, 11, 12	do	10	S 15 W	25		7	Ironwood	10	N 37 W	32