

LAND CORNER RECORDATION CERTIFICATE
Filing Requirement of Act 74, Mich. P.A. 1970

For corners in

MACOMB
 (County)

CHESTERFIELD TOWNSHIP
 Located In: Corner Code #

189005
 LIBER 9884 PAGE 971
 11/17/2000 12:40:42 P.M.
 MACOMB COUNTY, MI
 CARMELLA SABAUGH, REG/DEEDS

- | | | |
|------------------------------------|----------------------------|------------|
| 1. Public Land Survey | T <u>3</u> N R <u>14</u> E | <u>J-1</u> |
| | T ___ R ___ | _____ |
| | T ___ R ___ | _____ |
| | T ___ R ___ | _____ |
| 2. Property Controlling in Section | S ___ T ___ R ___ | _____ |
| | S ___ T ___ R ___ | _____ |
| 3. Miscellaneous Property in Sec. | S ___ T ___ R ___ | _____ |
| | S ___ T ___ R ___ | _____ |
4. Lot No. _____, Recorded Plat _____
 5. Private Claims _____

ACCEPTED BY THE MACOMB COUNTY SURVEY PEER GROUP AS THE OFFICIAL CORNER UNDER MICHIGAN PUBLIC ACT 345 OF 1990 AT A MEETING HELD ON 9/26/00
 WILLIAM E. SODERBERG, P.S., CHAIRMAN

Register of Deeds Stamp & File Number

1	A	B	C	D	E	F	G	H	I	J	K	L	M
2		6		5		4		3		2		1	
3													
4		7		8		9		10		11		12	
5													
6		18		17		16		15		14		13	
7													
8		19		20		21		22		23		24	
9													
10		30		29		28		27		26		25	
11													
12		31		32		33		34		35		36	
13													

I, ROBERT H. BIRKETT, in a field survey on JUNE 2, 2000 do hereby certify that under requirements of P.A. 74, Michigan P.A. of 1970, the corner points mentioned in lines 1 and 2 above were in conformance with regulations and rules therefore as required in the current manual of survey instructions of the United States Department of the Interior, Bureau of Land Management or by a decree of a Court of Law and /or that the corner points mentioned in lines 3, 4 and 5 above were in conformance with the rules of the Michigan Board of Land Surveyors or by a Decree of a Court of Law; established, re-established, monumented, re-monumented, recovered, found as expressed below:

NOTE: Not more than 2 corners, all in the same town and range, may be recorded on this certificate.

A. Description of original monument and accessories and/or subsequent restoration:
 J-1, 1817, G. L. O. PRESTON D.S., SET POST

B. Description of corner evidence found and/or method applied in restoring or reestablishing corner:
 J-1, FOUND 1/2" IRON IN A BURIED MONUMENT BOX 1.0' BELOW ASPHALT 26 MILE ROAD AND 2.0' SOUTH OF CENTERLINE. THE 1/2" IRON FITS FOUND IRON TO THE SOUTH AND LIES ON THE SECTION LINE BETWEEN I-13 AND J-13, TOWN 4 NORTH, RANGE 14 EAST, LENOX TOWNSHIP, MACOMB COUNTY.

NO PREVIOUS WITNESSES RECOVERED.

FIELD MEASUREMENTS

I-1 TO J-1	J-1 TO K-1
1817, G. L. O. - 40 CHAINS - (2640')	1817, G. L. O. - 40 CHAINS - (2640')
2000, REMONUMENTATION - 2719.47'	2000, REMONUMENTATION - 2725.15'

C. Description of monument for corner and accessories established to perpetuate locating the position of the corner:
 J-1, REPLACED 1/2" IRON WITH A 3/4" x 24" RE-BAR CAPPED WITH AN ALUMINUM CAP STAMPED "MACOMB COUNTY MONUMENT, MI ACT 345, J-1, 41094" IN A NEW MONUMENT BOX.

- AZ. 35° 45.70' SET REMON TAG IN THE SOUTHEAST FACE OF A UTILITY POLE WITH TRANSFORMERS.
- AZ. 170° 31.58' SET REMON TAG IN THE WEST FACE OF A 24" PINE.
- AZ. 100° 71.87' SET REMON TAG ON THE TOP OF THE MOST WESTERLY GUARD RAIL POST ON THE SOUTH SIDE OF 26 MILE ROAD.
- AZ. 275° 120.41' SET REMON TAG IN THE SOUTH FACE OF A UTILITY POLE.
- AZ. 270° 418.66' I-13, TOWN 4 NORTH, RANGE 14 EAST, LENOX TOWNSHIP, MACOMB COUNTY.

THE SELECTED LOCATION IS ACCEPTED BY ME AND IS GENERALLY ACCEPTED BY PROFESSIONAL SURVEYORS AS THE BEST AVAILABLE EVIDENCE OF THE POSITION OF THE ORIGINAL CORNER.

Signed by Robert H. Birkett Date 11-01-00

Surveyor's Michigan License No. 41094



ax ✓



LENOX
TOWNSHIP
SHIRAZIAE

J-13



26 MILE ROAD

2306.49'

WESTFIELD
TOWNSHIP
SHIRAZIAE

I-13



418.66'



J-1



CORNER



SOUTH



EAST



WEST

203-020 2000 MACOMB REMON
6-16-00

RAB, COB, GGG J-1 CHESTERFIELD

No 1815

19

POINT # HOR # DIST REMARK

AC 2070 → I-13

I-13 00-00-00 364.985 P.K. w/MDOT TAG

2071 177-09-04 967.715 TRAV. IRON

2072 159-38-01 55.11 P.K. 2' OFF

2073 159-43-52 58.85 P.K. 2' OFF

2074 157-20-14 55.62 P.K. 2' OFF

AC 2071 → 2070

2070 00-00-00 967.720 TRAV. IRON

2055 178-24-14 1337.235 TRAV. IRON

AC 2055 → 2071

2071 00-00-00 1337.235 TRAV. IRON

J-13 201-14-802 59.83 1/2" IRON

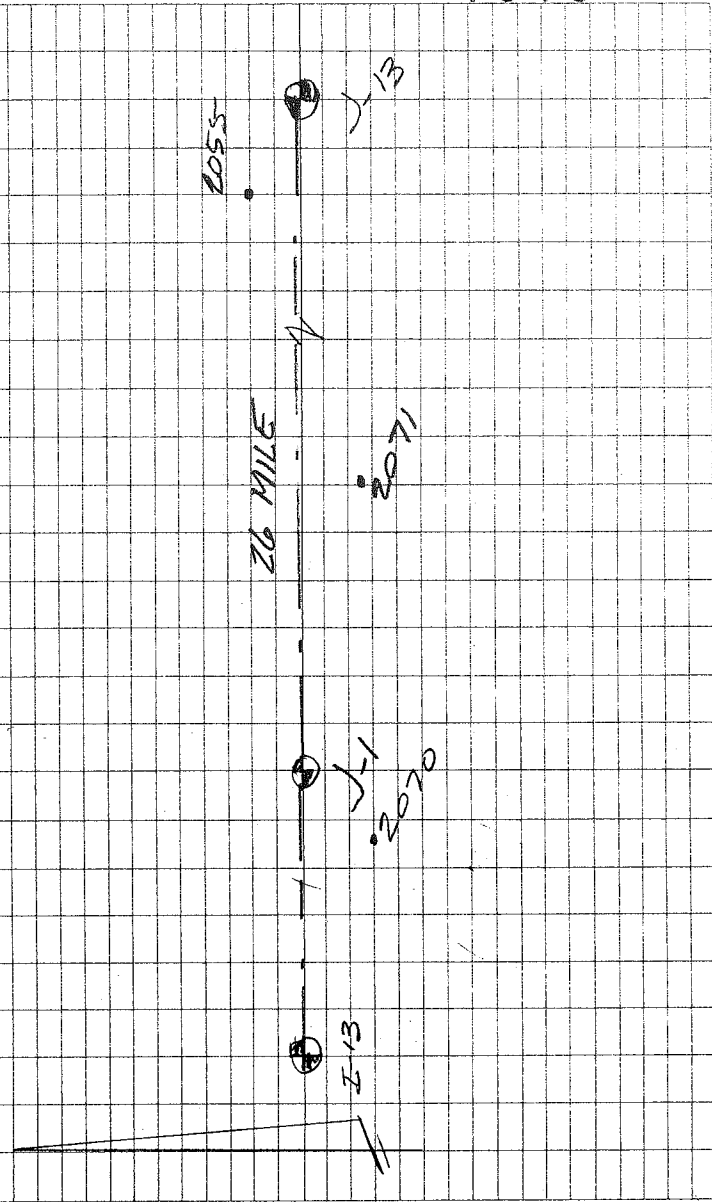



ANDERSON, ECKSTEIN AND WESTRICK, INC.

51301 Schoenherr Road, Shelby Township, Michigan 48315

810 • 726 • 1234

Fax 810 • 726 • 8780 www.aewinc.com

AEW CORNER NUMBER 2000-5

TOWNSHIP CHESTERFIELD

CORNER ID J-1

RESEARCH

AEW RECORDS

N/A

COUNTY RECORDS

N/A

REQUEST FOR INFORMATION

N/A

FIELD LOCATION

Found 1/2" iron in a buried monument box 1.0' below
asphalt 26 mile and 2.0' south of centerline.
monument box fits occupation to the south.

MEASUREMENTS

F-1 to J-1

660 (1817)

Remon (2000) 2719.47

OTHER INFORMATION

J-1 to K-1

660 (1817) 2725.15

Remon (2000)