

LAND CORNER RECORDATION CERTIFICATE
Filing Requirement of Act 74, Mich. P.A. 1970

For corners in

<u>MACOMB</u> (County)	Located In: ERIN	Corner Code #
1. Public Land Survey	T <u>IN</u> R <u>13E</u>	<u>F-9</u>
	T <u> </u> R <u> </u>	<u> </u>
	T <u> </u> R <u> </u>	<u> </u>
	T <u> </u> R <u> </u>	<u> </u>
2. Property Controlling in Section	S <u> </u> T <u> </u> R <u> </u>	<u> </u>
	S <u> </u> T <u> </u> R <u> </u>	<u> </u>
3. Miscellaneous Property in Sec.	S <u> </u> T <u> </u> R <u> </u>	<u> </u>
	S <u> </u> T <u> </u> R <u> </u>	<u> </u>

2258637
LIBER 12396 PAGE 285
 10/31/2002 09:14:34 A.M.
 MACOMB COUNTY, MI SEAL
 CARMELLA SABAUGH, REGISTER OF DEEDS

Register of Deeds Stamp & File Number

4. Lot No. _____, Recorded Plat _____
 5. Private Claims _____

I, STEVEN E. DUNN, in a field survey on March 27, April 16 & 22, 2002, do hereby certify that under requirements of P.A. 74, Michigan P.A. of 1970, the corner points mentioned in lines 1 and 2 above were in conformance with regulations and rules therefore as required in the current manual of survey instructions of the United States Department of the Interior, Bureau of Land Management or by a decree of a Court of Law and that the corner points mentioned in lines 3, 4 and 5 above were in conformance with the rules of the Michigan Board of Land Surveyors or by a Decree of a Court of Law, established, re-established, monumented, re-monumented, recovered, found as expressed below:

NOTE: Not more than 2 corners, all in the same town and range, may be recorded on this certificate.

A. Description of original monument and accessories and/or subsequent restoration:

GLO POST-NO EVIDENCE OF ORIGINAL CORNER FOUND. GLO SURVEY PERFORMED BY WILLIAM PRESTON-1817

- PLATS:**
- | | |
|--------------|---|
| L. 7, P. 52 | "LAKEWOOD GARDENS SUBDIVISION NO. 1" |
| L. 8, P. 33 | "LAKEWOOD GARDENS SUBDIVISION NO. 3" |
| L. 9, P. 28 | "LAWNDALE PARK SUBD'N." |
| L. 10, P. 21 | "LAWNDALE PARK SUBDIVISION NO. 1" |
| L. 14, P. 43 | ASSESSORS PLAT NO. 12 |
| L. 14, P. 49 | ASSESSORS PLAT NO. 17 |
| L. 19, P. 14 | "ASSESSOR'S PLAT NO. 46 OF YUDEL'S HOME & GARDEN SUBDIVISION" |
| L. 25, P. 21 | CATALDO SUB'N. |
| L. 26, P. 7 | STELLA GARDENS SUBDIVISION |
| L. 26, P. 14 | LESTER GARDENS SUBDIVISION |
| L. 26, P. 47 | EVELYN SUBDIVISION |

- MARCH 17, 1924
- SEPTEMBER 19, 1924
- JUNE 8, 1925
- SEPTEMBER 28, 1925
- APRIL 25, 1930
- AUGUST 7, 1930
- MAY 4, 1938
- JANUARY 31, 1950
- MARCH 16, 1951
- JUNE 25, 1951
- MAY 19, 1952

	A	B	C	D	E	F	G	H	I	J	K	L	M
2	6	5	4	3	2	1							
3													
4	7	8	9	10	11	12							
5													
6	18	17	16	15	14	13							
7													
8	19	20	21	22	23	24							
9													
10	30	29	28	27	26	25							
11													
12	31	32	33	34	35	36							
13													

(CONTINUED ON BACK)

L.C.R.C.:
 L. 10507, P. 715 ARVIN N. BUTTERFIELD, #21561 FOUND RAILROAD SPIKE IN MONUMENT BOX JULY 12, 2001

MDOT:
 MACOMB COUNTY RIGHT-OF-WAY MAPS SHEETS 119 & 120 FEBRUARY, 1978

B. Description of corner evidence found and/or method applied in restoring or reestablishing corner:

F-9 1/4 CORNER. CORNER IS COMMON WITH SECTIONS 21 AND 28. FOUND 1" IRON ROD (WITH ROUNDED TOP) IN EXISTING MONUMENT BOX IN CONCRETE PAVEMENT. CENTERLINE 10 MILE ROAD AND ± 30' WEST OF THE I-94 WESTBOUND ENTRANCE RAMP.

I VERIFIED THE LOCATION OF THE FOUND RAILROAD SPIKE BY COMPARING FIELD MEASUREMENTS WITH RECORD MEASUREMENTS AND FOUND MATCHING WITNESS TIES OF L.C.R.C. LISTED ABOVE.

FIELD MEASUREMENTS & RECORD MEASUREMENTS: (SEE BACK)

C. Description of monument for corner and accessories established to perpetuate locating the position of the corner:

F-9 1/4 CORNER

I ACCEPTED THE FOUND 1" IRON ROD AND SET ON TOP AN ALUMINUM CAP STAMPED "MACOMB COUNTY MONUMENT MI. ACT 345 #28408" IN EXISTING MONUMENT BOX.

- WITNESSES:**
- | | | |
|---------|--------|--|
| S.35°W. | 55.14' | Center top nut of Hydrant. |
| N.50°W. | 76.05' | Found "+" cut in center top nut of Hydrant. (76.11' rec.) |
| N.49°E. | 63.26' | Found "+" cut on top of fence anchor post. (63.31' rec.) |
| S.69°E. | 90.04' | Northwest anchor bolt of light pole. |
| S.41°W. | 52.32' | Found nail with MSH tag in southeast face of utility pole. |

THE SELECTED LOCATION IS ACCEPTED BY ME AND IS GENERALLY ACCEPTED BY PROFESSIONAL SURVEYORS AS THE BEST AVAILABLE EVIDENCE OF THE POSITION OF THE ORIGINAL CORNER.



Signed by Steven E. Dunn Date 10-29-02

Surveyor's Michigan License No. 28408

ACCEPTED BY THE MACOMB COUNTY SURVEY PEER GROUP AS THE OFFICIAL CORNER UNDER MICHIGAN PUBLIC ACT 345 OF 1990 AT A MEETING HELD ON 9/24/02
William E. Soderberg
 WILLIAM E. SODERBERG, P.S., CHAIRMAN

BY MICHIGAN STATE BOARD OF LAND SURVEYORS, JAN. 26, 1971
 REVISED MAY 14, 1975
 REVISED JAN., 1983

LAND CORNER RECORDATION CERTIFICATE
Filing Requirement of Act 74, Mich. P.A. 1970

For corners in

MACOMB
 (County)

Located In:
 ERIN

Corner Code #

1. Public Land Survey

T 1N R 13E

F-9

Liber 012396 Page 00286

A. Description of original monument and accessories and/or subsequent restoration:

PLATS: (CONTINUED FROM FRONT)

L. 28, P. 16	MARTHA SUBDIVISION	MAY 8, 1953
L. 28, P. 39	TEN MILE GOLFVIEW HEIGHTS SUB.	AUGUST 19, 1953
L. 28, P. 45	SALEM PARK SUBDIVISION NO. 1	SEPTEMBER 3, 1953
L. 28, P. 48	PALAZZOLO SUBDIVISION	SEPTEMBER 3, 1953
L. 29, P. 21	"HAMILTON SUBDIVISION"	DECEMBER 11, 1953
L. 30, P. 47 & 48	SUN VALLEY	AUGUST 15, 1954
L. 32, P. 27	"MUCCIANTE SUBDIVISION"	MAY 19, 1955
L. 32, P. 44 & 45	STAR VALLEY	JUNE 20, 1955
L. 32, p. 46	"RONNA LYNN SUBDIVISION"	JUNE 22, 1955
L. 34, P. 11	"FAIRWAY GOLF COURSE SUBDIVISION NO. 1"	NOVEMBER 4, 1955
L. 35, P. 41	PRINCETON COURT	MARCH 20, 1956
L. 35, P. 42	"CRESTWOOD COURTS SUBDIVISION"	MARCH 21, 1956
L. 37, P. 10	PINCKET'S SUBDIVISION	AUGUST 1, 1956
L. 38, P. 43	APACHE SUBDIVISION	FEBRUARY 13, 1957
L. 38, P. 50	"PINCKET'S SUBDIVISION NO. 1"	MARCH 5, 1957
L. 47, P. 3	"ASSESSORS PLAT NO. 40"	MAY 20, 1960
L. 50, P. 49	"ASSESSOR'S PLAT NO. 17"	SEPTEMBER 10, 1962

FIELD MEASUREMENTS & RECORD MEASUREMENTS:

F-9 to E-9:
 2643.30'-GLO (40.05 chains).
 2701.01'-Record, Plats North side.
 2701.08'-Record, Plats South side.
 2700.97'-Record, Sketch from F-9.
 2700.84'-Field.

F-9 to G-9:
 2643.30'-GLO (40.05 chains).
 2706.00'-Record, Plats North side.
 2706.65'-Record, Plats South side.
 2705.65'-Record, Sketch from F-9.
 2705.44'-Field.

ANGLE E-9/F-9/G-9:
 180°05'52"-Record, Sketch from F-9.
 180°06'00"-Field.

SURVEY REPORT
F-9
BRIN TOWNSHIP

GENERAL: Traverse points were set and points located then tied in with Trimble GPS. Random points were then measured with a Leica TCA1103 Electronic Theodolite and measurements compared with the GPS coordinates. A scale factor was determined and then applied to the GPS coordinates to match field measurements. Points not able to locate by GPS were side-shot off previously located points.

CORNER: Found railroad spike in existing monument box in concrete pavement. Centerline 10 Mile Road and $\pm 30'$ West of the centerline of the I-94 Westbound entrance ramp.

OBSERVATIONS: From F-9 to E-9 (found a 1" iron rod in an existing monument box), record distances from plats total 2701.01' along the north side of the section line. Record distances from plats total 2701.08' along the south side of the section line. In a letter, with sketches, from Arvin N. Butterfield, P.S. #21561, to Mr. William Soderberg, Macomb County Remonumentation Surveyor, dated August 24, 2001, he names the railroad spike (F-9) and 1" iron rod (E-9) and states a measured distance of 2700.97'. Field measurement is 2700.84', within 0.13' of his measurement.

From F-9 to G-9 (found a Macomb County Remon Cap stamped with #34970 in existing monument box in concrete pavement), record distances from plats total 2706.00' along the north side of the section line. Record distances from plats total 2706.65' along the south side of the section line. In the same letter stated above, Mr. Butterfield mentions the monument with cap #34970 (G-9) and states a measured distance of 2705.65'. Field measurement is 2705.44', within 0.21' of his measurement.

In the same letter stated above, Mr. Butterfield states the northerly angle (E-9/F-9/G-9) measured $180^{\circ}05'52''$. Field measurement is $180^{\circ}06'00''$, within 08".

Two found witness ties, as recorded in L.C.R.C., L. 10507, P. 715, also match somewhat:

Top of fence anchor post N.55°E. 63.31' to chiseled X. (63.26' m.).

Top bolt of fire hydrant N.45°W. 76.11' to chiseled X. (76.05' m.).

Corners found and located along 10 Mile Road tend to verify the 120' right-of-way (60' half-width).

RECOMMENDATION: My recommendation to the Peer Review Board is to accept the found railroad spike as the proper location of the corner.

Respectfully submitted,



Steven E. Dunn, PS #28408

August 11, 2002

KELLY

(712) E-9

2700.84' N.
(2700.91' E.) NOTES

22+27.30 40.19
(721) Fo. 1/2" PIPE w/CAP
(722) Fo. 1/2" PIPE w/CAP
21+67.85 40.25

(2701.01' E.) PLATS
(2701.08' E.) PLAT

(723) Fo. 1/2" PIPE
14+91.08 50.50
(724) Fo. 1/2" PIPE
6+48.50 48.56

11+18.43 59.85
Fo. 1/2" PIPE (727)
Fo. 1/2" PIPE (823)
10+56.30 59.93
6+13.86 59.88
Fo. 1/2" PIPE w/CAP (726)
Fo. PK 6TAG (729)
4+51.87 59.90

0+00

(727) F-9
2705.44' N.
(2705.65' E.) NOTES

10 MILE RD.

(830) Fo. 1/2" PIPE
14+88.59 59.60
(731) Fo. 1/2" PIPE
13+52.90 60.05
(730) Fo. 1/2" PIPE
15+31.00 59.94
(749) Fo. 5/8" PIPE
17+22.26 59.96

(2706.00' E.) PLATS
(2706.65' E.) PLATS

180° 06' 00" N.
180° 05' 53" E. (NOTES)

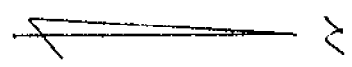

LITTLE MACK

(711) G-9
F-9

LENNON

FRIN TWP.

6-6-02 500

02-100. MARCOAR Co.

E.A.M.

GPS RTK

ELEVATION: 02200E

BASE STA. C 705

ANTENNA HT. 4.85

NEAR To Hook (CENTER)

Using Hook Tape

Start Time AM

COVER Bouma. Tape

ANT. Ht. 7.063

RESHOT (179) OFF

(178) GHI

(177) OFF

SHOT 749-751

RESHOT (179) OFF

(178) OFF

X = 750 - 749

(179) 00° 00' 00" 191.285

(178) 180° 03' 00" 342.408

OK 385

S.D. 0 m - 5.5

E. 9 10 RILE Rd

(179) 0-9

(178) Eo. 1/8" 1.800 1178.59 59.60

(177) Eo. 1/8" 1.800 1352.98 60.05

(176) Eo. 1/8" 1.800 1527.06 59.94

(175) Eo. 5/8" 1.800 1722.20 59.96

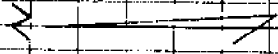

LITTLE BLOCK

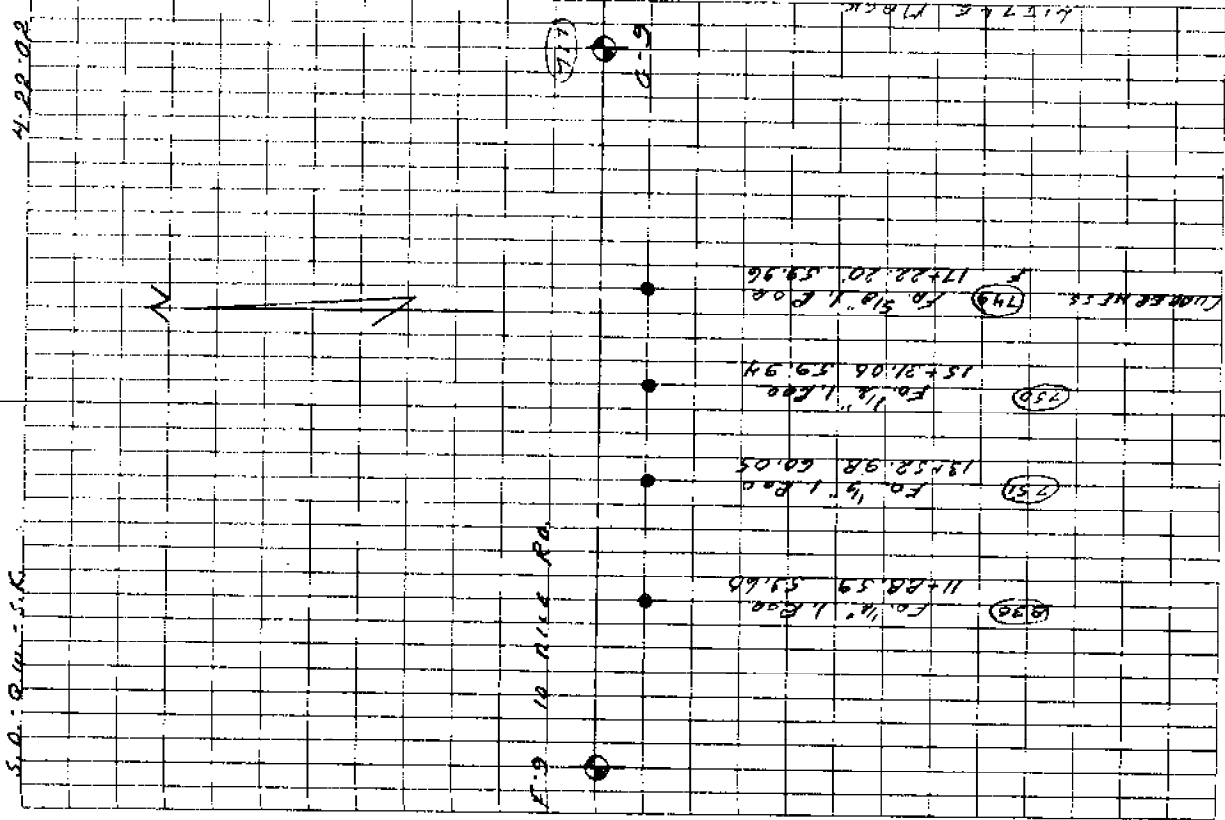



TETRA TECH MPS

August 24, 2001

~~Macomb~~
Macomb Sec 24.057

Mr. William E. Soderberg
Macomb County Remonumentation Surveyor
C/O Macomb County Register of Deeds
10 North Gratiot
Mount Clemens, Michigan 48043

^{ERIN}
Re: LCRC ~~Macomb~~ Twp Corner Code F-9

Dear Mr. Soderberg:

We are under contract with the Michigan Department of Transportation to provide a design survey for improvements to the 10 Mile Road Bridge over I-94 (MDOT CS 50111, JN 51477H). Part of our assignment is to perpetuate any Public Land Corner within the limits of construction.

Corner "F-9" for ^{ERIN} ~~Macomb~~ Township, Town 1 North, Range 13 East is in the West approach about 66 feet West of the West end of the bridge. This corner may be impacted by the proposed year 2002 bridge construction.

There was no previous LCRC recorded for F-9. The only witness information we came up with were provided by MDOT and predated the I-94 construction. None of those witnesses remain

A railroad spike in a monument box was found as evidence for the corner. Our survey ties to irons in neighboring subdivisions fit the found railroad spike and monument box within 0.6 feet +/- . We also measured 2700.97 feet West to a 1" rebar in a mon box @ E-9 and 2705.65 feet East to a monument with cap # 34970 in a mon box. The (northerly) angle between E-9; F-9 and G-9 is measured as 180°05'52"

We have filed an LCRC (enclosed) at the Macomb County Register of Deeds (L 10507, P 715) as required by State law and our contract with MDOT.

You may want to consider scheduling this corner in the 2002 remor program to coordinate any excavation work with the 2002 bridge construction.

Please feel free to contact us if we may be of any further assistance on this matter.

Sincerely,

Arvin N. Butterfield, P.S.

Enclosure

k:\mps\letters\Macomb.doc

123 Brighton Lake Road, Ste. 203
Brighton, MI 48116
Tel: 810.220.2112 Fax: 810.220.0094

LAND CORNER RECORDATION CERTIFICATE
Filing Requirement of Act 74, Mich. P.A. 1970

For corners in

<u>Macomb</u> (County)	Located In:	Corner Code #
1. Public Land Survey	T <u>IN</u> R <u>13E</u>	<u>F-9</u>
	T <u> </u> R <u> </u>	<u> </u>
	T <u> </u> R <u> </u>	<u> </u>
	T <u> </u> R <u> </u>	<u> </u>
2. Property Controlling in Section	S <u> </u> T <u> </u> R <u> </u>	<u> </u>
	S <u> </u> T <u> </u> R <u> </u>	<u> </u>
3. Miscellaneous Property in Sec.	S <u> </u> T <u> </u> R <u> </u>	<u> </u>
	S <u> </u> T <u> </u> R <u> </u>	<u> </u>

1124754
LIBER 10507 PAGE 715
 07/12/2001 02:03:06 P.M.
 MACOMB COUNTY, MI
 CARNELLA SABAUGH, REGISTER OF DEEDS

Register of Deeds Stamp & File Number

4. Lot No. _____, Recorded Plat _____
 5. Private Claims _____

I, Arvin N. Butterfield, in a field survey on 6/7, 2001 do hereby state that under requirements of P.A. 74, Michigan P.A. of 1970, the corner points mentioned in lines 1 and 2 above were in conformance with regulations and rules therefore as required in the current manual of survey instructions of the United States Department of the Interior, Bureau of Land Management or by a decree of a Court of Law and/or that the corner points mentioned in lines 3, 4 and 5 above were in conformance with the rules of the Michigan Board of Land Surveyors or by a Decree of a Court of Law, established, re-established, monumented, recovered, found as expressed below.

NOTE: Not more than 2 corners, all in the same town and range, may be recorded on this certificate.

	A	B	C	D	E	F	G	H	I	J	K	L	M
1													
2		6		5		4		3		2		1	
3													
4		7		8		9		10		11		12	
5													
6		18		17		16		15		14		13	
7													
8		19		20		21		22		23		24	
9													
10		30		29		28		27		26		25	
11													
12		31		32		33		34		35		36	
13													

A. Description of original monument and accessories and/or subsequent restoration:

F-9
 House #19623 N28°W 98.54 to SE Corner
 House #19701 N34°W 98.27 to SW Corner
 Light Pole S44°W 48.66

B. Description of corner evidence found and/or method applied in restoring or reestablishing corner:

F-9
 Found Railroad Spike in monument box. Above Witnesses have been destroyed. Railroad Spike fits local monumentation to within 0.6'±.

C. Description of monument for corner and accessories established to perpetuate locating the position of the corner:

F-9
 Found Railroad Spike in monument box.
 Top of fence anchor post N55°E 63.31' to chiseled X
 SW anchor bolt in traffic signal pole S50°E 63.66' to chiseled X
 NW anchor bolt in light pole S02°E 62.71' to chiseled X
 Top bolt of fire hydrant N45°W 76.11' to chiseled X



Signed by Arvin N. Butterfield
 Surveyor's Michigan License No. 21561

Date June 22, 2001

ERIP
Temp.

INDEX MAPS

T. 1 N. R. 13 E. Mer. Mich

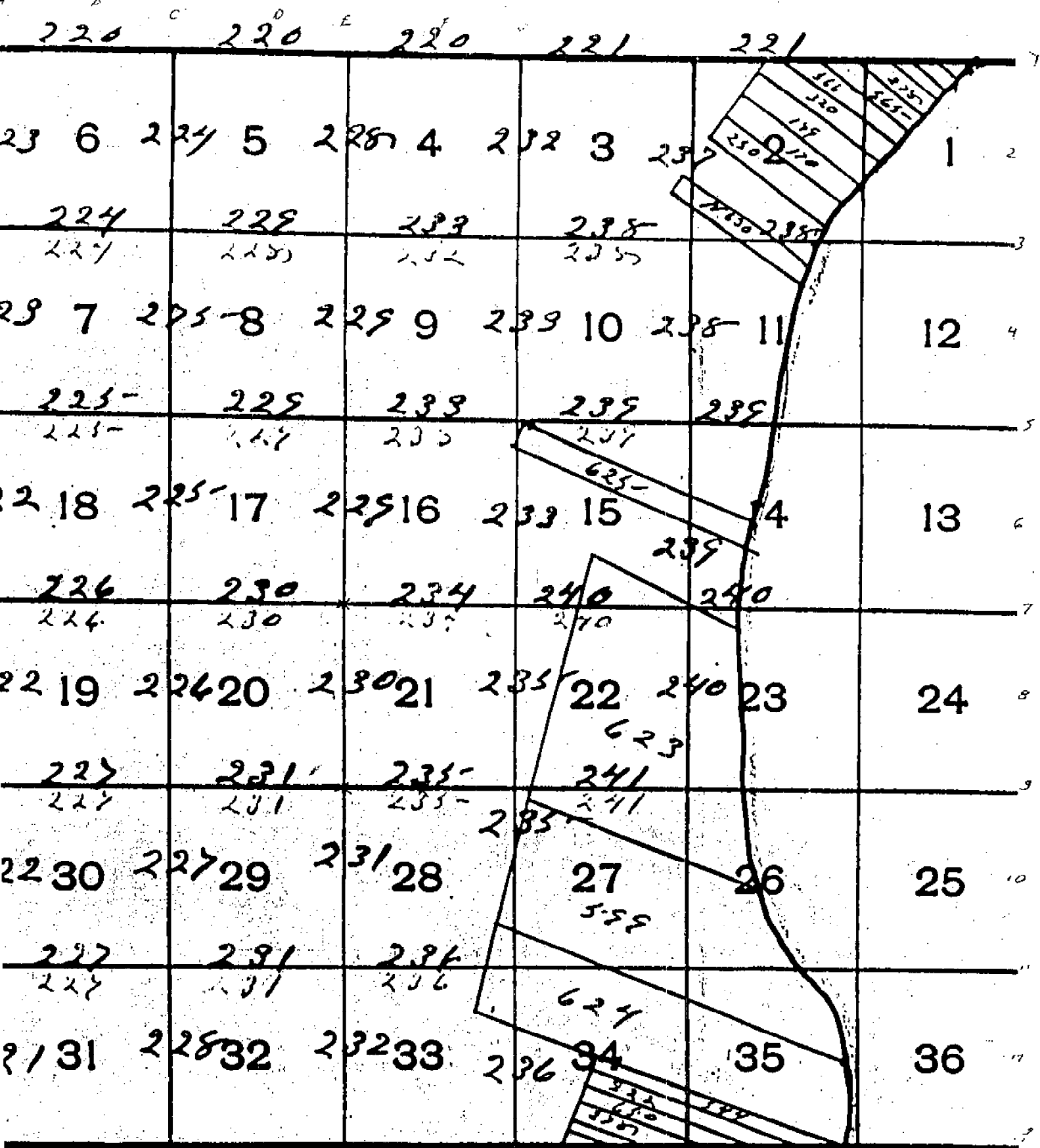

Recorded on Page 241

T. 2 N. R. 13 E. Mer. Mich.

246 246 247 247

Town North Range 13 East

South Between Sections 21, 22
 13.65 a B. Ash 20 in dia
 40.00 Made half mile corner on
 a Beech 13 in dia
 57.03 a Poplar 24 in di
 80.00 Set front for Sections 21, 22, 28, 27
 from which a Beech 18 in di bears N49 E
 24 lin distant a Beech 12 in di bears
 N62 W 27 links dist
 1st half mile level part dry 2 $\frac{1}{4}$ rate
 Last half mile dry good 2 $\frac{1}{4}$ rate
 Timber W Oak Poplar Sugar
 Beech Lym Undergrowth Spice &c

West On Random between S. 21 & 28
 40.00 Set temporary half mile front
 80.10 Put ~~the~~ west boundary at the corner
 Land level part dry 2 $\frac{1}{4}$ rate
 Timber W. Oak B. Ash Beech Poplar
 Lym Elm & Undergrowth Spice
 Hornbeam &c

East Connected between S 21 & 28
 40.05 Made 74 section corner on a
 Lym 12 in dia
 80.10 To section corner

South Between Sections 28 & 27
 13.12 a B. Ash 12 in dia
 40.00 Set half mile front from W which
 a Beech 20 in dia bears S78 25
 links also a Beech 14 in di bears