

LAND CORNER RECORDATION CERTIFICATE
 Filing Requirement of Act 74, Mich. P.A. 1970

For corners in

Macomb Located In: Corner Code #
 (County) Armada Township

- | | | | |
|------------------------------------|-------------|--------------|-------------|
| 1. Public Land Survey | T <u>5N</u> | R <u>13E</u> | <u>L-13</u> |
| | T _____ | R _____ | _____ |
| | T _____ | R _____ | _____ |
| | T _____ | R _____ | _____ |
| 2. Property Controlling in Section | S _____ | T _____ | R _____ |
| | S _____ | T _____ | R _____ |
| 3. Miscellaneous Property in Sec. | S _____ | T _____ | R _____ |
| | S _____ | T _____ | R _____ |

114757
 LIBER 9643 PAGE 783
 07/11/2000 08:03:23 A.M.
 MACOMB COUNTY, MI
 CARMELLA SABAUGH, REG/DEEDS

Register of Deeds Stamp & File Number

4. Lot No. _____, Recorded Plat _____
 5. Private Claims _____

I, Huston K. Kennedy, in a field survey on March 2, 2000 do hereby state that under requirements of P.A. 74, Michigan P.A. of 1970, the corner points mentioned in lines 1 and 2 above were in conformance with regulations and rules therefore as required in the current manual of survey instructions of the United States Department of the Interior, Bureau of Land Management or by a decree of a Court of Law and/or that the corner points mentioned in lines 3, 4 and 5 above were in conformance with the rules of the Michigan Board of Land Surveyors or by a Decree of a Court of Law; established, re-established, monumented, recovered, found as expressed below:

	A	B	C	D	E	F	G	H	I	J	K	L	M
1													
2		6		5		4		3		2		1	
3													
4		7		8		9		10		11		12	
5													
6		18		17		16		15		14		13	
7													
8		19		20		21		22		23		24	
9													
10		30		29		28		27		26		25	
11													
12		31		32		33		34		35		36	
13													

NOTE: Not more than 2 corners, all in the same town and range, may be recorded on this certificate.

- A. Description of original monument and accessories and/or subsequent restoration:
 1817-GLO Preston, D.S.; 6" Elm used as the corner, no witnesses
 1.) 1974-Avendt, Jr., PS #16034; LCRC L.2547, pg.433 – Fnd a ½" Pipe (The witnesses are gone)
 2.) 1992-Miller, PS #27456; Survey L.5636, pg.719 – Fnd a ½" Iron Rod in a Monument Box
 3.) 1992-Sheridan Surveying Co., - unrecorded Survey – Fnd a ½" Iron Rod in a Monument Box
- B. Description of corner evidence found and/or method applied in restoring or reestablishing corner:
 2000-Kennedy Surveying, inc. – Kennedy, PS #17623 – Fnd a ½" Iron Rod in a Monument Box located in the existing centerline of 32 Mile Road extending to the East & West, which has a bituminous surface. North ¼ corner of Section 1, T4N, R13E, Ray Township (L-1) is located 48.30 feet to the West.

Witnesses from LCRC #2 were used to recover and verify the location of the found ½" Iron Rod in a Monument Box.

I accepted the found ½" Iron Rod in a Monument Box as the best evidence of the original corner position.

FIELD MEASUREMENTS BETWEEN

<u>L-13 to K-13</u> GLO = 40 chains or 2640.00 Ft. Unrecorded Survey by Sheridan Surveying Co., Dated 6/92 = 2653.37 Ft. 2653.27 Ft. (MEA-2000)	<u>L-13 to L-1</u> No GLO 48.30 Ft. (MEA-2000)	<u>L-13 to M-13</u> GLO = 40 chains or 2640.00 Ft 2678.48 Ft. (MEA-2000)
---	--	--

- C. Description of monument for corner and accessories established to perpetuate locating the position of the corner:
 L-13 I replaced the found ½" Iron Rod in a Monument Box with a ¾" x 24" Iron Rod w/2" diameter aluminum cap. Monument cap engraved "Macomb County Monument MI Act #345", PS #17623 in the existing Monument Box
 S55°E 57.07' Set Mag Nail & Remon Washer NE face Power Pole
 N62°E 129.56' Set Mag Nail & Remon Washer SE face 7" Elm
 N28°E 109.91' Set Mag Nail & Remon Washer SE face 8" Elm
 S31°W 84.90' Set Mag Nail & Remon Washer NW face 11" Elm
 West 48.30' North ¼ corner of Section 1, T4N, R13E, Ray Township (L-1)



The selected location is accepted by me and is generally accepted by Professional Surveyors as the best available evidence of the position of the original corner.

Signed by: [Signature] Date 5-22-00
 Surveyor's Michigan License No. 7623

ACCEPTED BY THE MACOMB COUNTY SURVEY PEER GROUP AS THE OFFICIAL CORNER UNDER MICHIGAN PUBLIC ACT 345 OF 1990 AT A MEETING HELD ON 5/16/00
[Signature]
 WILLIAM E. SODERBERG, P.S., CHAIRMAN

FORM APPROVED BY MICHIGAN STATE BOARD OF PROFESSIONAL SURVEYOR'S, JAN. 28, 1971
 REVISED MAY 14, 1975
 REVISED JAN., 1983
 REVISED OCT., 1995





2000
MACOMB COUNTY REMONUMENTATION
PROGRAM FOR ARMADA TOWNSHIP

Research Dossier for L-13

Prepared by:
Kennedy Surveying, Inc.
105 North Washington Street
Oxford, Michigan 48371
00-5020

Sources of Information Researched For Macomb 2000 Remonumentation Program FOR ARMADA TOWNSHIP

- 1.) GLO Notes
- 2.) Act 74 Recorded LCRC
- 3.) Act 132 Recorded Surveys
- 4.) Personal History and Records
- 5.) Letters to the Following Requesting Unrecorded
LCRCs and Surveys
 - a.) Anderson, Eckstein & Westrick
 - b.) Fenn & Associates Surveying, Inc.
 - c.) King & Associates
 - d.) AES Engineers & Surveyors, Inc.
 - e.) Metco Land Sea Corp.
 - f.) Raymond Donnelly & Associates
 - g.) Metco-Dunn, Inc.
 - h.) Road Commission for Macomb County
 - i.) Macomb County Public Works
 - j.) George Jerome & Company
 - k.) Kem-Tec Surveying
 - l.) Mickalich & Associates
 - m.) Lehner Associates, Inc.
 - n.) Spalding, DeDecker & Associates
 - o.) M.C.S. Associates, Inc.
 - p.) Urban Land Consultants

GLO NOTES

Researching the government survey records for Macomb County shows that the post was set at the South ¼ of corner of Section 36 in 1817 by William Preston, D.S.

6" Elm was used as the corner (no witnesses)

EXISTING CONDITIONS

The original government post has been obliterated and the witness trees have been destroyed. The corner has been perpetuated with a ½" Iron Rod in a Monument Box located in the existing centerline of 32 Mile Road extending to the East & West, which has a bituminous surface. North ¼ corner of Section 1, T4N, R13E, Ray Township (L-1) is located 48.30 feet to the West.

LCRC AND RECORDED SURVEYS

Researching the Macomb County Records for Land Corner Recordation Certificates (LCRC) shows that George J. Avendt, Jr., PS #16034 recorded a LCRC on November 6, 1974. He found a ½" Pipe. The witnesses are gone.

WITNESSES: (Based upon LCRC recorded in Liber 2547, page 433 of Macomb County Records)

NE 71.82 Ft. Fnd MCRC PK Nail & Tag in telephone pole (gone)
SE 89.30 Ft. Fnd PK Nail NE side 20" Maple (gone)
SW 66.02 Ft. Fnd PK Nail in power pole (gone)
NW 54.06' Fnd PK Nail & MCRC Tag in telephone pole (gone)

James H. Miller, PS #27456 recorded a LCRC on November 6, 1992 in Liber 5636, page 719 of Macomb County Records. He found a ½" Iron Rod in a Monument Box.

WITNESSES:

*S20°W 32.95' Nail in fence corner post
*S50°E 57.10' Nail in East side power pole
*North 39.85' Centerline top MBT riser box
*N35°E 59.20' F-1/2" steel gate post

UNRECORDED SURVEYS & WITNESSES

Sheridan Surveying Company did a Survey in June 1992 and found a ½" Iron Rod in a Monument Box, and used the same witnesses as those listed above on the 1992 LCRC.

FIELD MEASUREMENTS BETWEEN

L-13 to K-13

GLO = 40 chains or 2640.00 Ft.
Unrecorded Survey by Sheridan Surveying, Co., dated 6/92 = 2653.37 Ft.
2653.27 Ft. (MEA-2000)

L-13 to L-1

No GLO
48.30 Ft. (MEA-2000)

L-13 to M-13

GLO = 40 chains or 2640.00 Ft.
2678.48 Ft. (MEA-2000)

The witnesses for the above mentioned Land Corner Recordation Certificate were used to verify the location of the found ½" Iron Rod in a Monument Box as of March 1, 2000. I therefore, recommend to the Macomb County Peer Group that they accept the ½" Iron Rod in a Monument Box as found as the best evidence of the original corner position.

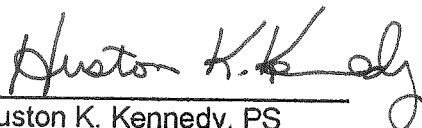

Huston K. Kennedy, PS
Kennedy Surveying, Inc.

*Used to verify the location of the found corner (L-13)

1000 5 North Range 13 East.

1000 2 miles

South Range 13 East

11st. Random between 1000 2 miles 1415 N Range 13 East

33.50 On 30 lbs side con. S.W. Clear Stream
granular bottom

11.00 Set trap 1/2 mile post

10.00 Set trap 1/2 mile post

Land 2nd rate part dry

Print Buck 2nd Sugar &c part fallen

Undergrowth 1st than Blue &c

11.00 Set trap 1/2 mile post

10.20 On 27 lbs side Clear South

10.00 Set trap 2 mile post

Land 2nd rate part dry

Print Buck ash Sugar &c. Part fallen

Undergrowth 1st than Prickly Ash

Blue &c.

11st

11.00 Set trap 1/2 mile post

10.00 Set trap 3 mile post

Land 2nd rate Print Ash Sugar Elm

Buck Oak &c Undergrowth 1st Prickly Ash

Town 5 North Range 13 East

Just corrected between Township 44 S North Range 13 East
 40.00 Set 1/4 sec post from which a Cypress
 28 inches diam bears N 23 E 18 links
 dist also an Elm 16 in diam bears
 S 51 E 31 lks dist
 80.00 Made 2 mile tree for Cor. of 210 34 + 35
 on an Elm wood 4 in diam

Just corrected between Township 44 S North Range 13 East
 40.00 Made Cor. for 1/4 sections on an Elm
 6 in diameter
 80.00 Set mile post for Cor of sections 35 + 36
 from which a Sugar tree 18 in diam bears
 N 78 E 38 lks dist - also a Sugar 18 in
 diam bears S 60 E 19 lks dist

110.00 Made Cor for 1/4 sec on a Beech
 4 in diam
 80.00 To Township Cor.

Surveyed 1877 by Wm. Preston Esq.

East Boundary

LIBER 05636PG719

B792440

LAND CORNER RECORDATION CERTIFICATE
Filing Requirement of Act 74, Mich. P.A. 1970

For corners in

Macomb
(County)

Located In:

Corner Code #

Arvada Twp.

- | | | | | | |
|------------------------------------|---|----|---|-----|---------------|
| 1. Public Land Survey | T | 5K | R | 13E | K-13(SW 36) |
| | T | 5N | R | 13E | L-13(S1/4 36) |
| | T | | R | | |
| | T | | R | | |
| 2. Property Controlling in Section | S | | T | R | |
| | S | | T | R | |
| 3. Miscellaneous Property in Sec. | S | | T | R | |
| | S | | T | R | |

RECORDED IN MACOMB COUNTY
RECORDS AT: 12:19 P
NOV 06 1992

Edna Miller
CLERK - REGISTER OF DEEDS
MACOMB COUNTY, MICHIGAN

Register of Deeds Stamp & File Number

4. Lot No. _____ Recorded Plat _____
5. Private Claims _____

	A	B	C	D	E	F	G	H	I	J	K	L	M
2	6	5	4	3	2	1							
3													
4	7	8	9	10	11	12							
5													
6	18	17	16	15	14	13							
7													
8	19	20	21	22	23	24							
9													
10	30	29	28	27	26	25							
11													
12	31	32	33	34	35	36							
13													

I, James H. Miller, in a field survey on July 21, 19 92 do hereby certify that under requirements of P.A. 74, Michigan P.A. of 1970, the corner points mentioned in lines 1 and 2 above were in conformance with regulations and rules therefore as required in the current manual of survey instructions of the United States Department of the Interior, Bureau of Land Management or by a decree of a Court of Law and/or that the corner points mentioned in lines 3, 4 and 5 above were in conformance with the rules of the Michigan Board of Land Surveyors or by a Decree of a Court of Law, established, re-established, monumented, re-monumented, recovered, found as expressed below:

NOTE: Not more than 4 corners, all in the same town and range, may be recorded on this certificate.

- A. Description of original monument and accessories and/or subsequent restoration:
- K-13 P.K. nail & cap per Consumers Power Co. drawing #SP-16750, Sheet 1A.
 - L-13 No information.

- B. Description of corner evidence found and/or method applied in restoring or reestablishing corner:
- K-13 Found 1" iron in monument box.
 - L-13 Found 1/2" iron in monument box.

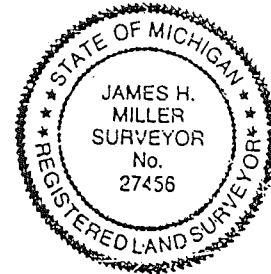

- C. Description of monument for corner and accessories established to perpetuate locating the position of the corner:
- | | | | | | | | |
|------------------------------------|------|--------|----------------------------|--------------------------------------|-------|--------|----------------------------|
| L-13 Found 1" Iron in Monument Box | N45E | 45.45' | N & C in Power Pole | L-13 Found 1/2" Iron in Monument Box | S20W | 32.95' | Nail in Fence Corner Post |
| | S40E | 43.50' | N & C in Power Pole | | S50E | 57.10' | Nail in E. Side Power Pole |
| | N40W | 74.20' | N & C in HBT Pole | | North | 39.85' | Cl. Top HBT Riser Box |
| | S15W | 65.70' | East Leg of Stop Sign Post | | N35E | 59.20' | 5-1/2" Steel Gate Post |

Signed by James H. Miller Date 10-21-1992
Surveyor's Michigan License No. 27456

LAND CORNER RECORDATION CERTIFICATE

FILING REQUIREMENT OF ACT 74, MICH. P.A. 1970

Armada Township, Macomb County

A282314

FOR CORNERS OF-- S. 1/2	LOCATED IN-- Sec. 36	CORNER CODE NUMBER
1. PUBLIC LAND SURVEY T. 5 N. R. 13 E. <input checked="" type="checkbox"/>		L-13 S. 1/4 cor.
2. PROPERTY CONTROLLING IN SECTION T. N. S. R. W.		
3. MISCELLANEOUS PROPERTY IN SECTION T. N. S. R. W.		
4. LOT NO. _____, RECORDED PLAT _____		
5. PRIVATE CLAIMS _____		

RECORDED IN MACOMB COUNTY
 RECORDS AT: 1:00 P M
 NOV-6 1974
Edna H. Hill
 CLERK - REGISTER OF DEEDS
 MACOMB COUNTY, MICHIGAN
 REGISTER OF DEEDS STAMP AND
 FILING NUMBER

I, George J. Avendt Jr. do hereby certify that under requirements of P.A. 74, Michigan P.A. of 1970, the corner points mentioned in lines 1 and 2 above (identified with circles on index code diagram - over) were, in a field survey on September 1974, established, re-established, monumented, re-monumented, recovered or restored as expressed below and in conformance with regulations and rules therefore as required in the current manual of survey instructions of the United States Department of the Interior, Bureau of Land Management or by a decree of a court of law. Furthermore, that the corner points mentioned in lines 3, 4 and 5 above were, in a field survey on _____ 19____, found, recovered, restored, established or re-established as expressed below and in conformance with the rules of the Michigan State Board of Registration for Land Surveyors or, by a Decree of a Court of law:

A. Description of original monument and accessories and/or subsequent restoration:

B. Description of corner evidence found and/or method applied in restoring or re-establishing corner:

L-13 Found 1/2" Pipe

C. Description of monument for corner and accessories established to perpetuate locating the position of the corner:

L-13 N.E. 71.82 ft. Found M.C.R.C. P.K. Nail & Tag in Tel. pole
 S.E. 89.30 ft. Found P.K. Nail N.E. side of 20" Maple
 S.W. 66.02 ft. Found P.K. Nail in Power pole
 N.W. 54.06 ft. Found P.K. Nail & M.C.R.C. Tag in Tel. pole

SIGNED BY *George J. Avendt Jr.* DATE October 30, 1974

SURVEYOR'S MICHIGAN REGISTRATION NO. 16034

FOR STATE AND UNITED STATES AGENCIES:

SIGNED BY _____ DATE _____
CHIEF OF SURVEY PARTY

APPROVED AND SIGNED BY _____ DATE _____
MICHIGAN REGISTERED LAND SURVEYOR

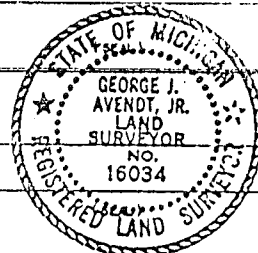

SURVEYOR'S MICHIGAN REGISTRATION NO. _____

5

M-13

S1

OMO

RD.

Creek

-002
551.76

36

300

-011
39.078

834.29

Armada and Roy

Drain

1.32 MILE

NORTH

ARMADA TWP
K-13

K-13

- REV. 12-97
- REV. 12-91
- REV. 3-88
- REV. 6-87
- REV. 5-86
- REV. 7-83
- REV. 9-81
- REV. 4-80
- REV. 7-79
- REV. 2-78
- REV. 2-77
- REV. 1-76
- REV. 3-75