

MACOMB COUNTY REMONUMENTATION

RESEARCH DOSSIER FOR

SOUTHWEST CORNER, SECTION 31

TOWN 5 NORTH, RANGE 13 EAST

ARMADA TOWNSHIP (A-13)

C126172

LAND CORNER RECORDATION CERTIFICATE
Filing Requirement of Act 74, Mich. P.A. 1970

94 SEP 30 AM 9:02

CARMI R. SABAUGH
REGISTER OF DEEDS
MACOMB COUNTY, MI

For corners in

Macomb (County) Located In: Armada Township Corner Code #A-13
1. Public Land Survey T 5N R 13E
2. Property Controlling in Section S T R
3. Miscellaneous Property in Sec. S T R

LIBER 06464PG485

Register of Deeds Stamp & File Number

4. Lot No. Recorded Plat
5. Private Claims

I, Huston K. Kennedy, in a field survey on July 5, 1994, do hereby certify that under requirements of P.A. 74, Michigan P.A. of 1970, the corner points mentioned in lines 1 and 2 above were in conformance with regulations and rules therefore as required in the current manual of survey instructions of the United States Department of the Interior, Bureau of Land Management or by a decree of a Court of Law and/or that the corner points mentioned in lines 3, 4 and 5 above were in conformance with the rules of the Michigan Board of Land Surveyors or by a Decree of a Court of Law; established, re-established, monumented, re-monumented, recovered, found as expressed below:

Grid table with columns A-M and rows 2-13. Contains numbers 1-36 in a grid pattern.

NOTE: Not more than 4 corners, all in the same town and range, may be recorded on this certificate.

A. Description of original monument and accessories and/or subsequent restoration:

- 1817-GLO Wampler, D.S.; Post was made for Townships 4 & 5 North, Ranges 12 & 13 East; No bearing trees
1.) 1979-Kobs, P.S. #14097; LCRC L.3162, Pg.598 - Fnd 1/2" Pipe (Armada Twp.)
2.) 1980-Miller, P.S. #13589; LCRC L.3288, Pg.640 - Fnd 3/8" Re-rod (Bruce Twp.)
3.) 1989-Kobs, P.S. #14097; LCRC L.4729, Pg.131 - Fnd 1/2" Iron Rod in a Monument Box (Washington Twp.)

B. Description of corner evidence found and/or method applied in restoring or reestablishing corner:

1994 Kennedy Surveying, Inc. - Kennedy, P.S. #17623 - Fnd 5/8" Iron Rod in a Monument Box in the centerline of Powell Road, which has a concrete surface, and 21 feet North of the driveway for house #68950.

Witnesses from LCRC #2 & 3 were used to recover and verify the location of the found 5/8" Iron Rod in a Monument Box.

ACCEPTED BY THE MACOMB COUNTY SURVEY PEER GROUP AS THE OFFICIAL CORNER UNDER MICHIGAN PUBLIC ACT 345 OF 1990 AT A MEETING HELD ON 8-16-94
William E. Soderberg
WILLIAM E. SODERBERG, P.S., CHAIRMAN

C. Description of monument for corner and accessories established to perpetuate locating the position of the corner:

A-13 I replaced the found 5/8" Iron Rod in a Monument Box with a 3/4" x 24" Iron Rod w/2" diameter aluminum cap stamped "Macomb County Monument MI Act 345 #17623" in a existing Monument Box.
S70°W 31.10' Set PK & Remon. Washer top of Guard Rail
S40°E 46.72' Set PK & Remon. Washer top of Guard Rail Post
S30°E 70.63' Set PK & Remon. Washer NE face Power Pole
N87°E 138.85' Set PK & Remon. Washer South face 36" Maple

The selected location is accepted by me and is generally accepted by Professional Surveyors as the best available evidence of the position of the original corner.

Signed by [Signature] Date
Surveyor's Michigan License No. 17623



GLO NOTES

Researching the government survey records for Macomb County shows that a post was made out of a Ironwood 4" in diameter for Townships 4 & 5 East, Ranges 12 & 13 East in 1817 by Joseph Wampler, D.S.

No bearing trees

EXISTING CONDITIONS

The original government post has been obliterated and the witness trees have been destroyed. The post has since been replaced with a 5/8" Iron Rod in a Monument Box in the centerline of Powell Road, which has a concrete surface, and 21 feet North of the driveway for house #68950.

LCRC AND RECORDED SURVEYS

Researching the Macomb County Land Corner Recordation Certificates (LCRC) shows that Herbert J. Kobs, P.S. #14097, recorded the first LCRC on October 2, 1979 and found 1/2" Pipe.

WITNESSES: (Based upon LCRC, recorded in Liber 3162, Page 598 of Macomb County Records)

- *P.K. Nail in 12" Elm East 94.02 Feet
- P.K. Nail in Guard Post S.W. 29.71 Feet
- P.K. Nail in Guard Post S.E. 52.26 Feet

The witnesses for the above mentioned Land Corner Recordation Certificate verify the found 5/8" Iron Rod in a Monument Box as of July 5, 1994. I, therefore, recommend to the Macomb County Peer Group that they accept the 5/8" Iron Rod in a Monument Box as found as the best evidence of the original corner position.

Huston K. Kennedy, PS
Kennedy Surveying, Inc.

*Used to verify the location of the found corner (A-13)

**SOURCES RESEARCHED FOR
INFORMATION FOR REMONUMENTATION
OF GOVERNMENT SECTION CORNERS
FOR ARMADA TOWNSHIP
MACOMB COUNTY**

- 1.) GLO Notes
- 2.) Act 74 Recorded LCRC
- 3.) Act 132 Recorded Surveys
- 4.) Personal History and Records
- 5.) Letters to the Following Requesting Unrecorded
LCRCs and Surveys
 - a.) Anderson, Eckstein & Westrick
 - b.) Detroit Edison
 - c.) Metco-Dunn, Inc.
 - d.) M.C.S. Associates, Inc.
 - e.) Kaye Engineering
 - f.) Del-tec Surveying & Engineering
 - g.) Kobs-King & Associates
 - h.) Lehner Associates
 - i.) Urban Land Consultants
 - j.) George Jerome & Company
 - k.) Macomb County Road Commission
 - l.) Macomb County PublicWorks Commission
 - m.) Spalding, DeDecker & Associates, Inc.
 - n.) Delta Surveying
 - o.) Fenn & Associates Surveying, Inc.

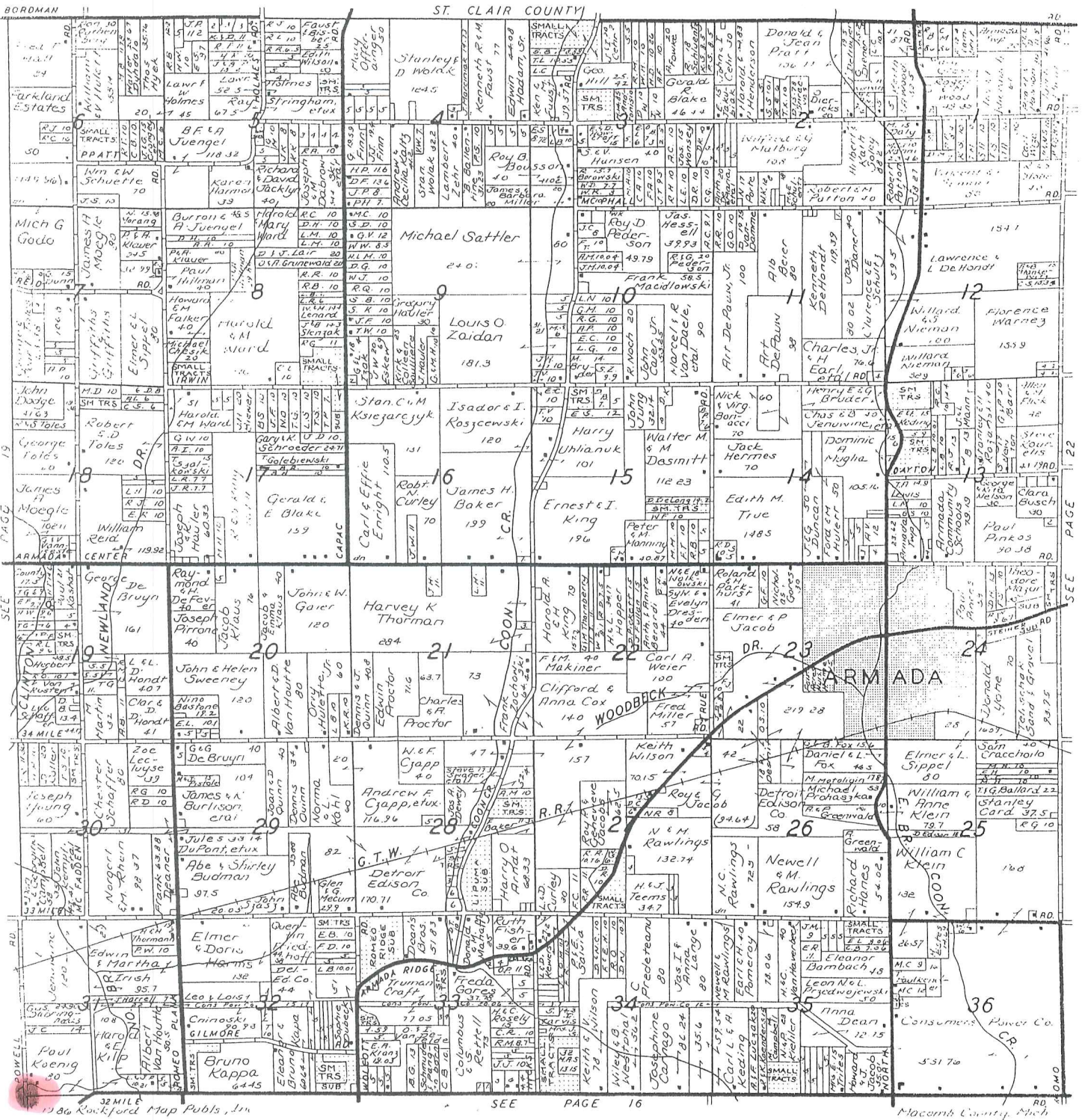

Teltow Insurance Agency

Shirley R. Teltow
Agent



LIFE - HOME - CAR - BUSINESS - FARM

69303 North Main Street - Box 56
Richmond, Michigan 48062

727-6075

ARMADA Agriculture Fair

Since 1872

SAVE TIME & STEPS

When You Are Ready to Buy, Sell, or Need Service
Look In The

Classified Business Directory

Form 4 North Range. 12 East

also an Elm 8 in diam bears S 71 W 20 lbs dist
 58.00 Left In camp
 79.73 A. B. Ash 4 in diam
 80.00 Set 4 mile post for Cor. Section 12713
 from which an Ash 10 in diam bears N 20 E 20 lbs distant
 also a B. Ash 16 in diam bears N 80 W 30 lbs dist
 Land first half mile 2nd rate - last half
 same Timber Beech Alder Spr. Ash Willow &c

North

27.66 an Spruce 22 in diam
 40.00 Set 7/4 Sec post from which
 a Beech 4 in diam bears N 27 W 7 lbs distant
 also an Elm 5 in diam bears N 47 E 21 lbs dist
 65.50 an Elm 14 in diam
 80.00 Set 5 mile post for Cor. Section 1412 from
 which a Sugar tree 12 in diam bears East 5 lbs
 also a Maple 14 in diam bears N 49 W 14 lbs distant
 Land first half mile 2nd rate level and dry
 last half same
 Timber B. Ash Poplar Beech &c
 Undergrowth Beech Hornbeam &c

Surveyed 1877 by Joseph Menapfe D.S.

North

11.21 A. B. Ash 14 in diam
 40.00 Set 7/4 Sec post from which
 a Beech 16 in diam bears N 48 W 20 lbs distant
 also a Poplar 11 in diam bears South 65
 W 27 lbs dist
 61.50 Cor 12 lbs wide E. S. E.
 74.05 an Elm 12 in diam
 77.00 Cor 30 lbs wide S. E.
 80.00 ~~made Cor for Township 12713 N 12 E~~
~~Range 12 East on an Ironwood 11 in~~
~~diam - Land first half mile 2nd rate~~
 Level and dry last half same
 Timber B + W Ash W Oak Sugar Spruce &c

LAND CORNER RECORDATION CERTIFICATE

FILING REQUIREMENT OF ACT 74, MICH. P.A. 1970

LIBER 3162 PAGE 598

FOR CORNERS OF --:	LOCATED IN --:	CORNER CODE NUMBER
1. PUBLIC LAND SURVEY _____ T. <u>5</u> N. S. R. <u>13</u> E. W.		(A-13) (B-12) (B-13)
2. PROPERTY CONTROLLING IN SECTION _____ T. <u>5</u> N. S. R. <u>13</u> E. W.		ARMADA TOWNSHIP
3. MISCELLANEOUS PROPERTY IN SECTION _____ T. _____ N. S. R. _____ E. W.		
4. LOT NO. _____, RECORDED PLAT _____		
5. PRIVATE CLAIMS _____		

A612789

RECORDED IN MACOMB COUNTY
RECORDS AT: 1:48 P. M.
OCT - 2 1979

Edna Hill
CLERK - REGISTER OF DEEDS
MACOMB COUNTY, MICHIGAN

REGISTER OF DEEDS STAMP AND
FILING NUMBER

I, HERBERT J. KOBS, do hereby certify that under requirements of P.A. 74, Michigan P.A. of 1970, the corner points mentioned in lines 1 and 2 above were, in a field survey on JULY 16, 1979, established, re-established, monumented, re-monumented, recovered or restored as expressed below and in conformance with regulations and rules therefore as required in the current manual of survey instructions of the United States Department of the Interior, Bureau of Land Management or by a decree of a court of law. Furthermore, that the corner points mentioned in lines 3, 4 and 5 above were, in a field survey on _____, 19____, found, recovered, restored, established or re-established as expressed below and in conformance with the rules of the Michigan State Board of Registration for Land Surveyors or, by a Decree of a Court of law:

A. Description of original monument and accessories and/or subsequent restoration:

B. Description of corner evidence found and/or method applied in restoring or re-establishing corner:

- (A-13) FOUND 1/2" PIPE
- (B-12) FOUND T-IRON
- (B-13) FOUND 3/4" PIPE

C. Description of monument for corner and accessories established to perpetuate locating the position of the corner:

- | | |
|--|---|
| (A-13) 1/2" PIPE
P.K. NAIL IN 12" ELM - EAST - 94.02'
P.K. NAIL IN GUARD POST - S.W. - 29.71'
P.K. NAIL IN GUARD POST - S.E. - 52.26' | (B-13) 3/4" PIPE
P.K. NAIL IN 10" WILD CHERRY - NORTH - 8.37'
P.K. NAIL IN FENCE POST - SOUTH - 3.97'
1/2" PIPE - EAST - 22.05' (NORTH 1/4 CORNER SECTION 6 RAY TOWNSHIP) |
| (B-12) T-IRON
P.K. NAIL IN 30" STUMP - N.N.W. - 43.48'
P.K. NAIL IN 18" MAPLE - W.N.W. - 73.15'
P.K. NAIL IN 36" OAK - S.W. - 52.90' | |

SIGNED BY *Herbert J. Kobs* DATE JULY 20, 1979
 SURVEYOR'S MICHIGAN REGISTRATION NO. 14097 (SEAL)

FOR STATE AND UNITED STATES AGENCIES:
 SIGNED BY _____ DATE _____
CHIEF OF SURVEY PARTY
 APPROVED AND SIGNED BY _____ DATE _____
MICHIGAN REGISTERED LAND SURVEYOR

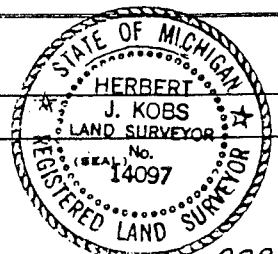

SURVEYOR'S MICHIGAN REGISTRATION NO. _____

3.