

LAND CORNER RECORDATION CERTIFICATE
Filing Requirement of Act 74, Mich. P.A. 1970

For corners in

<u>Macomb</u> (County)	Located In: <u>Bruce Township</u>	Corner Code # <u>B-5</u>
1. Public Land Survey	T <u>5N</u> R <u>12E</u>	<u>B-5</u>
	T _____ R _____	_____
	T _____ R _____	_____
	T _____ R _____	_____
2. Property Controlling in Section	S _____ T _____ R _____	_____
	S _____ T _____ R _____	_____
3. Miscellaneous Property in Sec.	S _____ T _____ R _____	_____
	S _____ T _____ R _____	_____
4. Lot No. _____, Recorded Plat _____		
5. Private Claims _____		

3262632
LIBER 14175 PAGE 353
09/05/2003 02:51:12 P.M.
MACOMB COUNTY, MI SEAL
CARMELLA SABAUGH, REGISTER OF DEEDS

Register of Deeds Stamp & File Number

	A	B	C	D	E	F	G	H	I	J	K	L	M
1													
2	6	5	4	3	2	1							
3													
4	7	8	9	10	11	12							
5	●												
6	18	17	16	15	14	13							
7													
8	19	20	21	22	23	24							
9													
10	30	29	28	27	26	25							
11													
12	31	32	33	34	35	36							
13													

I, Huston K. Kennedy, in a field survey on July 07, 2003 do hereby state that under requirements of P.A. 74, Michigan P.A. of 1970, the corner points mentioned in lines 1 and 2 above were in conformance with regulations and rules therefore as required in the current manual of survey instructions of the United States Department of the Interior, Bureau of Land Management or by a decree of a Court of Law and/or that the corner points mentioned in lines 3, 4 and 5 above were in conformance with the rules of the Michigan Board of Land Surveyors or by a Decree of a Court of Law, established, re-established, monumented, recovered, found as expressed below:

NOTE: Not more than 2 corners, all in the same town and range, may be recorded on this certificate.

- A. Description of original monument and accessories and/or subsequent restoration:
1817-GLO Wampier, D.S.; Set post 8" White Oak N27°W 1.68 chains; 18" White Oak N84°E 2.16 chains
1) 1981-Avey, PS #15395; LCRC L.3362, pg. 852 - Fnd a 1/2" Bar
2) 1987-King, PS #30085; LCRC L. 4151, pg. 121 - Fnd a 1/2" Iron
3) 1995-Wright, PS #40165; Unrecorded survey - Fnd a 1/2" Bar

B. Description of corner evidence found and/or method applied in restoring or reestablishing corner:
2003-Kennedy Surveying, Inc. - Kennedy, PS #17623 - Fnd a 1/2" Iron Rod which falls in the existing center line of 36 Mile Road extending to the East & West, which has a gravel surface, also an old fence, tree and rock row extending to the North, also is approximately 156 feet East of the center line of a small bridge. The corner as found is within 0.4 feet of being on line between A-5 and C-5. There is no line of occupation to the South, Ford Motor Company Proving Ground.

Witnesses from LCRC #1, #2 & Unrecorded survey #3 was used to recover and verify the location of the found 1/2" Iron Rod.

I accepted the found 1/2" Iron Rod as the best evidence of the corner position as being perpetuated.

Field Measurements Between Corners

B-5 to A-5
GLO = 40.04 chains or 2642.64 Ft.
S85°43'06" W 2636.84 Ft. (m)

B-5 to B-4
No GLO
Unrecorded survey by Jeffrey A. Wright, PS #40165 dated 2/5/95 = 2642.21 Ft.
N02°28'16" W 2642.21 Ft. (m)

B-5 to C-5
GLO = 40 chains or 2640.00 Ft.
Unrecorded survey by Jeffrey A. Wright, PS #40165 dated 2/5/95 = 2638.16 Ft.
N85°46'01" E 2639.26 Ft. (m)

C. Description of monument for corner and accessories established to perpetuate locating the position of the corner:
B-5 I replaced the found 1/2" Iron Rod with a 3/4" x 24" Iron Rod w/2" diameter aluminum cap stamped "Macomb County Monument, MI Act #345, PS #17623"
N88°E 233.30' Set Mag Nail w/Remon Washer S face 16" Ash
N35°W 49.55' Set Mag Nail w/Remon Washer SW face 42" Oak
S05°W 34.25' N face on a round metal Fence Post
N81°W 145.91' cut "X" on top of support bracket for tube railing on East end of bridge abutment
S85°W 146.06' cut "X" on top of support bracket for tube railing on East end of bridge abutment

The selected location is accepted by me and is generally accepted by Professional Surveyors as the best available evidence of the corner position as being perpetuated.

Signed by: [Signature] Date August 28, 2003
Surveyor's Michigan License No.: 17623



FORM APPROVED BY MICHIGAN STATE BOARD OF PROFESSIONAL SURVEYORS, JAN. 26, 1971

ACCEPTED BY THE MACOMB COUNTY SURVEY PEER GROUP AS THE OFFICIAL CORNER UNDER MICHIGAN PUBLIC ACT 345 OF 1990 AT A MEETING HELD ON 8/26/03
[Signature]
MARTIN C. QUINN, CHAIRMAN

REVISED MAY 14, 1975
REVISED JAN., 1982
REVISED OCT., 1995

2003

**MACOMB COUNTY REMONUMENTATION
PROGRAM FOR BRUCE TOWNSHIP**

Research Dossier for B-5

Prepared by:
Kennedy Surveying, Inc.
105 North Washington Street
Oxford, Michigan 48371
03-5656 (96-4013)

Sources of Information Researched For Macomb County 2003 Remonumentation Program For Bruce Township

- 1) GLO Notes
- 2) Act 74 Recorded LCRC
- 3) Act 132 Recorded Surveys
- 4) Personal History and Records
- 5) LCRC's and Surveys
- 6) Letters to the Following, Requesting Unrecorded information

- a) AES Engineers & Surveyors, Inc.
- b) Anderson, Eckstein & Westrick
- c) BMJ Engineers & Surveyors
- d) Bruen Land Surveying
- e) David Little Land Surveyor
- f) Dunn Construction
- g) Fenn & Associates Surveying, Inc.
- h) George F. Dely Co,
- i) George Jerome & Company
- j) Kem-Tec Surveying
- k) King Surveying & Associates, Inc.
- l) Lansky Land Surveyor
- m) Lehner Associates, Inc.
- n) M.C.S. Associates, Inc.
- o) Metco Land Sea Corp.,
- p) Metco-Dunn, Inc.
- q) Michalich & Associates
- r) Milletics & Associates
- s) R.J. Donnelly & Associates, Inc.
- t) RA. Duthler Land Surveyor LLC
- u) Reichert Surveying
- v) Road Commission for Macomb County
- w) Rowe Corporation
- x) Spalding, DeDecker & Associates
- y) Urban Land Consultants, L.L.C.
- z) Williams & Gorinac Associates
- aa) St. Clair County Road Commission

GLO NOTES

Bruce Township was originally surveyed by Joseph Wampler, D.S. in 1817. The township was subdivided into sections with closing corners set on the North & West township lines. A post was set at the South ¼ corner of Section 7, and the North ¼ of corner of Section 18.

WITNESSES: (Based upon Government Survey Records)

8" White Oak	N27°W	1.68 Chains
18" White Oak	N84°E	2.16 Chains

EXISTING CONDITIONS

The original government post has been obliterated and the witness trees have been destroyed. The corner has been perpetuated with a ½" Iron Rod which falls in the existing center line of 36 Mile Road extending to the East & West, which has a gravel surface, also an old fence, tree and rock row extending to the North, also is approximately 156 feet East of the center line of a small bridge. The corner as found is within 0.4 feet of being on line between A-5 and C-5. There is no line of occupation to the South, Ford Motor Company Proving Ground.

LCRC AND RECORDED SURVEYS

Researching the Macomb County Records for Land Corner Recordation Certificates (LCRC) shows that Herbert G. Avey, PS #15396 recorded a LCRC on September 8, 1981 and found a ½" Bar.

WITNESSES: (Based upon LCRC recorded in Liber 3362, page 852 of Macomb County Records)

- *144.70 Ft. SW to "+" in conc. base on NE corner of South bridge rail (145.65 Ft. m)
- *144.64 Ft. NW to "+" in conc. base on SE corner of North bridge rail (145.25 Ft. m)
- *34.21 Ft. South to North face of a circular metal 6' cyclone fence post 1" ± above ground

Donald H. King, PS #30085 recorded a LCRC on March 18, 1987 in Liber 4151, page 121 of Macomb County Records. He found a ½" Iron.

WITNESSES:

- *PK Nail in 3" tree – NW – 49.42 Ft. (12" Ash 49.30 Ft. m)
- *PK Nail in 4" tree – NNW – 40.18 Ft.
- *North face of 3" steel fence post – South – 34.12 Ft.
- *C/L South bolt East end of South rail over bridge – WSW – 145.94 Ft. (145.85 Ft. m)

UNRECORDED SURVEYS AND WITNESSES

Jeffrey A. Wright, PS #40165 did a survey on February 8, 1995 and found a ½" Bar.

WITNESSES:

- *49.41 Ft. NW to PK Nail NE side 4" Ash (12" Ash 49.30 Ft. m)
- *40.18 Ft. NNW to PK Nail NE side 4" Ash
- *37.03 Ft. North to ½" ? #30085
- *34.25 Ft. South to North side 3" Steel Fence Post

FIELD MEASUREMENTS BETWEEN

B-5 to A-5

GLO = 40.04 chains or 2642.64 Ft.
S85°43'06" W 2636.84 Ft. (m)

B-5 to B-4

No GLO
Unrecorded survey by Jeffrey A. Wright, PS #40165 dated 2/5/95 = 2642.07 Ft.
N02°28'16" W 2642.21 Ft. (m)

B-5 to C-5

GLO = 40 chains or 2640.00 Ft.
Unrecorded survey by Jeffrey A. Wright, PS #40165 dated 2/5/95 = 2638.16 Ft.
N85°46'01" E 2639.26 Ft. (m)

The witnesses for the above mentioned Land Corner Recordation Certificate and unrecorded Certificate of Survey were used to verify the location of the found ½" Iron Rod as of July 3, 2003. I therefore, recommend to the Macomb County Peer Group that they accept the ½" Iron Rod as found as the best evidence of the original corner position as being perpetuated.

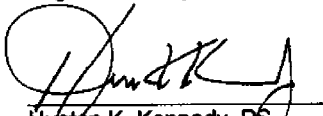
Huston K. Kennedy, PS
Kennedy Surveying, Inc.

*Used to verify the location of the found corner (B-5)

Town 5 North Range 12 East

77.82	B.O. 18 in In.
80.00	Set post cor S 7. R. 17. 18 13.0 17 S 88 46 Ck 8 N 51 W 22 Incomfy + billy burnt tim. land
East	On R.L. betw S 8 + 17
3.00	Ent ^d roof
7.00	Left Do.
40.00	Set tim 12 mi. post
50.16	Int ^d N 4 S. line at post
West	to betw S. 8 + 17
7.08	W.O. 30 in In
40.23	marked tim 12 mi. post to cor D. Sacafra 2 1/2 in In N 87 W 22 No other
West	Between S. 7 + 18
3.00	Ent ^d Marsh
9.00	Left Do.
34.70	W.O. 16 in In
40.00	Set 12 mile post B-5 W.O. 8 N 27 W 168 Do 18 N 74 S 216
42.50	Creek 36 lbs South
58.50	Ent ^d Pine + Cedar roof.
62.50	Left Do.
72.00	Ent ^d roof.
79.00	Left roof.
80.04	Ent ^d R.L. 42 lbs S where set post Elev 85512 S 33 W.O. 14 N 7 1/2 S 125 Poor burnt timber land

LAND CORNER RECORDATION CERTIFICATE
FILING REQUIREMENT OF ACT 74, MICH. P.A. 1970

LIBER **3352** PAGE **852**

FOR CORNERS OF:-	Bruce Township LOCATED IN:- Sec. 7	CORNER CODE NUMBER
1. PUBLIC LAND SURVEY _____ T. <u>5</u> N. R. <u>12</u> E. _____		<u>A-5, B-3, B-5</u>
2. PROPERTY CONTROLLING IN SECTION _____ T. _____ N. S. R. _____ E. _____		
3. MISCELLANEOUS PROPERTY IN SECTION _____ T. _____ N. S. R. _____ E. _____		
4. LOT NO. _____, RECORDED PLAT _____		
5. PRIVATE CLAIMS _____		

A720659
 RECORDED IN MACOMB COUNTY
 RECORDS AT: 1:30 P.M.
 SEP-8 1981
Edna M. Hill
 CLERK - REGISTER OF DEEDS
 MACOMB COUNTY, MICHIGAN
 REGISTER OF DEEDS STAMP AND
 FILING NUMBER

I, Herbert G. Avey, do hereby certify that under requirements of P.A. 74, Michigan P.A. of 1970, the corner points mentioned in lines 1 and 2 above were, in a field survey on April 28, 1980, established, re-established, monumented, re-monumented, recovered or restored as expressed below and in conformance with regulations and rules therefore as required in the current manual of survey instructions of the United States Department of the Interior, Bureau of Land Management or by a decree of a court of law. Furthermore, that the corner points mentioned in lines 3, 4 and 5 above were, in a field survey on _____, 19____, found, recovered, restored, established or re-established as expressed below and in conformance with the rules of the Michigan State Board of Registration for Land Surveyors or, by a Decree of a Court of law:

A. Description of original monument and accessories and/or subsequent restoration:

B. Description of corner evidence found and/or method applied in restoring or re-establishing corner:

- A-5 Found 3/4" pipe
- B-3 Set 1/2" bar at intersection of N-S 1/2 line of Section 7 and north line of Section 7.
- B-5 Found 1/2" bar

C. Description of monument for corner and accessories established to perpetuate locating the position of the corner:

- A-5 48.87' N.N.W. to P.K. nail in west face twin 8" wild cherry.
51.73' N.W. to P.K. nail in south face twin 18" oak.
55.37' S.E. to N.W. face steel corner cyclone fence post at top cross rail.
- B-3 22.85' S.W. to P.K. nail in N.E. root 12" oak.
8.17' West to P.K. nail in north face 12" oak.
18.11' N.E. to P.K. nail in S.E. face 12" oak.
- B-5 144.70' S.W. to "+" in conc. base on N.E. corner of south bridge rail.
144.64' N.W. to "+" in conc. base on S.E. corner of north bridge rail.
34.21' south to north face of a circular metal 6' cyclone fence post, 1' ± above ground.

SIGNED BY Herbert G. Avey DATE February 20, 1981

SURVEYOR'S MICHIGAN REGISTRATION NO. #15396

FOR STATE AND UNITED STATES AGENCIES:

SIGNED BY _____ DATE _____

APPROVED AND SIGNED BY _____ DATE _____



SURVEYOR'S MICHIGAN REGISTRATION NO. _____

FORM APPROVED BY MICHIGAN STATE BOARD OF REGISTRATION, JAN. 28, 1971
 REVISED MAY 14, 1978

MAY PLACE SKETCH ON BACK OR ATTACHED SHEET

LAND CORNER RECORDATION CERTIFICATE
 FILING REQUIREMENT OF ACT 74, MICH. P.A. 1970

FOR CORNERS OF--	LOCATED IN--	CORNER CODE NUMBER
1. PUBLIC LAND SURVEY _____ T. <u>5</u> N. R. <u>12</u> E. <u>W</u>		(B-4), (B-5)
2. PROPERTY CONTROLLING IN SECTION <u>7</u> T. <u>5</u> N. R. <u>12</u> E. <u>W</u>		<u>George Township</u>
3. MISCELLANEOUS PROPERTY IN SECTION _____ T. _____ N. R. _____ E. _____ W.		
4. LOT NO. _____, RECORDED PLAT _____		
5. PRIVATE CLAIMS _____		

REGISTER OF DEEDS STAMP AND FILING NUMBER

I, Donald H. King, do hereby certify that under requirements of P.A. 74, Michigan P.A. of 1970, the corner points mentioned in lines 1 and 2 above were, in a field survey on May 27 1986, established, re-established, monumented, re-monumented, recovered or restored as expressed below and in conformance with regulations and rules therefore as required in the current manual of survey instructions of the United States Department of the Interior, Bureau of Land Management or by a decree of a court of law. Furthermore, that the corner points mentioned in lines 3, 4 and 5 above were, in a field survey on _____, 19____, found, recovered, restored, established or re-established as expressed below and in conformance with the rules of the Michigan State Board of Registration for Land Surveyors or, by a Decree of a Court of law:

A. Description of original monument and accessories and/or subsequent restoration: **RECORDED IN MACOMB COUNTY RECORDS AT: 12:33 P.M.**

MAR 18 1987
Edna Hall
 CLERK - REGISTER OF DEEDS
 MACOMB COUNTY, MICHIGAN

B. Description of corner evidence found and/or method applied in restoring or re-establishing corner:

- (B-4) Found 1/2" iron.
- (B-5) Found 1/2" iron.

C. Description of monument for corner and accessories established to perpetuate locating the position of the corner:

- | | |
|--|--|
| (B-4) 1/2" iron.

P.K. nail in 24" wild cherry-S.S.W.-10.32'
P.K. nail in 18" maple-S.W.-19.06'
P.K. nail in 10" ash-N.W.-11.50'
P.K. nail in 5" elm-North-20.80' | (B-5) 1/2" iron.

P.K. nail in 3" tree-N.W.-49.42'
P.K. nail in 4" tree-N.N.W.-40.18'
North Face of 3" steel fence post-South-34.12'
C/L south bolt east end of south rail over bridge-W.S.W.-145.94' |
|--|--|

SIGNED BY Donald H. King DATE December 2, 1986
 SURVEYOR'S MICHIGAN REGISTRATION NO. 30085
 FOR STATE AND UNITED STATES AGENCIES:
 SIGNED BY _____ DATE _____
 APPROVED AND SIGNED BY _____ DATE _____
 SURVEYOR'S MICHIGAN REGISTRATION NO. _____

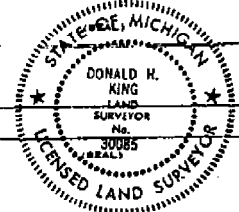

King!

Property Description

A parcel of land which is the East 1/2 of Section 7 and part of the N.W. 1/4 of Section 8, T.5N., R.12E., Bruce Township, Mecomb County, Michigan, described as: Beginning at the S.E. corner Section 7 (which is coincident with the S.W. corner Section 8); thence S.89°07'24"W., 2638.16 feet along the south line of Section 7 and the centerline of 36 Mile Road to the South 1/4 corner Section 7; thence N.00°07'07"W., 2642.07 feet along the N-S 1/4 line Section 7 to the Center Post of Section 7; thence continuing along said line N.00°31'23"W., 2348.93 feet to the North 1/4 corner Section 7; thence S.89°43'04"E., 2626.31 feet along the North line Section 7 to the N.E. corner Section 7 (which is coincident with the N.W. corner Section 8); thence N.89°52'50"E. (N.89°46'52"E. record), 1392.77 feet to a point which is the intersection of the centerline of 37 Mile Road and the centerline of Fisher Road; thence S.00°23'45"E. (S.00°23'40"E. record) 623.56 feet (626.24 feet record) east along the centerline of Fisher Road; thence S.89°46'12"W. (S.89°46'52"W. record), 1389.01 feet to a point on the East line Section 7 (which is coincident with the West line of Section 8); thence S.00°43'02"E., 1827.87 feet to the East 1/4 corner of Section 7 (which is coincident with the West 1/4 corner Section 8); thence continuing along said line S.00°11'03"E., 2637.64 feet to the Point of Beginning, Containing 330.719 acres. Subject to the rights of the public along the South line for 36 Mile Road and the East line for Fisher Road and to all other easements of record.

WITNESSES:

CENTER POST SECTION 7 T.5N., R.12E.
F. 1/2
10-10' 00" TO S. 1/4 N. 1/4 CORNER 20' 1/2
10-10' 00" TO S. 1/4 N. 1/4 CORNER 11' 1/2
10-10' 00" TO S. 1/4 N. 1/4 CORNER 11' 1/2
10-10' 00" TO S. 1/4 N. 1/4 CORNER 20' 1/2

S.W. CORNER SECTION 7 T.5N., R.12E.
F. 1/2
10-10' 00" TO S. 1/4 N. 1/4 CORNER 20' 1/2
10-10' 00" TO S. 1/4 N. 1/4 CORNER 11' 1/2
10-10' 00" TO S. 1/4 N. 1/4 CORNER 11' 1/2
10-10' 00" TO S. 1/4 N. 1/4 CORNER 20' 1/2

N.W. CORNER SECTION 7 T.5N., R.12E.
F. 1/2
10-10' 00" TO S. 1/4 N. 1/4 CORNER 20' 1/2
10-10' 00" TO S. 1/4 N. 1/4 CORNER 11' 1/2
10-10' 00" TO S. 1/4 N. 1/4 CORNER 11' 1/2
10-10' 00" TO S. 1/4 N. 1/4 CORNER 20' 1/2

N.E. CORNER SECTION 7 T.5N., R.12E.
F. 1/2
10-10' 00" TO S. 1/4 N. 1/4 CORNER 20' 1/2
10-10' 00" TO S. 1/4 N. 1/4 CORNER 11' 1/2
10-10' 00" TO S. 1/4 N. 1/4 CORNER 11' 1/2
10-10' 00" TO S. 1/4 N. 1/4 CORNER 20' 1/2

E.W. CORNER SECTION 7 T.5N., R.12E.
F. 1/2
10-10' 00" TO S. 1/4 N. 1/4 CORNER 20' 1/2
10-10' 00" TO S. 1/4 N. 1/4 CORNER 11' 1/2
10-10' 00" TO S. 1/4 N. 1/4 CORNER 11' 1/2
10-10' 00" TO S. 1/4 N. 1/4 CORNER 20' 1/2

S.E. CORNER SECTION 7 T.5N., R.12E.
F. 1/2
10-10' 00" TO S. 1/4 N. 1/4 CORNER 20' 1/2
10-10' 00" TO S. 1/4 N. 1/4 CORNER 11' 1/2
10-10' 00" TO S. 1/4 N. 1/4 CORNER 11' 1/2
10-10' 00" TO S. 1/4 N. 1/4 CORNER 20' 1/2

N.E. CORNER SECTION 8 T.5N., R.12E.
F. 1/2
10-10' 00" TO S. 1/4 N. 1/4 CORNER 20' 1/2
10-10' 00" TO S. 1/4 N. 1/4 CORNER 11' 1/2
10-10' 00" TO S. 1/4 N. 1/4 CORNER 11' 1/2
10-10' 00" TO S. 1/4 N. 1/4 CORNER 20' 1/2

12 JUNE 1995

REVISED 6-9-95

URBAN LAND CONSULTANTS logo and contact information. Legend: P10 - Poured Iron Bar, P12 - Poured Iron Pipe, S10 - Set Iron Bar/Cop, S12 - Set Iron Pipe, M - Measured Distance, C - Calculated. Jeffrey A. Wight, Licensed Land Surveyor No. 40145. Date: 06/06/95. Job No. 95045-100.

W. 1/4 POST

GEN. POST
B-4

E. 1/4 POST

DEQUINDRE RD.

S.W. COR.
3/8 MILE

RD.

SECOR

1-7 E

300

-007
70.00

-001
100.00

400

A-S

B-S

C-S

BRUCE TWP SECS. 6 & 7 T5N R12E

Rel. 6-02
MADISON COUNTY, IL
Scale
= 400'

Photography: March 2000
0 400 800 Feet

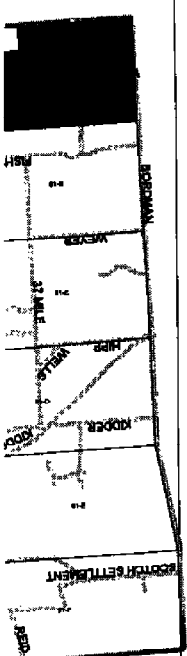
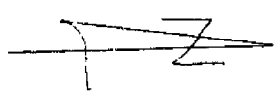

DESCRIPTION OF PERMANENT REAL ESTATE INDEX NUMBERS

AREA NUMBER	13
THE AREA NUMBER	19
BLANK NUMBER	302
PAVED NUMBER	018

SEC