



*NOT
Anything*



A-4 IRA EAST



A-4 IRA SOUTH

223-819
6-9-98
RHS, UG, PA4

ICA
A-4

T. 3N, R. 15E

Found 1/2" iron in Mon. Box Corner
County Line 0.5' DEEP.

12° 118.37' N/AIC w/ THIS #123 W/
M/ FACE UP

170° 29.93' 1/2" iron in Mon. Box
M-4 CHESTER FIELD TWP.

145° 98.00' 355 REMAIN THIS ABOVE
FO. PK. N/AIC M/ M/ FACE UP

245° 44.05' FO 44" X 8" E. 8m
STAIN M. P.

325° 100.75' S.E. CORNER LINE.
HENNING

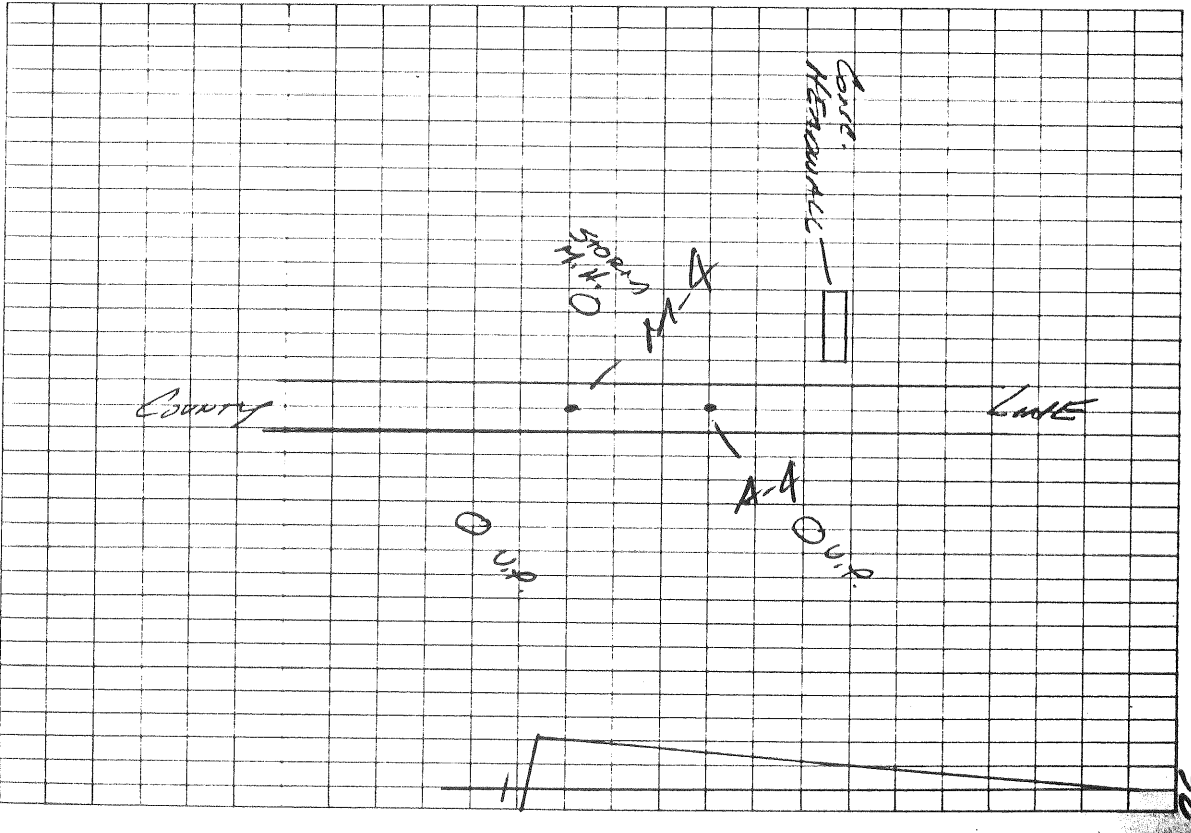

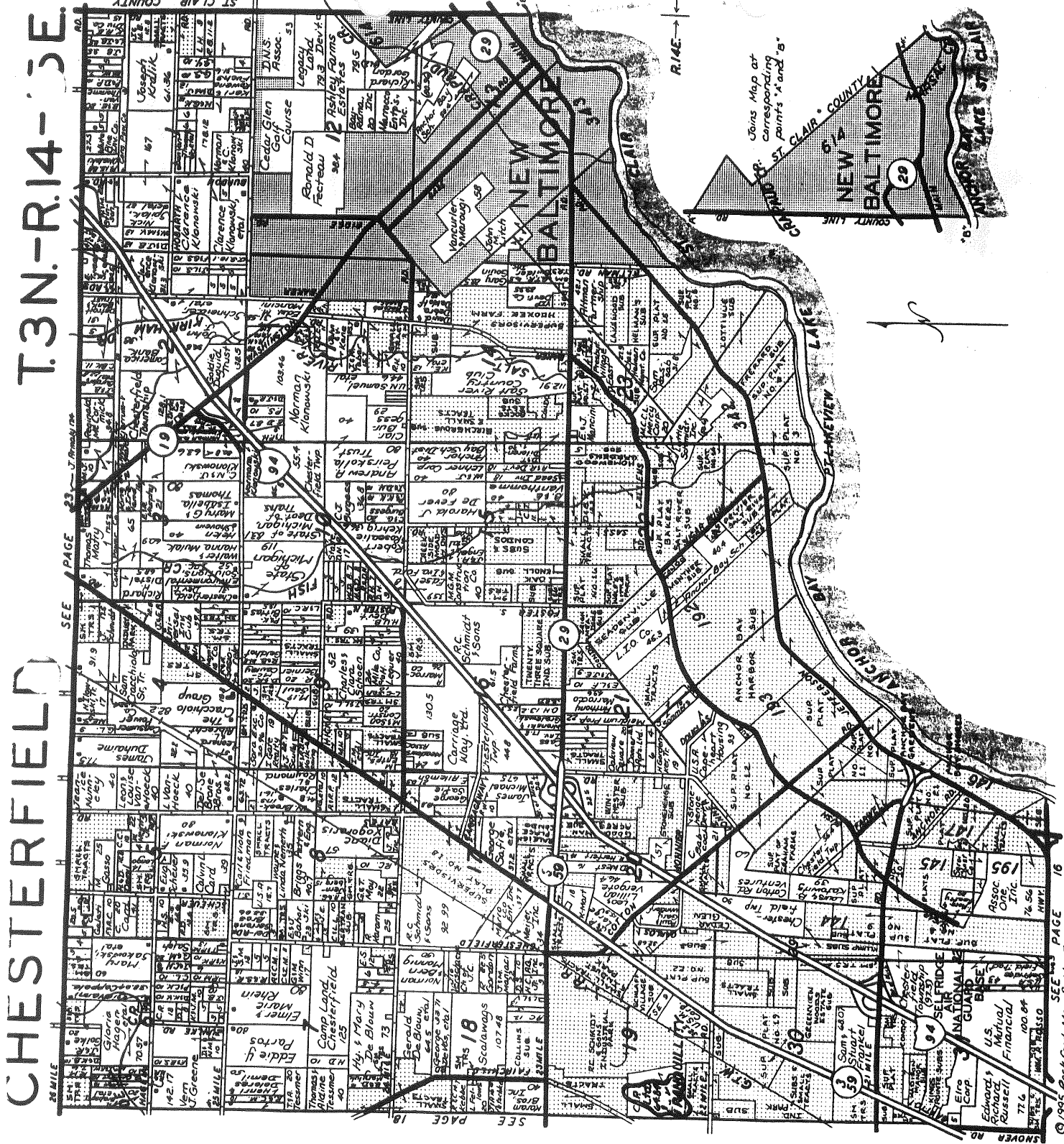

Citizens State Bank

NEW BALTIMORE, MICHIGAN

Serving The Anchor Bay Area For Over 70 Years

725-2291

MAIN OFFICE
51066 Washington Street

CHESTERFIELD BRANCHES
32900 Twenty-Three Mile Road
47011 Sugarbush at 21 Mile

ANCHORVILLE
9764 Dixie Highway

SHELBY TOWNSHIP
48945 Haves Road at 22 Mile
(810) 412-9500

Reproduced with permission of Rockford Map Publishers, Inc.
Rockford, Illinois

LAND CORNER RECORDATION
FOR ST. CLAIR COUNTY

IRA TWP.

CODE - A4

	LOCATED IN:		CORNER CODE #:
PRIVATE LAND SURVEY	T 3N.	R 15E.	A4 IRA TWP.
	T	R	W. 1/4 COR. SEC. 7
CONTROLLINGS IN SECTION 5	T	R	
	T	R	
MISC. S	T	R	
PROPERTY S	T	R	

LOT NO. -
PRIVATE CLAIMS -

RECORDED PLAT -

SURVEYED BY:

DATE:
DATE ENTERED: 01/22/93

DESC. OF ORIGINAL MONUMENT & ACCESSORIES &/OR SUBSEQUENT RESTORATION:

ORIG. GOV'T. COR. - POST	
N. 40.00 CHAINS TO SEC. COR. A3	S. 4.35 CHAINS TO P.C.614
COUNTY TIES - IRON PIPE (5-13-27) A.D.#449	E. 35.37' TO SP. IN 8" CHERRY
S.W. 87.6' TO SP. IN 18" MAPLE	W. 32.05' TO SP. IN FC. POST
N.W. 57.7' TO SP. IN 12" APPLE	

DESC. OF CORNER EVIDENCE FOUND &/OR METHOD APPLIED IN RESTORING CORNER:

COUNTY TIES - IRON PIPE (5-13-27) A.D.#449 SEE ABOVE

DESC. OF MONUMENT FOR CORNER & ACCESS. ESTABLISHED TO LOCATE CORNER:

ST. CLAIR COUNTY
A-4 IRA

SCCRC

NORTH LINE P.C. 614

(A)

LAND CORNER RECORDATION CERTIFICATE
Filing Requirement of Act 74, Mich. P.A. 1970

For corners in

MACOMB

(County)

Located In:
NEW BALTIMORE

Corner Code #

M-4

1. Public Land Survey

T 3N R 12E

T _____ R _____

T _____ R _____

T _____ R _____

2. Property Controlling in Section

S _____ T _____ R _____

S _____ T _____ R _____

3. Miscellaneous Property in Sec.

S _____ T _____ R _____

S _____ T _____ R _____

4. Lot No. _____, Recorded Plat _____

5. Private Claims _____

Register of Deeds Stamp & File Number

	A	B	C	D	E	F	G	H	I	J	K	L	M
2	6	5	4	3	2	1							
3													
4	7	8	9	10	11	12							
5													
6	18	17	16	15	14	13							
7													
8	18	20	21	22	23	24							
9													
10	30	29	28	27	26	25							
11													
12	31	32	33	34	35	36							
13													

I, MARTIN C. DUNN, in a field survey on DECEMBER 1, 19 95, do hereby certify that under requirements of P.A. 74, Michigan P.A. of 1970, the corner points mentioned in lines 1 and 2 above were in conformance with regulations and rules therefore as required in the current manual of survey instructions of the United States Department of the Interior, Bureau of Land Management or by a decree of a Court of Law and/or that the corner points mentioned in lines 3, 4 and 5 above were in conformance with the rules of the Michigan Board of Land Surveyors or by a Decree of a Court of Law; established, re-established, monumented, re-monumented, recovered, found as expressed below:

NOTE: Not more than 4 corners, all in the same town and range, may be recorded on this certificate.

A. Description of original monument and accessories and/or subsequent restoration:

GLO POST - NO EVIDENCE OF ORIGINAL CORNER FOUND

FOUND AXLE SHAFT IN MONUMENT BOX

C0288452 LIBER:06853 PAGE:216 11:03A 12/14/1995
 CARMELLA SABAUGH-MACOMB COUNTY, MI REG/DEEDS

B. Description of corner evidence found and/or method applied in restoring or reestablishing corner:

M-4 T.3N., R.14E.

FOUND AXLE SHAFT IN MONUMENT BOX

FIELD MEASUREMENTS AND RECORDED DISTANCES

M-4 TO L-4 4985.86' (M.)
 M-4 TO M-3 2665.33' (M.)



C. Description of monument for corner and accessories established to perpetuate locating the position of the corner:

M-4 T.3N., R.14E. AXLE SHAFT IN MONUMENT BOX

WITNESSES

N16°E	147.65'	FOUND REGULAR NAIL W/TAG "RLS 123" IN WEST FACE OF UTILITY POLE
S22°E	70.00'	SET PK NAIL IN WEST FACE OF UTILITY POLE
N87°W	37.30'	FD. NAIL W/TAG "RLS 123" IN SOUTH FACE OF ABANDONED UTILITY POLE
N43°E	62.00'	SET PK NAIL IN EAST FACE OF TRIPLE STEM MAPLE
NORTH	29.92'	FOUND IRON ROD IN MONUMENT BOX

THE SELECTED LOCATION IS FOR THIS PROPERTY CONTROLLING MONUMENT IS ACCEPTED AS A CAREFUL AND FAITHFUL DETERMINATION OF THE POSITION INDICATED.

Signed by Martin C. Dunn

Date 12/12/95

Surveyor's Michigan License No. 30081

B