

LAND CORNER RECORDATION CERTIFICATE
Filing Requirement of Act 74, Michigan P.A. 1970

For corners in

CHESTERFIELD TOWNSHIP
 Located In: Corner Code #

MACOMB
 (County)

- | | | |
|------------------------------------|--------------------------|------------|
| 1. Public Land Survey | T <u>3N</u> R <u>14E</u> | <u>H-2</u> |
| | T _____ R _____ | _____ |
| | T _____ R _____ | _____ |
| | T _____ R _____ | _____ |
| 2. Property Controlling in Section | S _____ T _____ R _____ | _____ |
| | S _____ T _____ R _____ | _____ |
| 3. Miscellaneous Property in Sec. | S _____ T _____ R _____ | _____ |
| | S _____ T _____ R _____ | _____ |

4. Lot No. _____, Recorded Plat _____
 5. Private Claims _____

ACCEPTED BY THE MACOMB COUNTY SURVEY PERMITS BOARD AS THE OFFICIAL CORNER UNDER MICHIGAN ACT 345 OF 1990 AT A MEETING HELD ON OCTOBER 11, 2001
 William E. Eckerberg, P.S., CHAIRMAN

1246429
 LIBER 11091 PAGE 351
 12/13/2001 10:50:00 A.M.
 MACOMB COUNTY, MI
 CARMELLA SABAUGH, REGISTER OF DEEDS

Register of Deeds Stamp & File Number

I, ROBERT H. BIRKETT, in a field survey on JULY 11, 2001 do hereby certify that under requirements of P.A. 74, Michigan P.A. of 1970, the corner points mentioned in lines 1 and 2 above were in conformance with regulations and rules therefore as required in the current manual of survey instructions of the United States Department of the Interior, Bureau of Land Management or by a decree of a Court of Law and /or that the corner points mentioned in lines 3, 4 and 5 above were in conformance with the rules of the Michigan Board of Land Surveyors or by a Decree of a Court of Law; established, re-established, monumented, re-monumented, recovered, found as expressed below:

NOTE: Not more than 2 corners, all in the same town and range, may be recorded on this certificate.

	A	B	C	D	E	F	G	H	I	J	K	L	M
1													
2	6		5		4			●		2			1
3													
4	7		8		9			10		11			12
5													
6	18		17		16			15		14			13
7													
8	19		20		21			22		23			24
9													
10	30		29		28			27		26			25
11													
12	31		32		33			34		35			36
13													

- A. Description of original monument and accessories and/or subsequent restoration:
 H-2 CORNER WAS NOT SET BY GENERAL LAND OFFICE
 (a) 1971, H. KOBBS # 14097, FOUND 1/2" IRON BAR, L.C.R.C., L. 2262, P. 636
- B. Description of corner evidence found and/or method applied in restoring or reestablishing corner:
 H-2 FOUND 1/2" IRON AT INTERSECTION FENCES NORTH - SOUTH - EAST - WEST
 WITNESS FROM (a) ABOVE WAS USED TO RECOVER THIS CORNER

FIELD MEASUREMENTS

- | | |
|---|---|
| H-2 TO H-1
NO GLO MEASUREMENT
NO PREVIOUSLY RECORDED DISTANCE
2001, REMON - 2684.05' | H-2 TO I-2
NO GLO MEASUREMENT
NO PREVIOUSLY RECORDED DISTANCE
2001, REMON - 2723.24 |
| H-2 TO H-3
NO GLO MEASUREMENT
NO PREVIOUSLY RECORDED DISTANCE
2001, REMON - 2698.06' | H-2 TO G-2
NO GLO MEASUREMENT
NO PREVIOUSLY RECORDED DISTANCE
2001, REMON - 2717.15' |



CENTER OF SECTION BY RULE

7.10' SOUTH
 23.71' EAST

- C. Description of monument for corner and accessories established to perpetuate locating the position of the corner:
 H-2 REPLACE 1/2" IRON WITH A 1/2" IRON, 36" LONG, ENCASED IN CONCRETE CAPPED WITH AN ALUMINUM CAP STAMPED "MACOMB COUNTY MONUMENT, MI ACT 345, H-2, 41094."

- | | |
|-----------------|--|
| AZ. 90° 9.87' | SET REMON TAG ABOVE FOUND FORM NAIL IN THE NORTHWEST FACE OF AN 8" ASH |
| AZ. 200° 34.38' | SET REMON TAG ABOVE FOUND SCAR IN THE NORTHWEST FACE OF AN 18" MAPLE |
| AZ. 270° 32.86' | SET REMON TAG ABOVE FOUND FORM NAIL IN THE SOUTHEAST FACE OF A 10" MAPLE |
| AZ. 355° 28.82' | SET IRON TAG ABOVE FOUND NAIL WITH WASHER IN THE WEST FACE OF A 10" ASH |

THE SELECTED LOCATION IS ACCEPTED BY ME AND IS GENERALLY ACCEPTED BY PROFESSIONAL SURVEYORS AS THE BEST AVAILABLE EVIDENCE OF THE POSITION OF THE ORIGINAL CORNER.

Signed by Robert H. Birkett Date 10-16-01
 Surveyor's Michigan License No. 41094

LAND CORNER RECORDATION CERTIFICATE

FILING REQUIREMENT OF ACT 74, MICH. P.A. 1970

LIBER **2262** PAGE **636**

A106236

FOR CORNERS OF--	LOCATED IN--	CORNER CODE NUMBER
1. PUBLIC LAND SURVEY _____	T. <u>3</u> N. <u>14</u> E. <u>X</u> S. R. W.	H-2
2. PROPERTY CONTROLLING IN SECTION _____	T. _____ N. _____ E. _____ S. R. W.	_____
3. MISCELLANEOUS PROPERTY IN SECTION _____	T. _____ N. _____ E. _____ S. R. W.	_____
4. LOT NO. _____, RECORDED PLAT _____		
5. PRIVATE CLAIMS _____		

RECORDED IN MACOMB COUNTY
RECORDS AT: **9:00 a. M**
FEB 10 1972
Edna Hill
CLERK - REGISTER OF DEEDS
MACOMB COUNTY, MICHIGAN
REGISTER OF DEEDS STAMP AND
FILING NUMBER

I, Herbert J. Kobs do hereby certify that under requirements of P.A. 74, Michigan P.A. of 1970, the corner points mentioned in lines 1 and 2 above (identified with circles on index code diagram - over) were, in a field survey on September 23, 1971, established, re-established, monumented, re-monumented, recovered or restored as expressed below and in conformance with regulations and rules therefore as required in the current manual of survey instructions of the United States Department of the Interior, Bureau of Land Management or by a decree of a court of law. Furthermore, that the corner points mentioned in lines 3, 4 and 5 above were, in a field survey on _____ 19____, found, recovered, restored, established or re-established as expressed below and in conformance with the rules of the Michigan State Board of Registration for Land Surveyors or, by a Decree of a Court of law:

A. Description of original monument and accessories and/or subsequent restoration:

B. Description of corner evidence found and/or method applied in restoring or re-establishing corner:

Found 1/2" iron bar

C. Description of monument for corner and accessories established to perpetuate locating the position of the corner:

1/2" iron bar
Nail & washer in 8" Box elder - North - 28.52 feet.
Nail & washer in Bell Telephone pole - West - 14.68 feet.
Nail & washer in 9" maple - South 20 degrees West - 34.51 feet.

SIGNED BY *Herbert J. Kobs* DATE October 22, 1971
 SURVEYOR'S MICHIGAN REGISTRATION NO. 14097

FOR STATE AND UNITED STATES AGENCIES:

SIGNED BY _____ DATE _____
CHIEF OF SURVEY PARTY
 APPROVED AND SIGNED BY _____ DATE _____
MICHIGAN REGISTERED LAND SURVEYOR

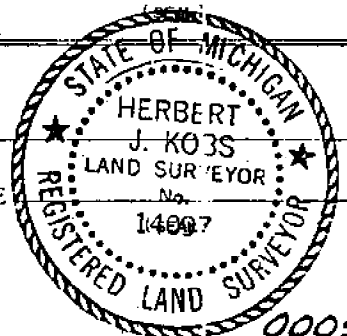

SURVEYOR'S MICHIGAN REGISTRATION NO. _____

223-021

2001 MARSH REMON

7-11-01

LMB, BMS

CHESTERFIELD

No 1937 15

H-2

FOUND 1/2" IRON @ INTERSECTION

FENCES NORTH - SOUTH - EAST - WEST

355° 28.82 SET REMON TAG ABOVE

FOUND NAIL w/ WASHER IN WEST

FACE 10" ASH

90° 9.87 SET REMON TAG ABOVE

FOUND FORM NAIL NW FACE 8" ASH

200° 34.38 SET REMON TAG ABOVE

FOUND ~~FORM~~ NAIL NW FACE

18" MAPLE

270° 32.86 SET REMON TAG ABOVE

FOUND FORM NAIL SE FACE 10" MAPLE

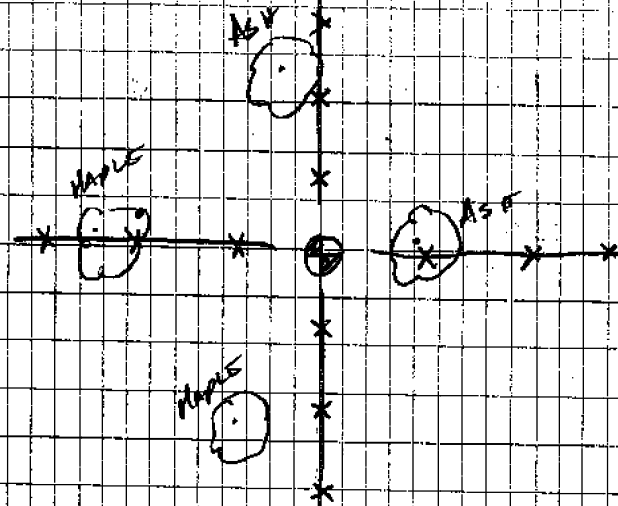

LCRC

1971, H. Kobs No. 14097, Found ½" iron, L 2262, P 636.

- North - 28.52' - Nail w/tag in 8" Box Elder.
- SSW - 34.51' - Nail w/tag in 9" Maple.
- West - 14.68' - Nail w/tag in TP.