

LIBER 06166P056

8993663

LAND CORNER RECORDATION CERTIFICATE
Filing Requirement of Act 74, Mich. P.A. 1970

RECORDED IN MACOMB COUNTY
RECORDS AT 8130 A.M.

DEC 28 1993

Register of Deeds Stamp & File Number

For corners in

MACOMB County Located In: Chesterfield Township Corner Code # C-9
1. Public Land Survey T 3N R 14E
2. Property Controlling in Section S T R
3. Miscellaneous Property in Sec. S T R
4. Lot No. Recorded Plat
5. Private Claims

Shelby W. Money in a field survey on November 18, 1993 do hereby certify that under requirements of P.A. 74, Michigan P.A. of 1970, the corner points mentioned in lines 1 and 2 above were in conformance with regulations and rules therefore as required in the current manual of survey instructions of the United States Department of the Interior, Bureau of Land Management or by a decree of a Court of Law and/or that the corner points mentioned in lines 3, 4 and 5 above were in conformance with the rules of the Michigan Board of Land Surveyors or by a Decree of a Court of Law; established, re-established, monumented, re-monumented, recovered, found as expressed below:

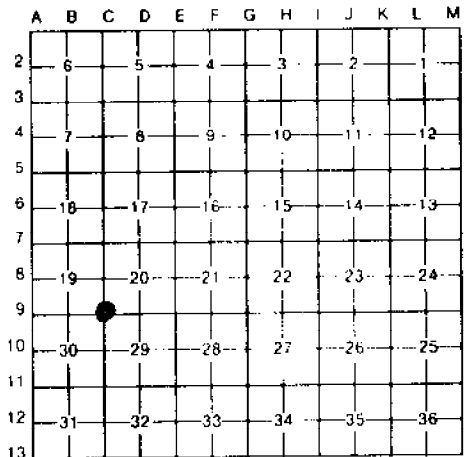

NOTE: Not more than 4 corners, all in the same town and range, may be recorded on this certificate.

A. Description of original monument and accessories and/or subsequent restoration:

LCRC (1973) L 2383 P 861 AVENDT #16034
FOUND 4" CONCRETE MONUMENT
S 15' E 58.60' PK NAIL IN 20" HICKORY TREE
WSW 38.51' PK NAIL IN 18" HICKORY TREE
NORTHEAST 20.57' PK NAIL IN 24" ASH TREE
GLO POST. NO WITNESSES REMAIN
MACOMB COUNTY ROAD COMMISSION (1959) UNRECORDED
FOUND 3/8" PIPE IN CONCRETE MONUMENT
N 58.30' W 20.55' 21" ASH TREE
S 21.30' E 69.86' 17" HICKORY TREE
S 75' W 38.46' 10" HICKORY TREE
LCRC (1988) L 4484 P 578 DUNN #30061
FOUND 3/8" PIPE IN CONCRETE
N 75' W 31.46' SET PK NORTH SIDE 12" DOGWOOD
NORTH 58.81' CENTERLINE OF STEEL FENCE POST
S 15' E 77.84' NE CORNER CONCRETE FOUNDATION
S 60' W 27.59' SE CORNER DE CONCRETE TRANS PAD

LCRC (1989) L 4662 P 736 DUNN #30081
FOUND 3/8" PIPE IN CONCRETE
N 75' W 31.46' SET PK NORTH SIDE 12" DOGWOOD
NORTH 58.81' CENTERLINE OF STEEL FENCE POST
S 15' E 77.84' NE CORNER CONCRETE FOUNDATION
S 60' W 27.59' SE CORNER DE CONCRETE TRANS PAD

B. Description of corner evidence found and/or method applied in restoring or reestablishing corner:

C-9 FOUND 4" CONCRETE MONUMENT WITH 3/4" PIPE

THIS CORNER VERIFIED BY:

CERTIFICATE OF SURVEY LIBER 2383 PAGE 860
CERTIFICATE OF SURVEY LIBER 4484 PAGE 592
CHESTERFIELD MEADOWS SUBDIVISION LIBER 74 PAGE 39
QUEEN JOSEPHINE COURTS SUBDIVISION LIBER 66 PAGES 13-14

C. Description of monument for corner and accessories established to perpetuate locating the position of the corner:

C-9 SET MACOMB COUNTY REMONUMENTATION MARKER #39002 ON FOUND 4" CONCRETE MONUMENT WITH 3/4" PIPE AND WITNESSES:
N 75° W 31.19' SET PK NAIL W/MCW TAG IN THE SOUTH FACE OF A 12" DOGWOOD TREE
SOUTH 3.80' SET CORNER OF STEEL FENCE POST
S 65° W 29.53' SET NORTHWEST CORNER OF CONCRETE OF D.E. TRANSFORMER PAD
S 15° E 77.84' SET NORTHEAST CORNER OF HOUSE #26931 CLARK STREET

ACCEPTED BY THE MACOMB COUNTY SURVEY PEER GROUP AS THE OFFICIAL CORNER UNDER MICHIGAN PUBLIC ACT 345 1990 AT A MEETING HELD ON 12-15-93
FRANK J. DODECKER, PS, PE, CHAIRMAN

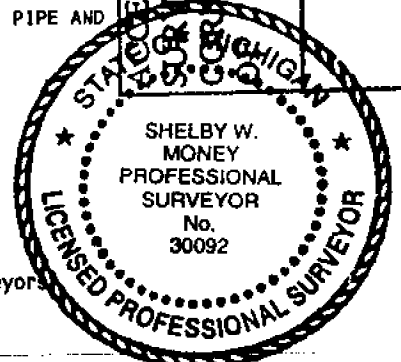

The selected location is accepted by me and is generally accepted by Professional Surveyors as the best available evidence of the position of the original corner.

Signed by Shelby W. Money Date 12/14/93
Surveyor's Michigan License No. 30092

MACOMB COUNTY REMONUMENTATION

CORNER # C-9 T 3 N - R 14 E CHESTERFIELD TOWNSHIP
COMMON DESCRIPTION N.E. CORNER SECTION 30

RECORDS RESEARCH

(refer to date, Liber & Page, source, map #, etc.)

ACT 74 RECORDED FORMS -

L.2383 P.861	Avendt 16034 (1973)	Found 4" concrete monument
L.4484 P.578	Dunn 30081 (1988)	Found 3/4" pipe concrete monument
L.4662 P.578 <u>736</u>	Dunn 30081 (1989)	Found 3/4" pipe concrete monument

ACT 132 RECORDED FORMS -

GLO NOTES -

DEEDS -

UNRECORDED INFORMATION -

ROAD COMMISSION INFORMATION -

TAX MAPS -

9-19-H 9-20E 9-29A 9-30D

MACOMB COUNTY REMONUMENTATION

CORNER # C-9 T 3 N - R 14 E CHESTERFIELD TOWNSHIP
COMMON DESCRIPTION N.E. CORNER SECTION 30

FIELD RESEARCH

{Field Book #1193 / Page 14}

SITE CONDITIONS (TYPE OF ROADWAY, FIELD, SWAMP, ETC.) -
Field

RECORDED EVIDENCE OF CORNER -
Concrete monument

Chesterfield Meadows Subdivision L.74 P.39
SW corner Queen Josephine Courts Subdivision L.66 P.3

FOUND EVIDENCE OF CORNER AND CONDITION -
4" concrete monument with 3/4" pipe

FOUND RECORDED WITNESSES -
L.2383 P.861

WSW 38.51' 18" Hickory tree / no nail

L4484. P.578 and L.4662 P.736

NW 31.46' 12" Dogwood tree / no nail
North 58.81' Centerline of steel fence post
SE 77.84' Corner of concrete foundation
SW 27.59' Southeast corner DE concrete transformer pad
(building in way)

FOUND EXISTING OCCUPATION -
Fence north / south
Subdivision monument

SET NEW WITNESSES -

N 75° W	31.19'	pk'nail w/AEW tag in south face of a 12" Dogwood tree
South	3.80'	Corner of steel fence post
S 65° W	29.53'	Northwest corner of concrete pad with DE transformer
S 15° E	77.84'	Northeast corner of house #26931 Clark Street.

MEASURED REFERENCES -
No

T. 3 E, R. 14 E, CHESTERFIELD TWP., MACOMB COUNTY SEC. 20

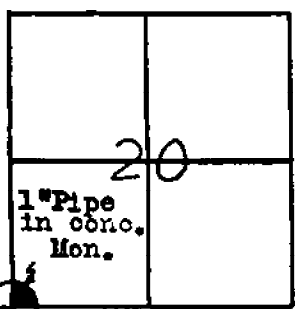

REMARKS

SW Cor. Sec. 20, common to Sec. 19, 20, 29, & 30, T3N, R14E, Chesterfield Twp., Macomb Co. Found 1" iron pipe in Conc. Monument 250' S of Kuehermeister Ave. Witnessed as shown below.

ECP Survey Chief MS Hwy Dept. October 1959

WITNESSES

- N 58° 30' E 20.55' - 21" Ash
- S 21° 30' E 69.86' - 17" Hickory
- S 79° W 38.46' - 10" Hickory

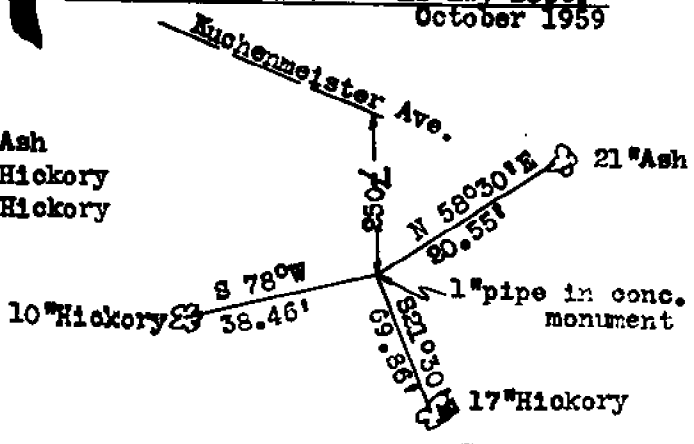

T. 3 N, R. 14 E, CHESTERFIELD TWP., MACOMB COUNTY SEC. 20

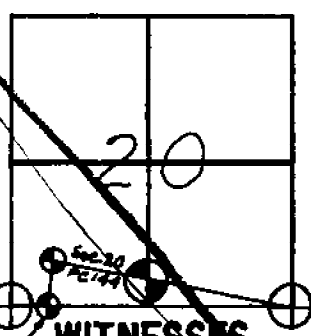

REMARKS

PC point on S. Sec. Line Sec. 20, common to Sec. 20, 29, and PC 144, T3N, R14E, Chesterfield Twp., Macomb County. Found 1" hub stake in fence line 800' east of SW Cor. Sec. 20. Witnessed it as shown below.

ECP Survey Chief MS Hwy Dept. October 1959

WITNESSES

- 1" Hub Pt. on S. Sec. Line & PC 144
- West 800' - SW Cor. Sec. 20
- N 5° W 21.51' - 42" Elm
- S 85° W 29.20' - 16" Ash
- S 70° W 21.18' - 5" Tr. Basswood

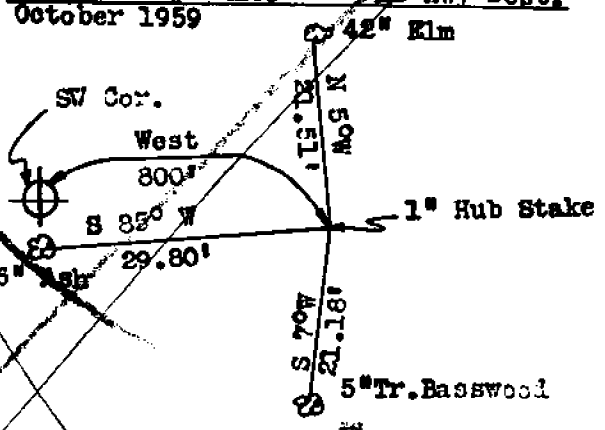

T. 3 N, R. 14 E, CHESTERFIELD TWP., MACOMB COUNTY SEC. 20

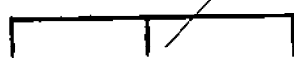

REMARKS

115 1/2

LAND CORNER RECORDATION CERTIFICATE

Filing Requirement of Act 74, Mich. P.A. 1970
Chesterfield Township

For corners in

Recorded	Located In	Corner Code
1. Public Land Survey	T 2N R 14E	C - 9
	T R	
	T R	
	T R	
2. Property Controlling in Section	S 30 T 3N R 14E	
	S T R	
3. Miscellaneous Property in Sec.	S T R	

Register of Deeds Stamp & File Number

- 4. Lot No. Recorded Plat
- 5. Private Claims

	A	B	C	D	E	F	G	H	I	J	K	L	M
2	5	5	4	3	2	1							
3													
4	7	8	9	10	11	12							
5													
6	16	17	18	15	14	13							
7													
8	19	20	21	22	23	24							
9													
10	30	29	28	27	26	25							
11													
12	31	32	33	34	35	36							

I, Martin C. Dunn, in a field survey on June 14, 19 89
do hereby certify that under requirements of P.A. 74, Michigan P.A. of 1970, the corner points mentioned in lines 1 and 2 above were in conformance with regulations and rules therefore as required in the current manual of survey instructions of the United States Department of the Interior, Bureau of Land Management or by a decree of a Court of Law and/or that the corner points mentioned in lines 3, 4 and 5 above were in conformance with the rules of the Michigan Board of Land Surveyors or by a Decree of a Court of Law, established, re-established, monumented, re-monumented, recovered, found as expressed below

NOTE: Not more than 4 corners, all in the same town and range, may be recorded on this certificate.

A. Description of original monument and accessories and/or subsequent restoration:

RECORDED IN MACOMB COUNTY
RECORDS AT: 10:01A M.

JUN 12 1989

Edna K. Hill
CLERK - REGISTER OF DEEDS
MACOMB COUNTY, MICHIGAN

B. Description of corner evidence found and/or method applied in restoring or reestablishing corner:

C - 9 NE Corner Section 30 Found 3/4" Pipe in Concrete

C. Description of monument for corner and accessories established to perpetuate locating the position of the corner:

- C - 9 NE Corner
- 1 - N 75° - 31.46, Set PK Nail in N Side of 12" Dogwood
- 2 - North - 58.81, Centerline Steel Fence Post
- 3 - S 15°E - 77.84, N.E. Corner of Concrete Foundation
- 4 - S 60°W - 27.59 S.E. Corner of D.E. Concrete Transformer Pad



Signed by Martin C. Dunn *Martin C. Dunn* Date 6/12/89
Surveyor's Michigan License No. 30081

FORM APPROVED BY MICHIGAN STATE BOARD OF LAND SURVEYORS, JUL. 25, 1977
REVISED MAY 14, 1979
REVISED JAN., 1988

01416

LAND CORNER RECORDATION CERTIFICATE

Filing Requirement of Act 74, Mich. P.A. 1970

RECORDED IN MACOMB COUNTY RECORDS AT: 10:24A

AUG 18 1988

Edna M. Hill
CLERK - REGISTER OF DEEDS
MACOMB COUNTY, MICHIGAN

Register of Deeds Stamp & File Number

Macomb	Located in	Corner Code
1. Public Land Survey	T 3N. R 14E.	C-9
	T R	
	T R	
	T R	
2. Property Controlling in Section	S 30 T 3N. R 14E.	
	S T R	
3. Miscellaneous Property in Sec	S T R	
	S T R	

- 4. Lot No. _____ Recorded Plat _____
- 5. Private Claims _____

	A	B	C	D	E	F	G	H	I	J	K	L	M
2	1	2	3	4	5	6	7	8	9	10	11	12	13
3													
4	7	8	9	10	11	12	13	14	15	16	17	18	19
5													
6	18	17	16	15	14	13	12	11	10	9	8	7	6
7													
8	19	20	21	22	23	24	25	26	27	28	29	30	31
9													
10	30	29	28	27	26	25	24	23	22	21	20	19	18
11													
12	31	32	33	34	35	36	37	38	39	40	41	42	43
13													

I, Martin C. Dunn in a field survey on June 14 1988 do hereby certify that under requirements of P.A. 74, Michigan P.A. of 1970, the corner points mentioned in lines 1 and 2 above were in conformance with regulations and rules therefore as required in the current manual of survey instructions of the United States Department of the Interior, Bureau of Land Management or by a decree of a Court of Law and/or that the corner points mentioned in lines 3, 4 and 5 above were in conformance with the rules of the Michigan Board of Land Surveyors or by a Decree of a Court of Law, established, re-established, monumented, re-monumented, recovered, found as expressed below

NOTE: Not more than 4 corners, all in the same town and range, may be recorded on this certificate.

A. Description of original monument and accessories and/or subsequent restoration:

B. Description of corner evidence found and/or method applied in restoring or reestablishing corner:

C-9 Northeast Corner, Sec. 30,
Found 3/4" pipe in concrete *1 1/2" pipe*
3/4" pipe

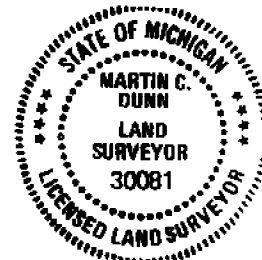

See 509
Next to fence line

C. Description of monument for corner and accessories established to perpetuate locating the position of the corner:

C-9 Northeast Corner, Sec. 30 *31.39 SW TAD*
 1. N.75°W. - 31.46, Set P.K. nail in *NS* side of 12" dogwood
 2. North - 58.81, Centerline steel fence Post.
 3. S.15°E. - 77.84, N.E. corner of *concrete foundation House # 26931 CLARK ST*
 4. S.60°W. - 27.59, S.E. corner of D.E. concrete transformer pad *3' x 11' dia 9" WPT*
568' W 29.53' NW "
SOUTH 3.8' Fence Post

Signed by Martin C. Dunn Date 6/14/88
 Surveyor's Michigan License No. 30081

LAND CORNER RECORDATION CERTIFICATE

FILING REQUIREMENT OF ACT 74, MICH. P.A. 1970

LIBER **2383** PAGE **861** CHESTERFIELD TOWNSHIP, MACOMB COUNTY **A178288**
 FOR CORNERS OF: NW 1/4 LOCATED IN: Sec. 30 CORNER CODE NUMBER
 NE 1/4

1. PUBLIC LAND SURVEY _____ F. 3 S. R. 14 C - 9

2. PROPERTY CONTROL- _____ S. R. _____
 ING IN SECTION _____

3. MISCELLANEOUS _____ S. R. _____
 PROPERTY IN SECTION _____

4. LOT NO. _____ RECORDED PLAT _____

5. PRIVATE CLAIMS _____

RECORDED IN MACOMB COUNTY
 RECORDS AT: **3:15 P.M.**
APR - 6 1973

 CLERK - REGISTER OF DEEDS
 MACOMB COUNTY, MICHIGAN
 REGISTER OF DEEDS STAMP AND
 FILING NUMBER

I, George J. Avedt, Jr., do hereby certify that under requirements of P.A. 74, Michigan P.A. of 1970 the corner points mentioned in lines 1 and 2 above identified with circles on index code diagram - over were, in a field survey on March 1973, established, re-established, monumented, re-monumented, recovered or restored as expressed below and in conformance with regulations and rules therefore as required in the current manual of survey instructions of the United States Department of the Interior, Bureau of Land Management or by a decree of a court of law. Furthermore, that the corner points mentioned in lines 3, 4 and 5 above were, in a field survey on _____ 19____, found, recovered, restored, established or re-established as expressed below and in conformance with the rules of the Michigan State Board of Registration for Land Surveyors or, by a Decree of a Court of law:

A. Description of original monument and accessories and, or subsequent restoration:

B. Description of corner evidence found and, or method applied in restoring or re-establishing corner:

C - 9 Found 4" Conc. Monument

C. Description of monument for corner and accessories established to perpetuate locating the position of the corner:

C - 9	S. 15° E.	56'.60	P.K. Nail in 20" Hickory
	W.S.W.	38'.51	P.K. Nail in 18" Hickory
	N.E.	20'.57	P.K. Nail in 24" Ash

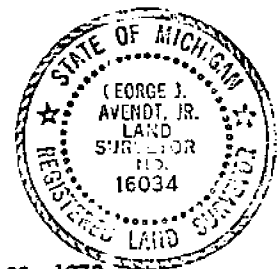

SIGNED BY George J. Avedt, Jr. DATE March 30, 1973

SURVEYOR'S MICHIGAN REGISTRATION NO. 16034 (SEAL)

FOR STATE AND UNITED STATES AGENCIES:

SIGNED BY _____ DATE _____
CHIEF OF SURVEY PARTY

APPROVED AND SIGNED BY _____ DATE _____
MICHIGAN REGISTERED LAND SURVEYOR (SEAL)

00293

SURVEYOR'S MICHIGAN REGISTRATION NO. _____

Form No. MLM735
 DOUBLEDAY SPONS. & CO., KALAMAZOO, MICH.

FORM APPROVED BY MICHIGAN STATE BOARD OF REGISTRATION, JAN. 28, 1971
 DISTRIBUTED BY MICHIGAN SOCIETY OF REGISTERED LAND SURVEYORS

5/20



Pursuant to a contract with and Instructions from Edward Tiffin Esquire Surveyor General of the United States bearing date 20th day of November 1816 I have administered laid out and surveyed the above described fractional Township and hereby certify that it had such marks and bounds both natural and artificial as are represented on said plat and described in the following notes made thereof and returned with this plat into the Surveyor General's Office on the 18th day of February 1818

William Preston

CHESTERFIELD