

C152235

LAND CORNER RECORDATION CERTIFICATE
Filing Requirement of Act 74, Mich. P.A. 1970

94 DEC 14 AM 10: 53

CALL RECORD MADE AUG 1993 DEEDS COUNTY, MI

For corners in MACOMB (County)

Located In: Clinton Township Corner Code =#

- 1. Public Land Survey T 2N R 13E L-1
2. Property Controlling in Section S T R
3. Miscellaneous Property in Sec. S T R

LIBER 6527 PAGE 812

Register of Deeds Stamp & File Number

- 4. Lot No. Recorded Plat
5. Private Claims

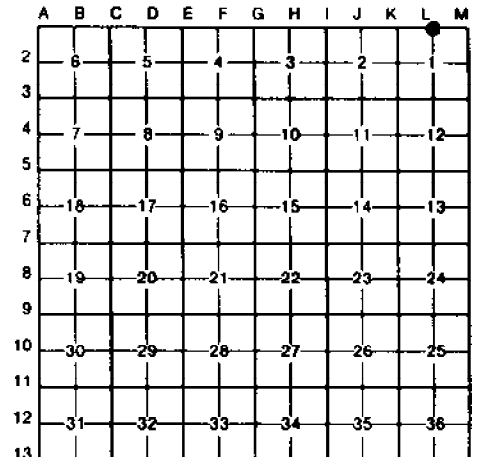

I, Randy Kolehouse, in a field survey on Sept. 28, 1994, do hereby certify that under requirements of P.A. 74, Michigan P.A. of 1970, the corner points mentioned in lines 1 and 2 above were in conformance with regulations and rules therefore as required in the current manual of survey instructions of the United States Department of the Interior, Bureau of Land Management or by a decree of a Court of Law and/or that the corner points mentioned in lines 3, 4 and 5 above were in conformance with the rules of the Michigan Board of Land Surveyors or by a Decree of a Court of Law; established, re-established, monumented, re-monumented, recovered, found as expressed below:

NOTE: Not more than 4 corners, all in the same town and range, may be recorded on this certificate.

A. Description of original monument and accessories and/or subsequent restoration:

Table with columns: L-1, 1817, G.L.O., Notes, Preston, NA, Set Post. Includes entries for 1980, 1989, and 1989 with details on surveys and monuments.

B. Description of corner evidence found and/or method applied in restoring or reestablishing corner:

L-1 Found 1/2" rebar in monument box in center line of Hall Road (M-59) on East right-of-way line +/- Fairchild this point is 560.01' East of L-13 T3N R13E (G.L.O. 574.2) which checks MDOT Dist. of 559.96 (Grid) from 1989. The corner as shown in L. 3263 P. 895 and L. 4795 P. 487 is approximately 276 feet West. 1/2" iron in Mon. Box checks three remaining witnesses from L.C.R.C. L. 4685 P. 293 as filed by Wetoskey of MDOT. This point is 0.63' North of Township line.

Note: Mon. box and form pin shown in L. 4718 P. 609 is at L-13 T3N R13E. (560.1 West)

L.C.R.C. L. 4685 P. 293

- Nail & tag in P. Pole S 50° E 82.39'
NE Corner Fr. Hse. S 40° W 111-53'
Nail & tag in P & L Pole N 40° W 80.59'

Measure West 2638.65' to K-1 (G.L.O. 2640)

Measure East 2128.96' to approximate Township corner (3/4" pipe) (G.L.O. 2065.8')

ACCEPTED BY THE MACOMB COUNTY SURVEY PEER GROUP AS THE OFFICIAL CORNER UNDER MICHIGAN PUBLIC ACT 345 OF 1990 AT A MEETING HELD ON 10-4-94

Signature of William E. Soderberg, P.S., Chairman

C. Description of monument for corner and accessories established to perpetuate locating the position of the corner:

L-1 I replaced the found 1/2" rebar and Monument Box with a 3/4" x 24" Iron Rod w/2" diameter aluminum cap stamped "Macomb County Monument MI Act 345 #25854" on the Township line, also set Monument Box.

- PK & Macomb Co. Remon. Tag in E Face Util. Pole N 08° W 236.66'
Nail & MDOT Tag SW Face Util. Pole N 40° W 81.00'
Nail & MDOT Tag NE Face Util. Pole S 41° E 81.96'
Nail & MDOT Tag SE Face Util. Pole S 54° W 82.03'
NW Corner Apt. Bldg. 24068 S 48° W 111.02'
NW Corner Apt. Bldg. 24100 S 24° E 127.32'

- C/L Top Nut Hyd. N 72° E 179.39'
C/L Top Nut Hyd. S 29° E 91.00'

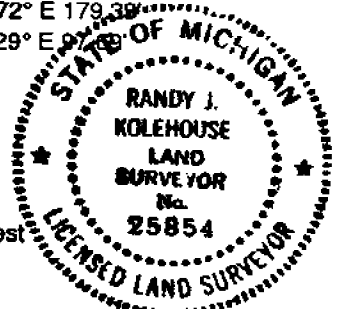

The selected location is accepted by me and is generally accepted by professional surveyors as the best available evidence of the position of the original corner.

Signed by Randy J. Kolehouse, Surveyor's Michigan License No. 25854

Date 10/14/94

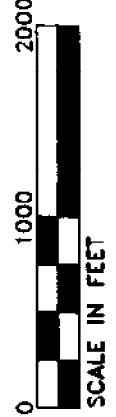
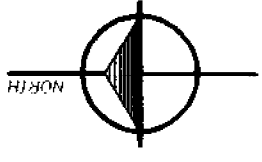
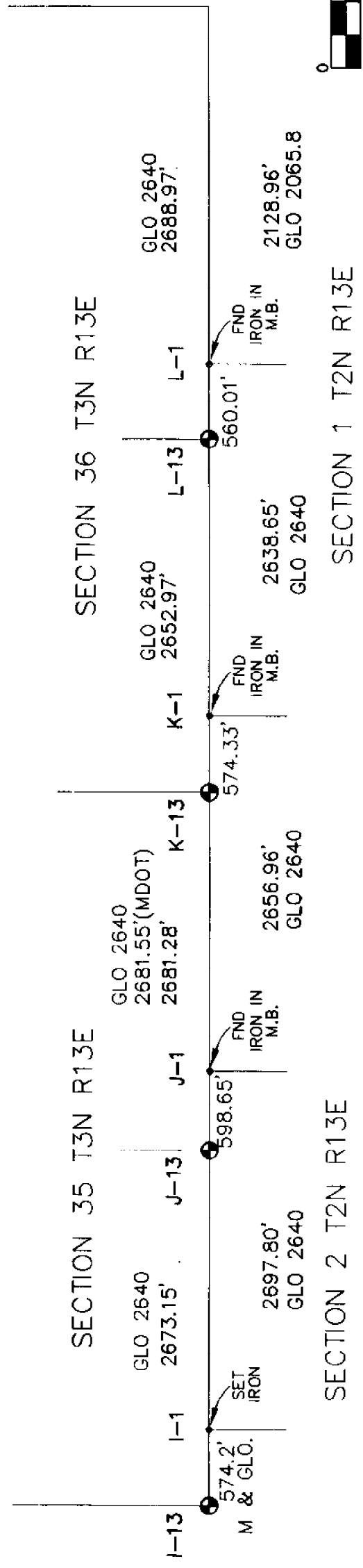
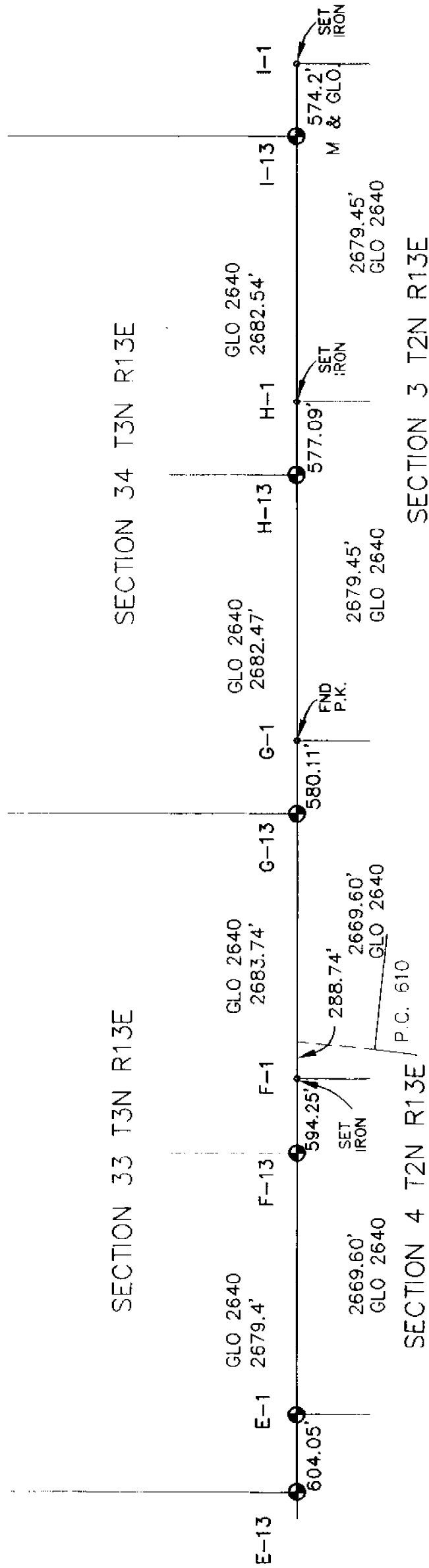

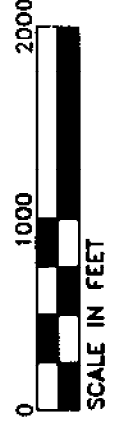
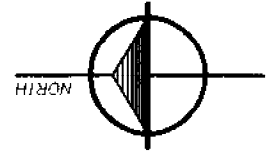
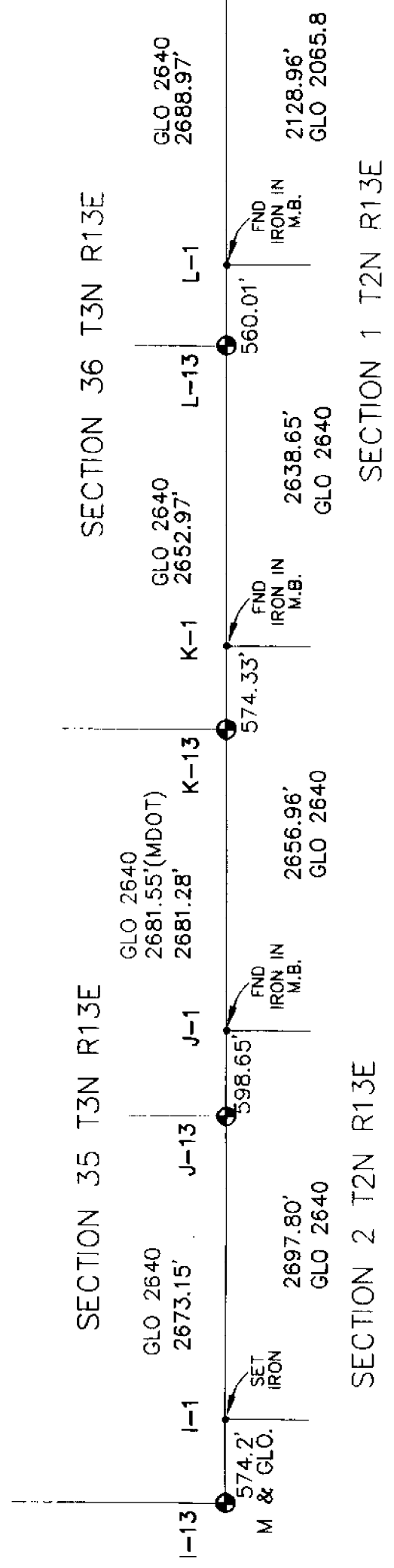
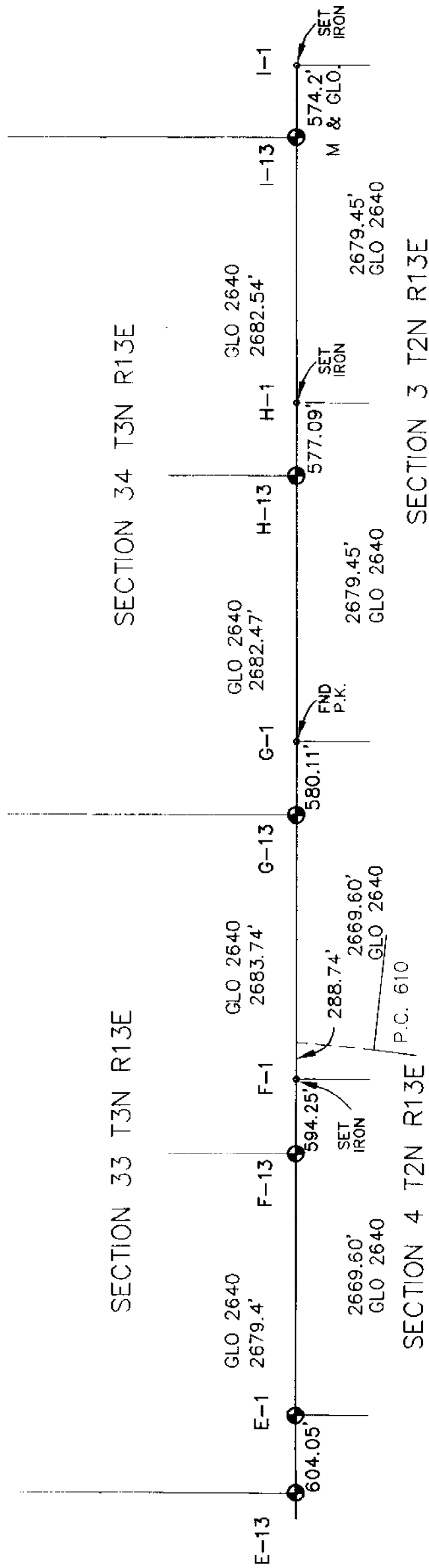

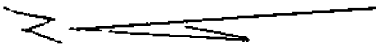

L-1

N 7
Sec. 1

S 7
Sec. 3

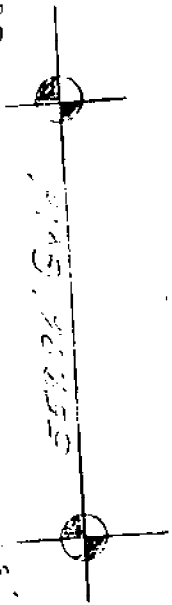

T. 2 N R. 13 E

SEC. NO. 1

GOV'T. MONUMENT WITNESSES RECORD (Rev. 3/60) Form 280

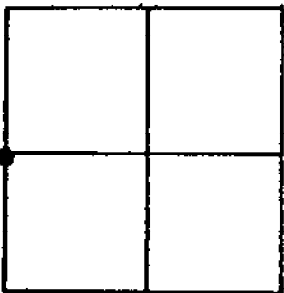
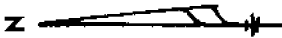

DESCRIPTION

N 1/4 Cor. Sec. 1
Clinton Twp. Macomb Co.
Monument Box.

WITNESSES

Power Pole	S 05° E	56.18'
20" Maple	N 60° W	76.32'
10" Elm	S 65° E	126.04'

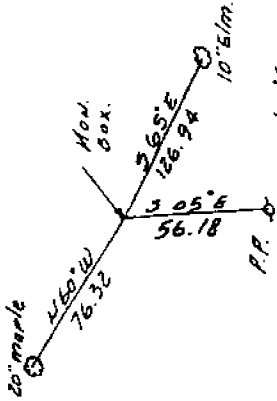

C. J. Lane
SURVEY CHIEF

1/9/63
DATE 2-1

MICHIGAN STATE HIGHWAY DEPARTMENT

CO. Macomb TWP. Clinton L /
 T. 2 N. R. 13 E. SEC. NO. 1 RECORDED: 7-18-89 L 4685 P 293
 (Date) (Libre) (Page)

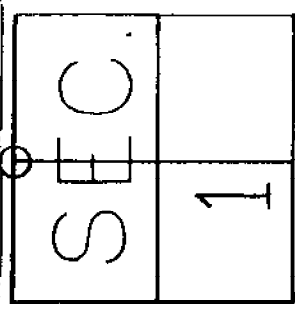

DESCRIPTION

N ¼ Corner Sec. 1 T2N, R13E
 Found PK Nail in C/L Pavt. M-59
 Set; Iron in Monu. Box
 Recorded by W. E. Soderberg LLS 17635
 on 8-25-80 L3263 Pg 895 Wrong location
 as per local surveyors and D. Gorman LLS
 Point found and witnessed not same as the
 recorded point noted above.

WITNESSES

- N 60° E 180.86' Top Center F. Hyd.
- S 50° W 82.49' Power pole (Nail & Tag)
- S 40° W 111.65' NE Cor Brick House
- N 40° W 80.64' Power pole w/light



James J. Soderberg
 SURVEY CHIEF REG. NO. _____ DATE 6-27-89 L-1

MENT WITNESSES RECORD

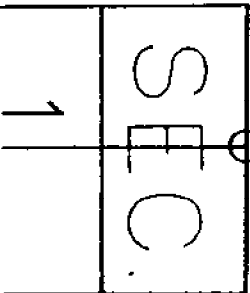

N ¼ Corner Sec. 1 T2N, R13E
 Found PK Nail in C/L Pavt. M-59
 Set; Iron in Monu. Box
 Recorded by W. E. Soderberg LIS 17635
 on 8-25-80 L3263 Pg 895 Wrong location

CO. Macomb TWP. Clinton
 T. 2 N. R. 13 E. SEC. NO. 1
 RECORDED: 7-18-89 L 4685 P 293
 (Date) (L/line) (Page)

DESCRIPTION

2
 SEC. NO. 1
 T. 2 N. R. 13 E

DESCRIPTION
 N ¼ Cor. Sec. 1
 Clinton Twp., Macomb Co.
 Monument Box.

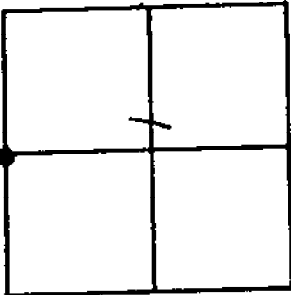

WITNESSES

Power Pole S 05° E 56.18'
 20" Maple N 60° W 76.32'
 10" Elm E 59° S 126.74'

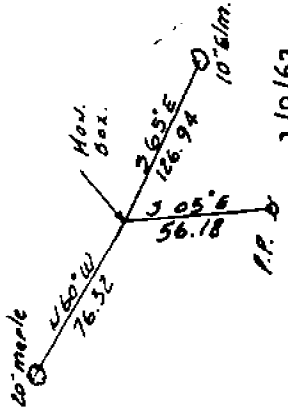

DATE 1/9/63
 SURVEY CHIEF *[Signature]*

MICHIGAN STATE HIGHWAY DEPARTMENT

GOV'T. MONUMENT WITNESSES RECORD
 Form 280 (Rev. 3/60)

T2N, R13E
 L-1

X
 I-1

LAND CORNER RECORDATION CERTIFICATE
Filing Requirement of Act 74, Mich. P.A. 1970

For corners in

MACOMB COUNTY
(County)

Located in:
CLINTON TWP.

Corner Code #

1. Public Land Survey	T	2N	R	13E	L-1
	T	2N	R	13E	M-1
	T		R		
	T		R		
2. Property Controlling in Section	S	1	T	R	
	S		T	R	
3. Miscellaneous Property in Sec.	S		T	R	
	S		T	R	

Register of Deeds Stamp & File Number

4. Lot No. _____, Recorded Plat _____
5. Private Claims _____

A	B	C	D	E	F	G	H	I	J	K	L	M
2	6	5	4	3	2	1						
3												
4	7	8	9	10	11	12						
5												
6	16	17	16	15	14	13						
7												
8	19	20	21	22	23	24						
9												
10	30	29	28	27	26	25						
11												
12	31	32	33	34	35	36						
13												

William E. Soderberg in a field survey on July 26, 1989 do hereby certify that under requirements of P.A. 74, Michigan P.A. of 1970, the corner points mentioned in lines 1 and 2 above were in conformance with regulations and rules therefore as required in the current manual of survey instructions of the United States Department of the Interior, Bureau of Land Management or by a decree of a Court of Law and/or that the corner points mentioned in lines 3, 4 and 5 above were in conformance with the rules of the Michigan Board of Land Surveyors or by a Decree of a Court of Law; established, re-established, monumented, re-monumented, recovered, found as expressed below:

NOTE: Not more than 4 corners, all in the same town and range, may be recorded on this certificate.

A. Description of original monument and accessories and/or subsequent restoration:

RECORDED IN MACOMB COUNTY RECORDS AT: 3:41 P M SEP 7 1989

Edna Hill

CLERK - REGISTER OF DEEDS MACOMB COUNTY, MICHIGAN

B. Description of corner evidence found and/or method applied in restoring or reestablishing corner:

#L-1: FOUND MONUMENT BOX SET FORM PIN

#M-1: FOUND 1 1/2" PIPE



C. Description of monument for corner and accessories established to perpetuate locating the position of the corner:

#L-1: FOUND MONUMENT BOX SET FORM PIN

#M-1: FOUND 1 1/2" PIPE

N/WEST 79.21' SET P.K.NAIL W/TAG #17635 IN THE SOUTHWEST FACE 14" PINE.
N/EAST 62.91' FOUND NAIL W/MDOT TAG IN THE NORTHWEST FACE OF A U.P.
S/EAST 108.69' SET P.K.NAIL W/TAG #17635 IN THE SOUTHWEST FACE OF A U.P.
S/WEST 75.47' SET P.K.NAIL W/TAG #17635 IN THE NORTHWEST FACE OF A U.P.

N/WEST 19.67' FOUND P.K.NAIL IN THE EAST FACE OF A 5" POPLAR TREE.
SOUTH 56.87' TO THE NORTH EDGE OF EXISTING ROAD
ESE 90.59' FOUND NAIL W/MDOT TAG.
EAST 7.43' FOUND 1" PIPE
NORTH 33.39' FOUND P.K.NAIL IN THE WEST FACE OF A 28" STUMP

Signed by *William E. Soderberg* Date JULY 26, 1989
Surveyor's Michigan License No. 17635

LAND CORNER RECORDATION CERTIFICATE
Filing Requirement of Act 74, Mich. P.A. 1970

For corners in

Table with columns: County (Macomb), Located In (T 2 N. R 13 E), Corner Code (L-1), and numbered rows for Public Land Survey, Property Controlling in Section, and Miscellaneous Property in Sec.

RECORDED IN MACOMB COUNTY
RECORDS AT: 1:50p M.

JUL 18 1989

Edna Miller (Signature)

CLERK - REGISTER OF DEEDS
MACOMB COUNTY, MICHIGAN

Register of Deeds Stamp & File Number

4. Lot No. Recorded Plat
5. Private Claims

Grid table with columns A-M and rows 2-13, containing numbers 1-36.

I, P. H. Wetoskey in a field survey on June 28, 1989 do hereby certify that under requirements of P.A. 74, Michigan P.A. of 1970, the corner points mentioned in lines 1 and 2 above were in conformance with regulations and rules therefor as required in the current manual of survey instructions of the United States Department of the Interior, Bureau of Land Management or by a decree of a Court of Law and/or that the corner points mentioned in lines 3, 4 and 5 above were in conformance with the rules of the Michigan Board of Land Surveyors or by a Decree of a Court of Law, established, re-established, monumented, re-monumented, recovered, found as expressed below:

NOTE: Not more than 4 corners, all in the same town and range, may be recorded on this certificate.

A. Description of original monument and accessories and/or subsequent restoration:

L-1 From L.C.R.C., Liber 3263, Page 895, By W. E. Soderberg, No. 17635, on 8-25-80. North 1/4 Post of Section 1 - Set P.K. Nail from old Highway records and adjoining property descriptions. N 27° E 59.10' C/L top of hydrant S 20° E 44.36' C/L top of hydrant S 41° W 71.15' PK in NW face D.E. pole N 31° W 68.84' PK in SW face 15" tree East 2,405.39' Northeast Corner

B. Description of corner evidence found and/or method applied in restoring or reestablishing corner:

L-1 Found: PK Nail in C/L of M-59 as per local surveyors agree as to location of N 1/4 Post of Section 1; which is 2,121.83' east to northeast corner, rather than 2,405.39' noted above.

C. Description of monument for corner and accessories established to perpetuate locating the position of the corner:

L-1 Monument: Iron in Monument Box N 60° E 180.86' Top Center of F. Hyd. S 50° E 82.49' P.P. (Nail & Tag) S 40° W 111.65' NE Cor. brick & Frame house N 40° W 80.64' P.P. w/light (Nail & Tag)

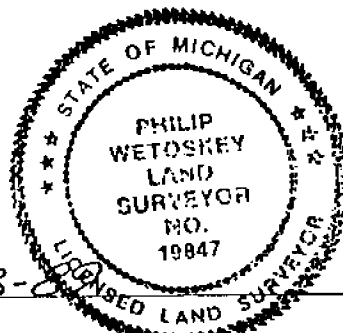

Signed by (Signature) Date 7-3-89
Surveyor's Michigan License No. 19847
Michigan Department of Transportation

LAND CORNER RECORDATION CERTIFICATE
Filing Requirement of Act 74, Mich. P.A. 1970

For corners in

Macomb
County

Located In:
Clinton Twp.

Corner Code: L-1

1. Public Land Survey T 2N. R 13E. L-1
T _____ R _____
T _____ R _____
T _____ R _____
2. Property Controlling in Section S 2 T 2N R 13E
S _____ T _____ R _____
3. Miscellaneous Property in Sec. S _____ T _____ R _____
S _____ T _____ R _____
4. Lot No. _____ Recorded Plat _____
5. Private Claims _____

Register of Deeds Stamp & File Number

	A	B	C	D	E	F	G	H	I	J	K	L	M
2	6	5	4	3	2	1							
3													
4	7	8	9	10	11	12							
5													
6	18	17	16	15	14	13							
7													
8	19	20	21	22	23	24							
9													
10	30	29	28	27	26	25							
11													
12	31	32	33	34	35	36							
13													

I, Herbert G. Avey in a field survey on January 3, 19 89 do hereby certify that under requirements of P.A. 74, Michigan P.A. of 1970, the corner points mentioned in lines 1 and 2 above were in conformance with regulations and rules therefore as required in the current manual of survey instructions of the United States Department of the Interior, Bureau of Land Management or by a decree of a Court of Law and/or that the corner points mentioned in lines 3, 4 and 5 above were in conformance with the rules of the Michigan Board of Land Surveyors or by a Decree of a Court of Law; established, re-established, monumented, re-monumented, recovered, found as expressed below:

NOTE: Not more than 4 corners, all in the same town and range, may be recorded on this certificate.

A. Description of original monument and accessories and/or subsequent restoration:

RECORDED IN MACOMB COUNTY
RECORDS AT: 12:36 P.M.

B. Description of corner evidence found and/or method applied in restoring or reestablishing corner:

JAN 8 1990

L-1 P.K. Nail
Centerline intersection North Ave. & Hall Road - 1/2" Bar in Mon. Box

Edna M. Hill
CLERK - REGISTER OF DEEDS
MACOMB COUNTY, MICHIGAN

C. Description of monument for corner and accessories established to perpetuate locating the position of the corner:

L-1 59.10' N.E. to center top of hydrant.
44.36' S.E. to center top of hydrant.
71.15' S.W. to P.K. nail, N.W. face P. Pole.
68.84' N.W. to P.K. nail, S.W. face 15" tree.

Centerline intersection North Ave. & Hall Road
123.31' S.W. to conc. nail, S.E. face P. Pole.
75.18' N.W. to nail in M.S.H.D. Disc, N.E. face P. Pole.
41.07' N.E. to Conc. nail, S.E. face P. Pole.
84.69' S.E. to nail in M.S.H.D. Disc, N.E. face P. Pole.

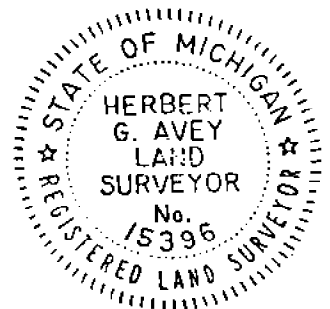

Signed by Herbert G. Avey Date January 4, 1989

Surveyor's Michigan License No. 15396

LAND CORNER RECORDATION CERTIFICATE

FILING REQUIREMENT OF ACT 74, MICH. P.A. 1970

FOR CORNERS OF—	LOCATED IN—	CORNER CODE NUMBER
1. PUBLIC LAND SURVEY _____	T. <u>2</u> N. <u>X</u> , R. <u>13</u> E. <u>*</u>	<u>L-1 M-1</u>
2. PROPERTY CONTROLLING IN SECTION _____	T. _____ N. _____ S. _____ R. _____ E. _____ W. _____	_____
3. MISCELLANEOUS PROPERTY IN SECTION _____	T. _____ N. _____ S. _____ R. _____ E. _____ W. _____	_____
4. LOT NO. _____, RECORDED PLAT _____		
5. PRIVATE CLAIMS _____		

1666635

RECORDED IN MACOMB COUNTY RECORDS AT: 12:35 P.M.

SEP - 3 1980

Edna H. ...
CLERK - REGISTER OF DEEDS
MACOMB COUNTY, MICHIGAN

REGISTER OF DEEDS STAMP AND FILING NUMBER

I, WILLIAM E. SODERBERG, do hereby certify that under requirements of P.A. 74, Michigan P.A. of 1970, the corner points mentioned in lines 1 and 2 above were, in a field survey on AUGUST 18, 1980, established, re-established, monumented, re-monumented, recovered or restored as expressed below and in conformance with regulations and rules therefore as required in the current manual of survey instructions of the United States Department of the Interior, Bureau of Land Management or by a decree of a court of law. Furthermore, that the corner points mentioned in lines 3, 4 and 5 above were, in a field survey on _____, 19____, found, recovered, restored, established or re-established as expressed below and in conformance with the rules of the Michigan State Board of Registration for Land Surveyors or, by a Decree of a Court of law:

A. Description of original monument and accessories and/or subsequent restoration:

B. Description of corner evidence found and/or method applied in restoring or re-establishing corner:

M-1 - NORTHEAST CORNER OF SECTION 1 - FOUND 3/4" PIPE
L-1 - NORTH 1/4 POST OF SECTION 1 - SET PK. NAIL FROM OLD HIGHWAY RECORDS AND ADJOINING PROPERTY DESCRIPTION

C. Description of monument for corner and accessories established to perpetuate locating the position of the corner:

<p><u>MAX LT1</u></p> <p><u>N 27° E 59.10' @ TOP OF HYDRANT</u></p> <p><u>S 20° E 44.36' @ TOP OF HYDRANT</u></p> <p><u>S 41° W 71.15' PK IN N.W FACE D.E. POLE</u></p> <p><u>N 31° W 68.84' PK IN S.W FACE 15" TREE</u></p> <p><u>EAST 2405.39' NORTHEAST CORNER.</u></p>	<p><u>M-1</u></p> <p><u>S 67° E 83.23' PK IN N FACE UTILITY POLE</u></p> <p><u>N 05° E 32.55' PK IN E FACE 30" OAK</u></p> <p><u>S 03° W 57.06' PK IN N EDGE ASPHALT</u></p> <p><u>N 50° W 17.13' PK IN SW FACE 4" OAK</u></p>
--	--

SIGNED BY William E. Soderberg DATE 8-25-80

SURVEYOR'S MICHIGAN REGISTRATION NO. 17635

FOR STATE AND UNITED STATES AGENCIES:

SIGNED BY _____ DATE _____

APPROVED AND SIGNED BY _____ DATE _____



SURVEYOR'S MICHIGAN REGISTRATION NO. _____

BY *W. E. Soderberg*
P.A.A.

A682502

Certificate of Survey

PHONE NUMBER
(313) 288-1234

PERSON, ECKSTEIN & WESTRICK, INC.
42800 GARFIELD ROAD
MT. CLEMENS, MICH. 48044

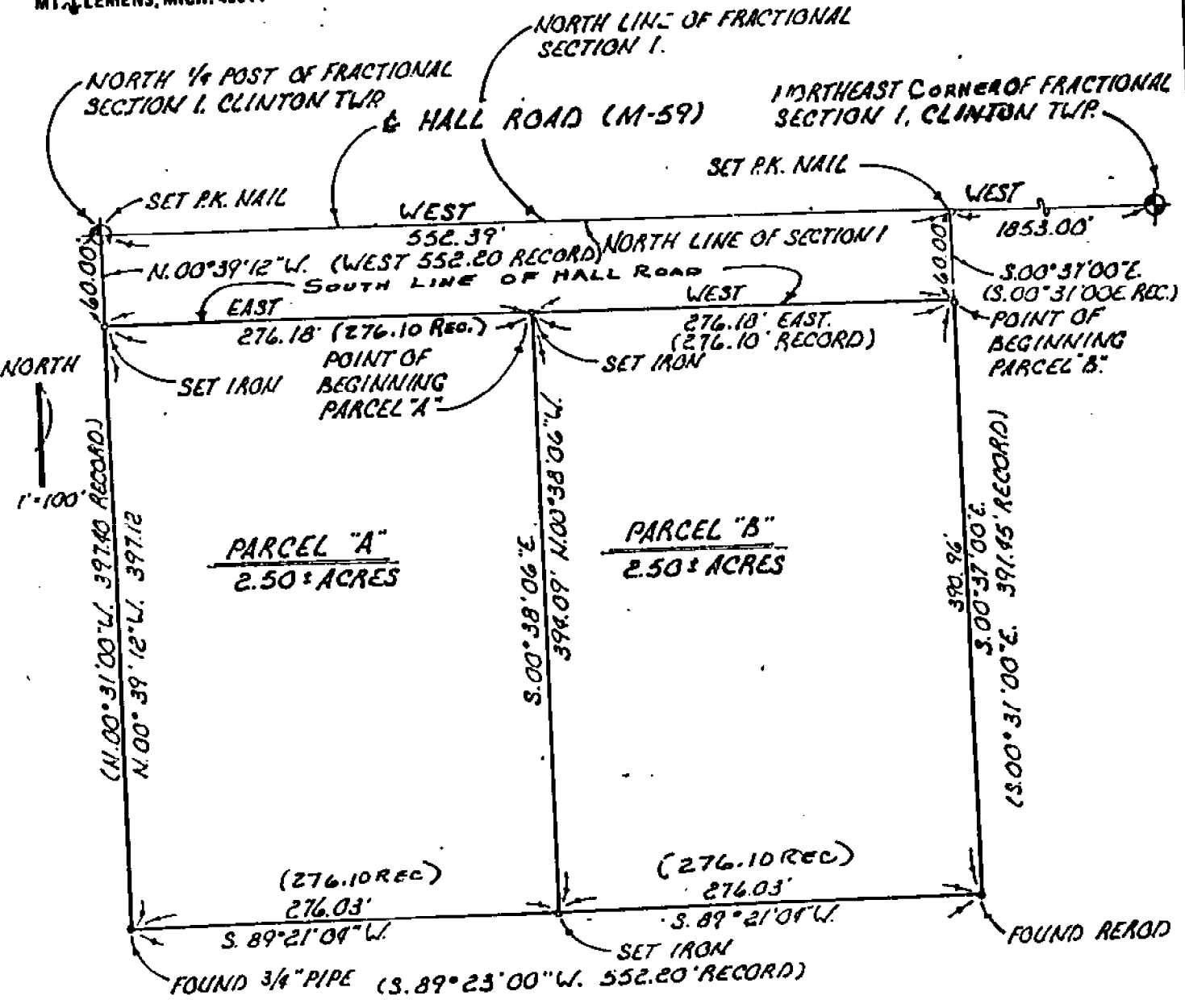

RECORDED IN MACOMB COUNTY RECORDS AT: 2:15 P.M. SEE ATTACHED SHEET FOR DESCRIPTION
DEC - 4 1980

• SET IRON
• FOUND IRON

Edna M. ...
CLERK - REGISTER OF DEEDS
MACOMB COUNTY, MICHIGAN

WITNESSES

NORTHEAST CORNER OF FRACTIONAL SECTION 1
FOUND 3/4" PIPE

- S. 67°E. 83.23 PK. IN UTILITY POLE
- N. 05°E. 32.55 PK. IN 30" OAK
- S. 02°W. 57.06 PK. IN NORTH EDGE ASPHALT
- N. 50°W. 17.13 PK. IN 4" OAK

NORTH QUARTER POST OF FRACTIONAL SECTION 1
P.K. NAIL

- N. 27°E. 59.10 & HYDRANT
- S. 20°E. 44.36 & HYDRANT
- S. 41°W. 71.15 PK. IN D.E. POLE
- N. 31°W. 68.89 PK. IN 15" TREE

SHEET 1 OF 2

BOOK CLINTON 80-01

DRAWN BY: P.A.A.

CERTIFIED TO **L. TROMBLEY**
ADDRESS **5280 VINCENT TRAIL**
CITY & STATE **WASHINGTON, MICH. 48094**
TOWNSHIP **CLINTON**
SECTION **1**
COUNTY **MACOMB**

AEW NO. 20102
I certify that I have surveyed and mapped the land above and as described on AUG. 19 19 80
and that the ratio of closure on the unadjusted field observations is 1/5000
and that all of the requirements of Public Act 132, of 1970 have been complied with.
No. 176
Bearing taken on this survey were determined as follows:
PREVIOUS SURVEY OF PROPERTY
William E. Soderberg
WILLIAM E. SODERBERG #17636 REGISTERED LAND SURVEYOR



SCALE 1" EQUALS 100'

