

---

**MACOMB COUNTY 2016 REMONUMENTATION GRANT  
PROGRAM FOR CLINTON TOWNSHIP  
B-02**

**Section One**

Index

Pictures in the four cardinal directions; found monumentation and after setting the required monumentation.

**Section Two**

Surveyor's Report

Land Corner Recordation Certificate

**Section Three**

1-2. Field Notes

3. Map of Clinton Township – 1875

4. Map of Clinton Township – 1895

5. Map of Clinton Township – 1916

6. Map of Clinton Township – 2006

7. Macomb County Composite Map 11-06B

8. Macomb County Composite Map 11-06C

9. Macomb County Composite Map 11-06F

10. Macomb County Composite Map 11-06G

**Section Four**

1. Land Corner Recordation Certificate, L. 3310, pg. 115, Page one of one

2. Land Corner Recordation Certificate, L. 06325, pg. 317, Page one of one













**Land Corner Recordation Certificate**  
**2016 Annual Grant Agreement**  
 Authority: MICH. 1970 PA 74, MCL 54.205

Surveyor's Name: Huston K. Kennedy, PS  
 For Corner(s) in: Macomb County

Field Survey Date: June 4, 2016  
 Municipality: Clinton Township

Corner Type	Section Private Claim	Survey Township				Corner Code
Original Public Land Survey Corner	S/PC _____	T _____	N _____	R _____	E _____	_____
Property Controlling Corner	S/PC _____	T _____	N _____	R _____	E _____	_____
Property Corner	S/PC _____	T _____	N _____	R _____	E _____	_____
Protracted Public Land Survey Corner	S/PC <u>6</u>	T <u>02</u>	N _____	R <u>13</u>	E _____	<u>B-02</u>

Other Corner Code Description:

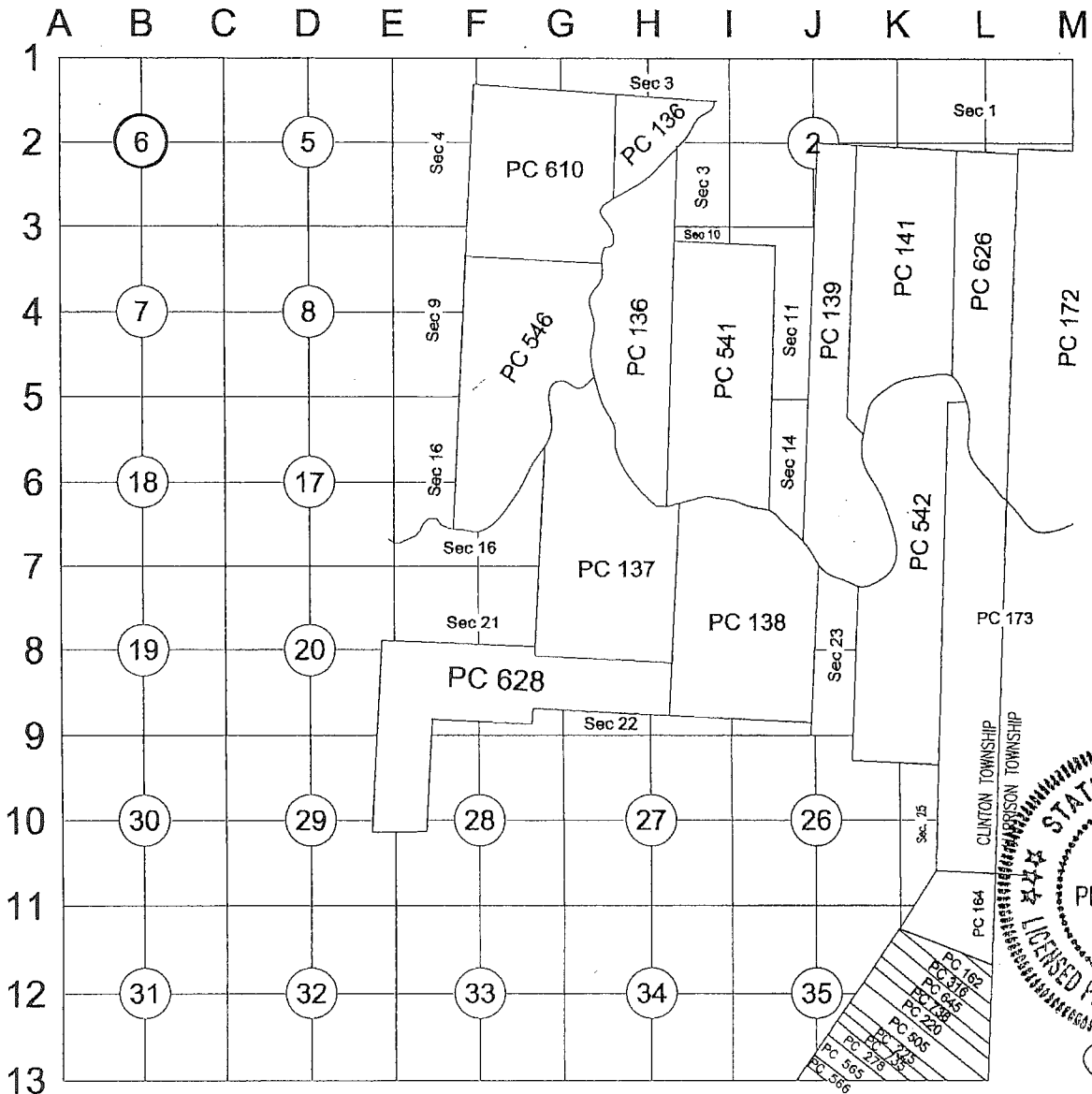

4 MB

C



**Part A: Corner History:**

- 1.) 1818-Preston, D.S., Center of Section 6 was not monumented during the original government survey
- 2.) 1981-Avey, RLS #15396; LCRC L. 3310, pg. 115 – Replaced the corner by setting a 1/2" bar with cap #15396 using the witnesses below which were found in good condition
- 3.) 1994-Money, PS #30092; LCRC L. 06325, pg. 317 – Fnd a 3/4" pipe

**Part B: Surveyor's Report on Perpetuation, Restoration, Reestablishment or Monumentation of Corner:**

The Center of Section 6 was not monumented in the original government survey. The corner has been perpetuated with a 3/4" x 24" iron pipe that falls 19' west of the back of the concrete curb and gutter for Dalcoma Drive extending to the north and south, which has a bituminous surface. There are no lines of occupational features extending to the east or west.

The witnesses from items # 2 & 3 as listed in Part "A", the comparison of the recorded distance to the measured distance between the following adjacent public land corner to the South (B-03) were used to validate the found 3/4" iron pipe as the best evidence for the Center of Section 6 (B-02) to be perpetuated.

**RECORDED, UNRECORDED AND FIELD MEASUREMENTS BETWEEN ADJACENT CORNERS**

**B-02 to B-01**

No GLO  
N02°23'36" W 2693.66 Ft. (mea. 2016)

**B-02 to B-03**

No GLO  
LCRC recorded in Liber 3310, page 115 = 2659.88 Ft.  
N02°47'57" W 2660.23 Ft. (mea. 2016)

**B-02 to A-02**

No GLO  
S87°20'49" W 2666.68 Ft. (mea. 2016)

**B-02 to C-02**

No GLO  
N87°03'50" E 2658.86 Ft. (mea. 2016)

**Part C: Field Evidence of Perpetuation or Monumentation of Corner:**

B-02 I replaced the found 3/4" iron pipe with a 4" diameter concrete monument with a 1/2" iron rod 36" long with a 2" diameter brass cap stamped "Macomb County Monument, MI Act #345, PS #17623" (B-02)

**Accessories:**

- N08°W 48.92' Cut "x" south edge casting for GV&W manhole
- S20°E 61.62' Cut "x" NE corner casting for storm sewer structure
- S45°E 81.70' Cut "x" NW corner of casting for storm sewer structure
- N89°E 10.61' Cut "x" East side of casting for sanitary sewer manhole
- N72°E 99.44' Set Mag Nail w/Remon washer stamped "Macomb County Witness Tag" top a guardrail post

I, Huston K. Kennedy, P.S., in a field survey on June 4, 2016, certify under the requirements of the State Survey and Remonumentation Act, 1990 PA 345, MCL 54.261 to 54.279, and the Corner Recordation Act, 1970 PA 74, MCL 54.201 to 54.210d, that the corner identified and described hereon has been perpetuated or monumented as described in Parts A, B, and C above, pursuant to the laws and rules of the State of Michigan.

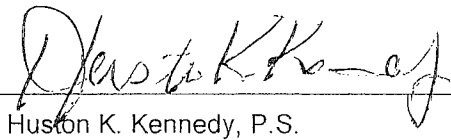
  
Huston K. Kennedy, P.S.

September 12, 2016

Date

Professional Surveyor's License No.: 17623

Prepared by:  
Huston K. Kennedy, PS  
105 North Washington Street  
Oxford, Michigan 48371

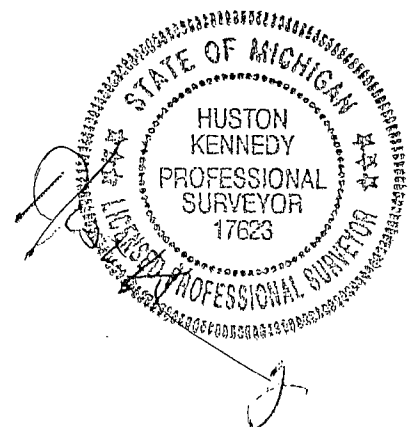



Geodetic Coordinate Data for corner:

Corner Code and Narrative Description: B-02, T02N, R13E  
0

Date of Observation	Latitude	Longitude	Datum and Adjustment Year	Epoch Date
14 June 2016	N42°37'12.021136"	W-82°57'47.064630"	NAD83 (2011)	2010.0000

Method for Latitude-Longitude determination: : Dual Frequency Static Observations constraining to the CORS stations of Auburn Hills (AJ5557), Livonia (DK7841) and Brighton (AJ5553), with 3 dimensional least square adjustment.

Disclaimer on accuracy of values reported relative to their use: 1' ±.

State Plane Coordinates in international feet: N-411308.92, E-13501109.78  
Standard Deviation: 0.04 N-0.05 E  
Zone South  
Combined Factor: 0.99989  
NGSPID: = Washington Station (DH 9019)  
Survey Method: GPS C2-II  
Orthometric Height: 600.38  
Elev. Datum: NAVD 88

I, Joseph C. Kapelczak, state under the requirements of the State Survey and Remonumentation Act, 1990 PA 345, MCL 54.261 to 54.279, that the Latitude and Longitude reported hereon were observed by me for the corner identified hereon and that the data reported meets the requirements prescribed for the State Survey and Remonumentation Program.

*Joseph C. Kapelczak*  
\_\_\_\_\_  
Joseph C. Kapelczak, PS

*SEPT. 12, 2016*  
\_\_\_\_\_  
Date

Professional Surveyor's License No.: 24598

JCK Group, Inc.  
8615 Richardson Road  
Suite 100  
Commerce Township, MI 48390



I, Martin C. Dunn, state that the corner(s) identified and described hereon and perpetuated or monumented as described in Parts A, B, and C above was presented to and reviewed by the Peer Review Group on July 12, 2016 and is accepted for filing in the Macomb County Remonumentation Program.

*Martin C. Dunn*  
\_\_\_\_\_  
Martin C. Dunn, P.S.

*9-30-2016*  
\_\_\_\_\_  
Date

Macomb County Surveyor Representative  
License No. 30081



# SKETCH OF CORNER LOCATION

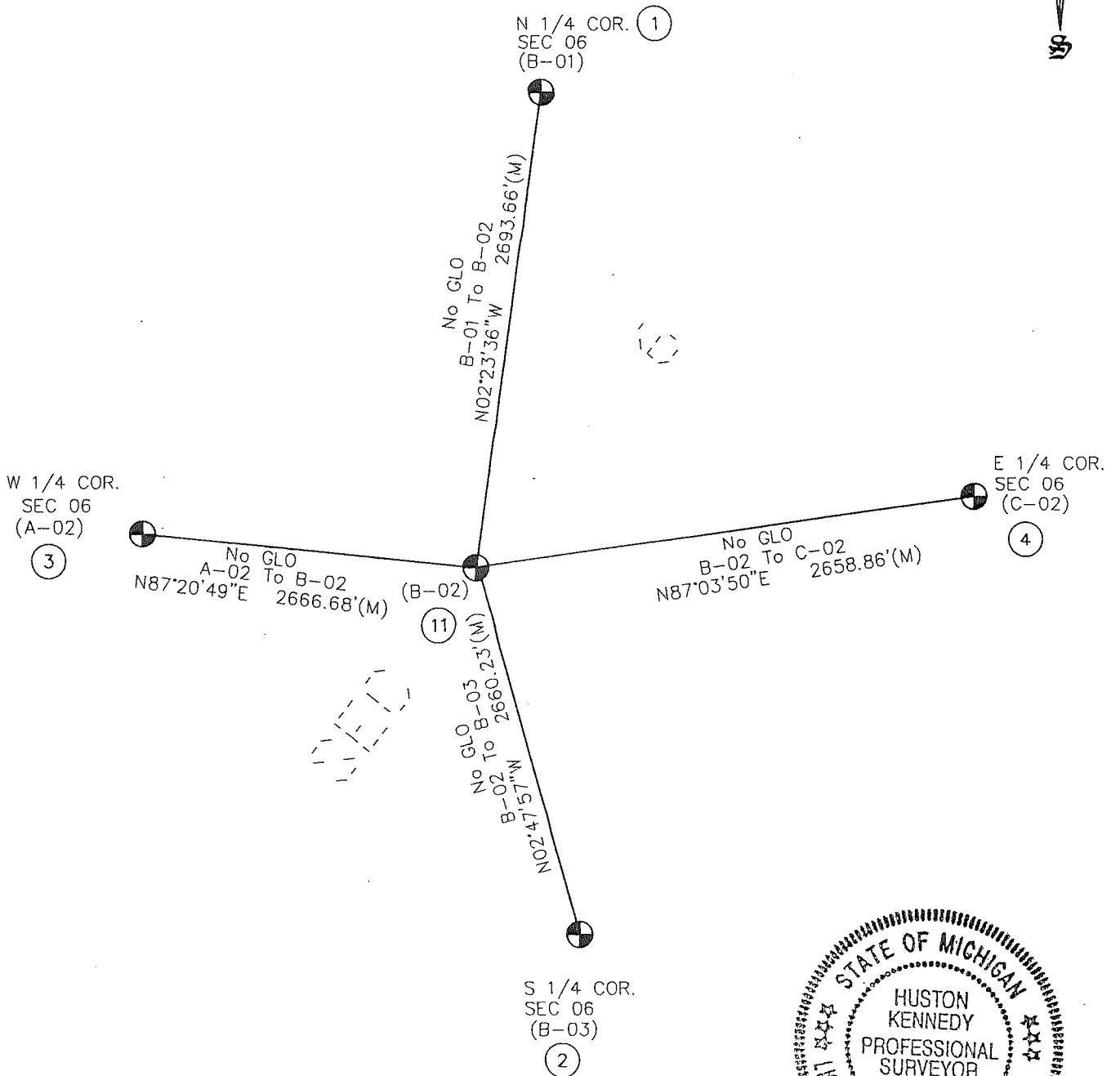
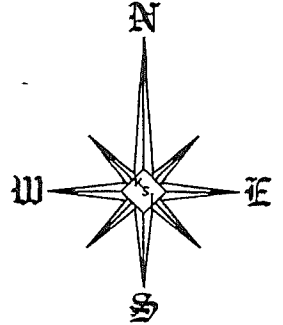

SECTION 06, T02N, R13E  
CLINTON TOWNSHIP  
(16-7610)

Center of Section that is being accepted and used. ⑪

Not To Scale

Land Corner Recordation Certificate  
T 02 N R 13 E Code B-02

**2016  
MACOMB COUNTY REMONUMENTATION  
GRANT PROGRAM FOR  
CLINTON TOWNSHIP  
Research Dossier  
B-02**

Prepared by:  
Kennedy Surveying, Inc.  
105 North Washington Street  
Oxford, Michigan 48371

---

**Sources of Information Researched  
For Macomb County 2016 Remonumentation Grant Program  
for Clinton Township**

- 1) GLO Notes
- 2) Act 74 Recorded LCRC
- 3) Act 132 Recorded Surveys
- 4) Personal History and Records
- 5) LCRC's and Surveys
- 6) Letters to the Following, Requesting Unrecorded information
  - a) Anderson, Eckstein & Westrick
  - b) BMJ Engineers & Surveyors
  - c) Community Engineering & Surveying
  - d) David Little Land Surveyor
  - e) David P. Smith & Associates, Inc.
  - f) Fenn & Associates Surveying, Inc.
  - g) George Jerome & Company
  - h) Grant Ward Surveyors
  - i) Great Lakes Geomatics
  - j) JCK Group, Inc.
  - k) James Land Surveying
  - l) Kem-Tec & Associates
  - m) Kieft Engineering, Inc.
  - n) Lehner Associates, Inc.
  - o) Metco Land Sea Corp.,
  - p) Milletics & Associates
  - q) R. A. Duthler Land Surveyor, LLC
  - r) Reichert Surveying
  - s) R. J. Donnelly & Associates
  - t) Road Commission for Macomb County
  - u) Rowe Professional Services
  - v) Spalding, DeDecker & Associates
  - w) Urban Land Consultants, LLC
  - x) William J. Angus & Associates



## **B-02 TOWN 02 NORTH, RANGE 13 EAST, CLINTON TOWNSHIP**

Recorded and unrecorded surveys, LCRC's, plats and condominium plans that were used to recover and verify the location of B-02.

### **EXISTING FILED CONDITIONS**

Found a ¾" x 24" iron pipe 19' west of back of concrete curb and gutter for Dalcoma Drive extending to the north and south, which has a bituminous surface with concrete curb and gutter. There are no lines of occupational features extending to the east or west.

### **GLO HISTORY**

1818 – W. Preston, D.S., the township was divided into sections with closing corners set on the north and west lines of the township, the Center of Section 6 was not monumented during the original government survey.

### **RECORDED AND UNRECORDED INFORMATION USED TO RECOVER AND VERIFY THE LOCATION OF THIS CORNER**

February 17, 1981 – Herbert J. Avey, RLS #15396 recorded a LCRC in Liber 3310, page 115. He replaced the corner by setting a ½" bar with cap #15396 using the witnesses below which were found in good condition.

### **WITNESSES:**

73.24' north PK nail in west face 4" Wild cherry (gone)  
66.95' west to form nail in washer north face triple 6" Maple (gone)  
120.47' SE to vertical PK nail in westerly root 30" Maple (gone)  
\*2659.88' south to ½" bar in monument box centerline 19 Mile Road – south ¼ corner (mea. 2660.16')

May 11, 1994 – Shelby W. Money, PS #30092 recorded a LCRC in Liber 06325, page 317. He found a ¾" pipe.

### **WITNESSES:**

\*Az 00° 15.80' Fnd the centerline of gas line marker (mea. 15.80')  
Az 00° 73.24' Set PK nail w/tag #30092 above scar found in the west face of 6" Cherry (gone)  
Az 55° 78.14' Set PK nail w/tag #30092 in the NW face of 8" Elm on the west bank of drain (gone)  
Az 275° 66.95' Fnd Form nail in the north face of a triple 8" Maple (gone)  
\*Az 310° 81.75' Fnd the centerline of a hydrant

### **RECORDED, UNRECORDED AND FIELD MEASUREMENTS BETWEEN ADJACENT CORNERS**

#### **B-02 to B-01**

No GLO  
N02°23'36" W 2693.66 Ft. (mea. 2016)

#### **B-02 to B-03**

No GLO  
LCRC recorded in Liber 3310, page 115 = 2659.88 Ft.  
N02°47'57" W 2660.23 Ft. (mea. 2016)

(Revised 07/13/16)

**B-02 to A-02**

No GLO

S87°20'49" W 2666.68 Ft. (mea. 2016)

**B-02 to C-02**

No GLO

N87°03'50" E 2658.86 Ft. (mea. 2016)

**B-02 (as monumented) to B-02 (intersection of ¼ lines)**

N52°31'45" E 11.56 Ft. (cal.)

**SURVEYOR'S RECOMMENDATION**

The witnesses from the above mentioned recorded LCRC's, the comparison of the recorded distance to the measured distance between the following adjacent public land corner to the South (B-03) were used to validate the location of the found ¾" iron pipe as of June 14, 2016. I therefore, recommend to the Macomb County Survey Peer Group to accept the location of the found ¾" iron pipe as the best evidence of the Center of Section 6 (B-02) to be perpetuated.



Huston K. Kennedy, PS  
Kennedy Surveying, Inc.

HKK/ch

\*Used to verify the location of the found corner (B-02)

**2016  
MACPMB COUNTY REMONUMENTATION  
GRANT PROGRAM FOR  
CLINTON TOWNSHIP B-02**



16-7610

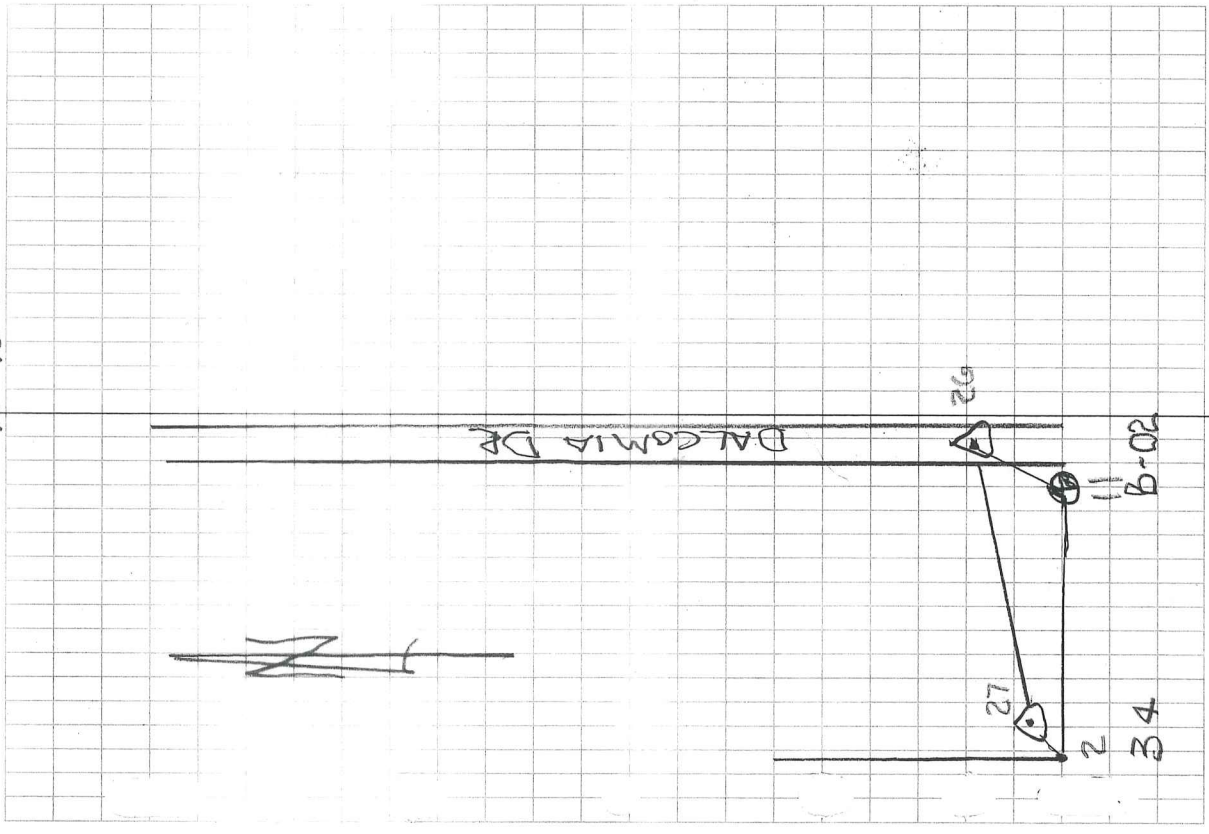

1348-22 (GR)					
1348-39 (L&W)	♂	26-27			Control
		1348.41			
PR 27 TO P7 11 (HL)	♂	26-11			B-02
1 34-01-10		76.38			
2 68-02-20					
3 34-01-10					
4 PR 27 TO P7 28 (HL)		26-28			with 28 NW Hwy
28 04-11-40	♂	126.72			
29 09-45-35	♂	68.97			Center G-V&W
30 06-10-55 (HL)	♂	110.93			NE cor. CB
31 05-19-10	♂	103.40			NW cor. CB
32 151-22-20	♂	37.52			GUARD RAIL Post
33 238-42-10 (HL)	♂	69.03			Center Spout Mid
4 PR 26 TO P7 34 (HL)	♂	27-34			Fo 1/2 Fe 1/2
1 140-26-35	♂	62.25			
2 280-53-00					47955
3 140-26-30					





# MAP OF CLINTON

Township 2 North Range 13 East

Scale 2 Inches to one Mile

of the Meridian of Michigan

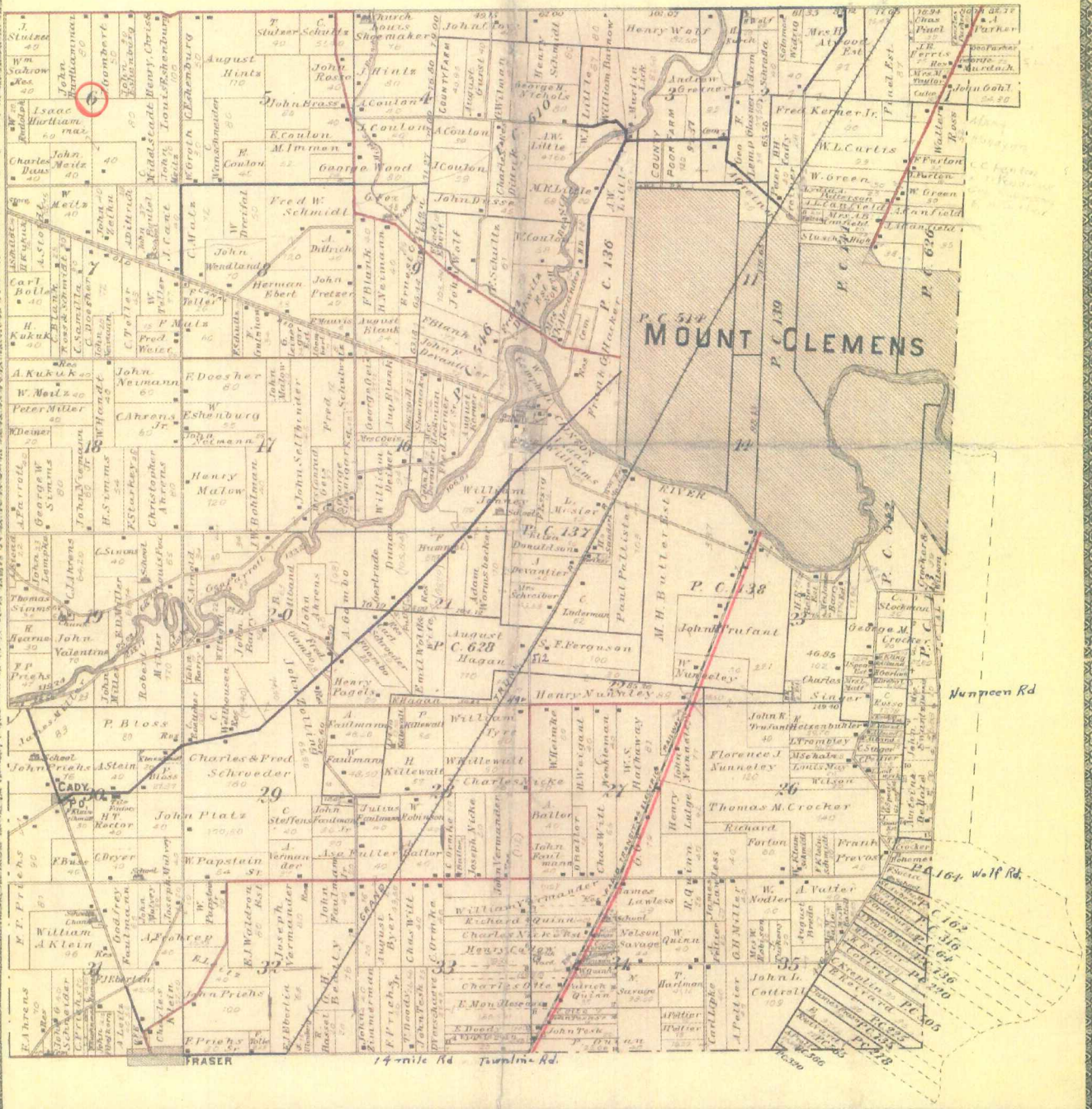

1895 (4)



MAP OF  
**CLINTON**  
 TOWNSHIP

Scale 2 inches to 1 mile

Fractional Township 2 North, Range 13 East of the Michigan Meridian

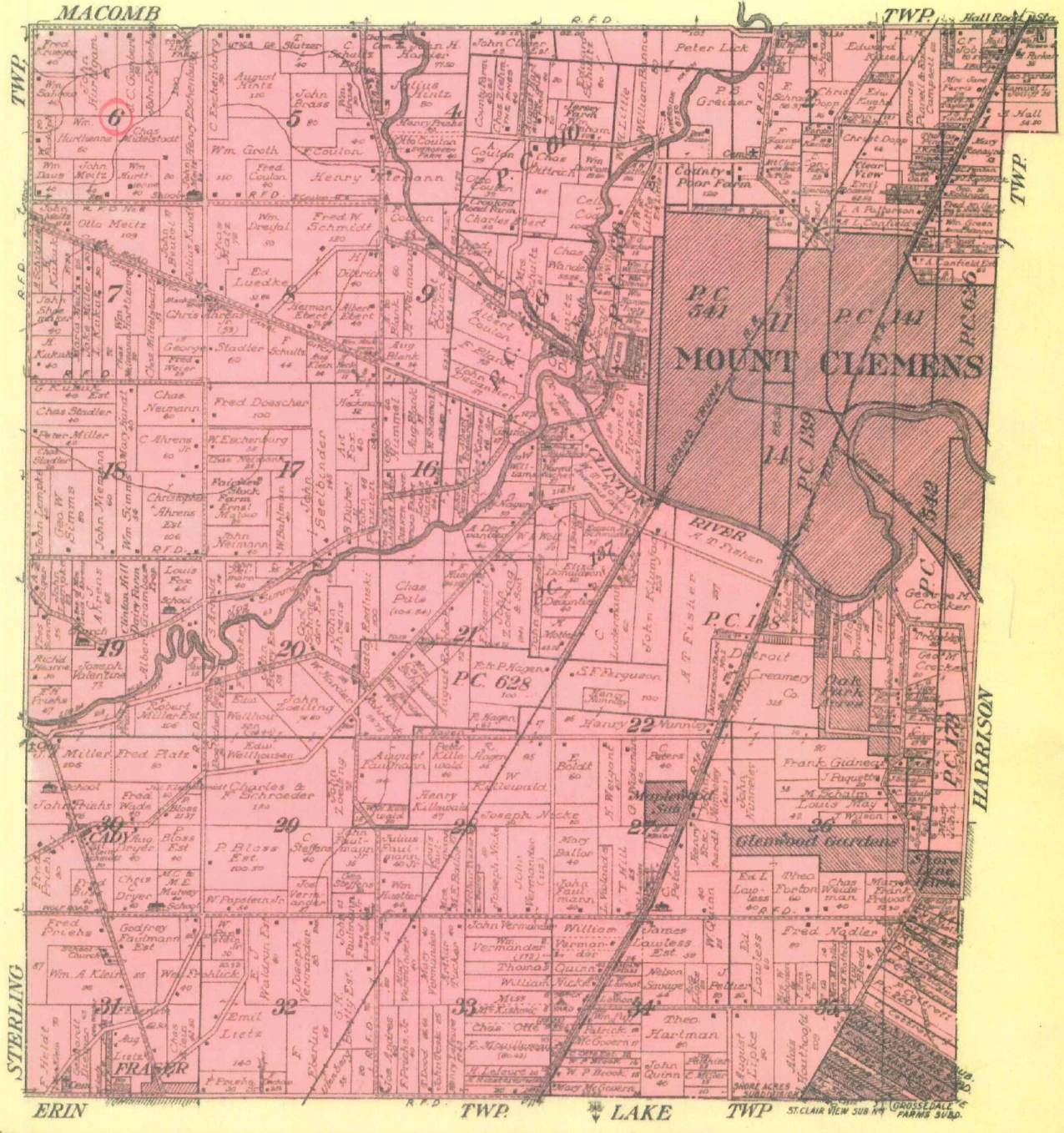

1916

5









Date of Photography: Spring 2012  
 100 50 0 100 200 Feet

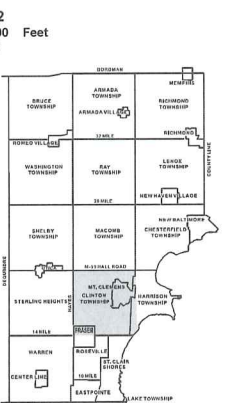

CLINTON TWP SHEET INDEX

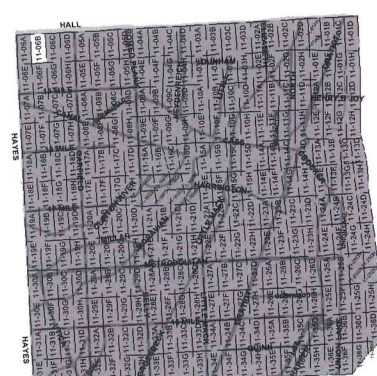

DESCRIPTION OF PERMANENT REAL ESTATE INDEX NUMBER  
**13-19-302-018**

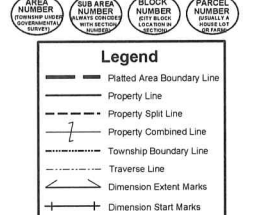

**11-06B**

CLINTON TWP.  
 E. 1/2 N.W. 1/4 SEC. 6 T. 2N. R. 13E.

Source: Macomb County Department of Planning and Economic Development  
 - 2008 Digital Orthophotography Project  
 - Parcel Conversion Project

Note: Digital Orthophotography horizontal positioning accuracy is 3 feet. Parcel boundary lines should be considered a graphical representation and not in any way a legal survey or engineering document. In general, the horizontal positioning and length accuracy is within 15 feet.

This map is intended for general planning purposes. Site specific evaluation should be verified by field inspection. This is a work in progress and may contain errors and omissions. Please report any potential revisions to (586)469-5285.



GIS **MACOMB COUNTY**  
 Planning and Economic  
 Development Department

Published: Jun 06 2013





Date of Photography: Spring 2012  
 100 50 0 100 200 Feet  
 1:1,200

CLINTON TWP SHEET INDEX

DESCRIPTION OF PERMANENT REAL ESTATE INDEX NUMBER  
**13-19-302-018**

**11-06C**

CLINTON TWP.  
 W.1/2 N.E. 1/4 SEC. 6 T.2N. R.13E.

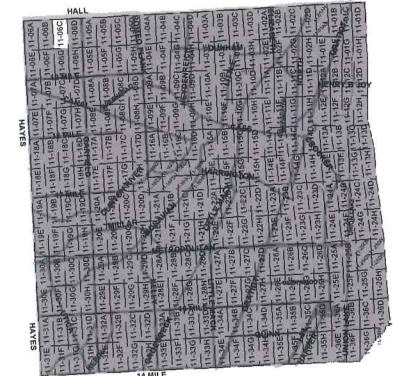
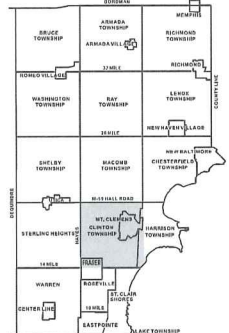

**Legend**

- Platted Area Boundary Line
- Property Line
- Property Split Line
- Property Combined Line
- Township Boundary Line
- Traverse Line
- Dimension Extent Marks
- Dimension Start Marks

Source: Macomb County Department of Planning and Economic Development  
 - 2008 Digital Orthophotography Project  
 - Parcel Conversion Project

Note:  
 Digital Orthophotography horizontal positioning accuracy is 3 feet. Parcel boundary lines should be considered a graphical representation and not in any way a legal survey or engineering document. In general, the horizontal positioning and length accuracy is within 15 feet.

This map is intended for general planning purposes. Site specific evaluation should be verified by field inspection. This is a work in progress and may contain errors and omissions. Please report any potential revisions to (586)469-5265.





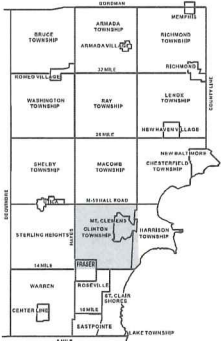

HALL	SEAVY
11-06-001 11-06-002 11-06-003 11-06-004 11-06-005 11-06-006 11-06-007 11-06-008 11-06-009 11-06-010 11-06-011 11-06-012 11-06-013 11-06-014 11-06-015 11-06-016 11-06-017 11-06-018 11-06-019 11-06-020 11-06-021 11-06-022 11-06-023 11-06-024 11-06-025 11-06-026 11-06-027 11-06-028 11-06-029 11-06-030 11-06-031 11-06-032 11-06-033 11-06-034 11-06-035 11-06-036 11-06-037 11-06-038 11-06-039 11-06-040 11-06-041 11-06-042 11-06-043 11-06-044 11-06-045 11-06-046 11-06-047 11-06-048 11-06-049 11-06-050 11-06-051 11-06-052 11-06-053 11-06-054 11-06-055 11-06-056 11-06-057 11-06-058 11-06-059 11-06-060 11-06-061 11-06-062 11-06-063 11-06-064 11-06-065 11-06-066 11-06-067 11-06-068 11-06-069 11-06-070 11-06-071 11-06-072 11-06-073 11-06-074 11-06-075 11-06-076 11-06-077 11-06-078 11-06-079 11-06-080 11-06-081 11-06-082 11-06-083 11-06-084 11-06-085 11-06-086 11-06-087 11-06-088 11-06-089 11-06-090 11-06-091 11-06-092 11-06-093 11-06-094 11-06-095 11-06-096 11-06-097 11-06-098 11-06-099 11-06-100 11-06-101 11-06-102 11-06-103 11-06-104 11-06-105 11-06-106 11-06-107 11-06-108 11-06-109 11-06-110 11-06-111 11-06-112 11-06-113 11-06-114 11-06-115 11-06-116 11-06-117 11-06-118 11-06-119 11-06-120 11-06-121 11-06-122 11-06-123 11-06-124 11-06-125 11-06-126 11-06-127 11-06-128 11-06-129 11-06-130 11-06-131 11-06-132 11-06-133 11-06-134 11-06-135 11-06-136 11-06-137 11-06-138 11-06-139 11-06-140 11-06-141 11-06-142 11-06-143 11-06-144 11-06-145 11-06-146 11-06-147 11-06-148 11-06-149 11-06-150 11-06-151 11-06-152 11-06-153 11-06-154 11-06-155 11-06-156 11-06-157 11-06-158 11-06-159 11-06-160 11-06-161 11-06-162 11-06-163 11-06-164 11-06-165 11-06-166 11-06-167 11-06-168 11-06-169 11-06-170 11-06-171 11-06-172 11-06-173 11-06-174 11-06-175 11-06-176 11-06-177 11-06-178 11-06-179 11-06-180 11-06-181 11-06-182 11-06-183 11-06-184 11-06-185 11-06-186 11-06-187 11-06-188 11-06-189 11-06-190 11-06-191 11-06-192 11-06-193 11-06-194 11-06-195 11-06-196 11-06-197 11-06-198 11-06-199 11-06-200	11-06-201 11-06-202 11-06-203 11-06-204 11-06-205 11-06-206 11-06-207 11-06-208 11-06-209 11-06-210 11-06-211 11-06-212 11-06-213 11-06-214 11-06-215 11-06-216 11-06-217 11-06-218 11-06-219 11-06-220 11-06-221 11-06-222 11-06-223 11-06-224 11-06-225 11-06-226 11-06-227 11-06-228 11-06-229 11-06-230 11-06-231 11-06-232 11-06-233 11-06-234 11-06-235 11-06-236 11-06-237 11-06-238 11-06-239 11-06-240 11-06-241 11-06-242 11-06-243 11-06-244 11-06-245 11-06-246 11-06-247 11-06-248 11-06-249 11-06-250 11-06-251 11-06-252 11-06-253 11-06-254 11-06-255 11-06-256 11-06-257 11-06-258 11-06-259 11-06-260 11-06-261 11-06-262 11-06-263 11-06-264 11-06-265 11-06-266 11-06-267 11-06-268 11-06-269 11-06-270 11-06-271 11-06-272 11-06-273 11-06-274 11-06-275 11-06-276 11-06-277 11-06-278 11-06-279 11-06-280 11-06-281 11-06-282 11-06-283 11-06-284 11-06-285 11-06-286 11-06-287 11-06-288 11-06-289 11-06-290 11-06-291 11-06-292 11-06-293 11-06-294 11-06-295 11-06-296 11-06-297 11-06-298 11-06-299 11-06-300

DESCRIPTION OF PERMANENT REAL ESTATE INDEX NUMBER  
**13-19-302-018**



**11-06F**

CLINTON TWP.  
 E.1/2 S.W.1/4 SEC.6 T.2N. R.13E.

Source: Macomb County Department of Planning and Economic Development  
 - 2008 Digital Orthophotography Project  
 - Parcel Conversion Project

Note: Digital Orthophotography horizontal positioning accuracy is 3 feet. Parcel boundary lines should be considered a graphical representation and not in any way a legal survey or engineering document. In general, the horizontal positioning and length accuracy is within 15 feet.  
 This map is intended for general planning purposes. Site specific evaluation should be verified by field inspection. This is a work in progress and may contain errors and omissions. Please report any potential revisions to (566)469-5285.





BRADFORD DR

327 COMMONS CONDOMINIUM

378

377

PROFESSIONAL OFFICE BUILDING

400

451

HEALTHIER WAY

DALCOGA DR

COMMONS DR

19 MILE RD

CLINTON TWP

Date of Photography: Spring 2012  
100 50 0 100 200 Feet

1:1,200

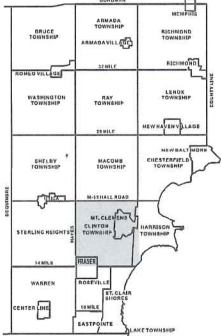

CLINTON TWP SHEET INDEX

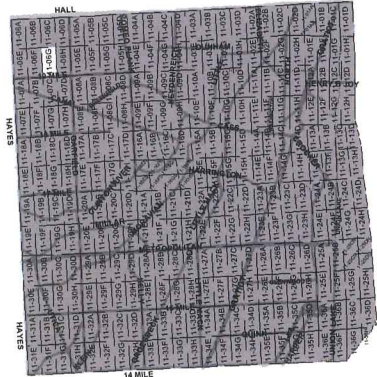

DESCRIPTION OF PERMANENT REAL ESTATE INDEX NUMBER  
**13-19-302-018**

**Legend**

- Platted Area Boundary Line
- Property Line
- Property Split Line
- Property Combined Line
- Township Boundary Line
- Traverse Line
- Dimension Extent Marks
- Dimension Start Marks

**11-06G**

CLINTON TWP.

W.1/2 S.E.1/4 SEC.6 T.2N. R.13E.

Source: Macomb County Department of Planning and Economic Development  
- 2008 Digital Orthophotography Project  
- Parcel Conversion Project

Note: Digital Orthophotography horizontal positioning accuracy is 3 feet. Parcel boundary lines should be considered a graphical representation and not in any way a legal survey or engineering document. In general, the horizontal positioning and length accuracy is within 15 feet.

This map is intended for general planning purposes. Site specific evaluation should be verified by field inspection. This is a work in progress and may contain errors and omissions. Please report any potential revisions to (566)469-5285.



GIS MACOMB COUNTY Planning and Economic Development

Published: Jun 06 2013



**LAND CORNER RECORDATION CERTIFICATE**  
 FILING REQUIREMENT OF ACT 74, MICH. P.A.1970

FOR CORNERS OF-- Section 6 LOCATED IN-- Clinton Twp. CORNER CODE NUMBER

1. PUBLIC LAND SURVEY T. 2 N. R. 13 E. B-2

2. PROPERTY CONTROLLING IN SECTION T. N. S. R. E. W.

3. MISCELLANEOUS PROPERTY IN SECTION T. N. S. R. E. W.

4. LOT NO. \_\_\_\_\_, RECORDED PLAT \_\_\_\_\_

5. PRIVATE CLAIMS \_\_\_\_\_

LIBER 3310 PAGE 115  
 A691956  
 RECORDED IN MACOMB COUNTY  
 RECORDS AT: 10:08 A.M.  
 FEB 17 1981

*Edna Hill*  
 CLERK-REGISTER OF DEEDS  
 MACOMB COUNTY, MICHIGAN  
 REGISTER OF DEEDS STAMP AND  
 FILING NUMBER

I, Herbert G. Avey, do hereby certify that under requirements of P.A. 74, Michigan P.A. of 1970, the corner points mentioned in lines 1 and 2 above were, in a field survey on November 26, 1980, established, re-established, monumented, re-monumented, recovered or restored as expressed below and in conformance with regulations and rules therefore as required in the current manual of survey instructions of the United States Department of the Interior, Bureau of Land Management or by a decree of a court of law. Furthermore, that the corner points mentioned in lines 3, 4 and 5 above were, in a field survey on \_\_\_\_\_, 19\_\_\_\_, found, recovered, restored, established or re-established as expressed below and in conformance with the rules of the Michigan State Board of Registration for Land Surveyors or, by a Decree of a Court of law:

A. Description of original monument and accessories and/or subsequent restoration:

330.00' west to  $\frac{1}{2}$ " bar on E-W  $\frac{1}{4}$  line.  
 2659.88' south to south  $\frac{1}{4}$  corner of Section 6.

B. Description of corner evidence found and/or method applied in restoring or re-establishing corner:

Found corner destroyed by construction. Replaced corner by use of above witnesses which were found in good condition.

C. Description of monument for corner and accessories established to perpetuate locating the position of the corner:

Set  $\frac{1}{2}$ " bar with cap #15396  
 73.24' north to P.K. nail in west face 4" wild cherry.  
 66.95' west to form nail in washer, north face triple 6" maple.  
 120.47' S.E. to vertical P.K. nail in westerly root 30" maple  
 2659.88' south to  $\frac{1}{2}$ " bar in monument box centerline 19 Mile Road - south  $\frac{1}{4}$  CORNER  
 330.00' west to  $\frac{1}{2}$ " bar cap #17635.



SIGNED BY Herbert G. Avey DATE December 4, 1980

SURVEYOR'S MICHIGAN REGISTRATION NO. #15396 (SEAL)

FOR STATE AND UNITED STATES AGENCIES:

SIGNED BY \_\_\_\_\_ DATE \_\_\_\_\_

APPROVED AND SIGNED BY \_\_\_\_\_ DATE \_\_\_\_\_ (SEAL)

SURVEYOR'S MICHIGAN REGISTRATION NO. \_\_\_\_\_

3'

1

2



188:06325PC317

0065826

LAND CORNER RECORDATION CERTIFICATE 94 MAY 11 AM 10:58  
Filing Requirement of Act 74, Mich. P.A. 1970

For corners in  
HACOMB  
(County)

Located in: CLINTON TOWNSHIP Corner Code: B-2

CAP. ... LAUGH  
REG. ... DEEDS  
MAY ... CITY, MI

- 1. Public Land Survey T 2N R 13E B-2
- 2. Property Controlling in Section S T R
- 3. Miscellaneous Property in Sec. S T R
- 4. Lot No. Recorded Plat
- 5. Private Claims

Register of Deeds Stamp & File Number

	A	B	C	D	E	F	G	H	I	J	K	L	M
2													
3													
4													
5													
6													
7													
8													
9													
10													
11													
12													
13													

I, Shelby W. Money, in a field survey on March 24, 1994, do hereby certify that under requirements of P.A. 74, Michigan P.A. of 1970, the corner points mentioned in lines 1 and 2 above were in conformance with regulations and rules therefore as required in the current manual of survey instructions of the United States Department of the Interior, Bureau of Land Management or by a decree of a Court of Law and/or that the corner points mentioned in lines 3, 4 and 5 above were in conformance with the rules of the Michigan Board of Land Surveyors or by a Decree of a Court of Law, established, re-established, monumented, re-monumented, recovered, found as expressed below:

NOTE: Not more than 4 corners, all in the same town and range, may be recorded on this certificate.

A. Description of original monument and accessories and/or subsequent restoration:

B-2 G.L.O. (1818) PRESTON NO WITNESSES FOUND  
LCRC (1981) LIBER 3310 PAGE 115. HERBERT G. AVEY, P.S. #15396 SET 1/2" BAR W/CAP #15396

B. Description of corner evidence found and/or method applied in restoring or reestablishing corner:

B-2 FOUND 3/4" PIPE  
LIBER 3310 PAGE 115  
NORTH 73.24' FOUND, PK'NAIL IN THE WEST FACE OF A 6" WILD CHERRY  
WEST 66.95' FOUND, FORM NAIL IN THE NORTH FACE OF A TRIPLE 6" MAPLE

C. Description of monument for corner and accessories established to perpetuate locating the position of the corner:

B-2 FOUND 3/4" PIPE  
THE CENTER POST, SECTION 6, T.2N., R.13E.  
AZ 00° 15.80' FOUND, THE CENTERLINE OF GAS LINE MARKER  
AZ 00° 73.24' SET, PK'NAIL W/TAG #30092 ABOVE SCAR FOUND IN THE WEST FACE OF A 6" CHERRY  
AZ 55° 78.14' SET, PK'NAIL W/TAG #30092 IN THE NORTHWEST FACE OF AN 8" ELM ON THE WEST BANK OF DRAIN  
AZ 275° 66.95' FOUND, FORM NAIL IN THE NORTH FACE OF A TRIPLE 8" MAPLE  
AZ 310° 81.75' FOUND, THE CENTERLINE OF A HYDRANT

Signed by Shelby W. Money  
Surveyor's Michigan License No. 30092

Date 5/11/94



FORM APPROVED BY MICHIGAN BOARD OF LAND SURVEYORS, MAY 14, 1975  
REVISED JAN., 1983

2